



# Anchor Court

London Street Basingstoke RG21 7NY

## Description

This furnished studio apartment is conveniently located within the 'Top of Town' with parking included.

It is a relatively large studio offering an open plan accommodation, fitted kitchen, living/dining room plus a bedroom area which could be screened off for additional privacy.

Anchor Court is a small converted building with a mix of studio's, one and two bedroom apartments walking distance to the train station and festival place.



**Winkworth**

## Accommodation

Studio apartment  
Open plan living/dining/kitchen  
area  
Shower room  
One parking space  
Furnished

All details are given in good faith and are believed to be correct at time of printing. Winkworth give no representation as to their accuracy and potential purchasers or tenants must satisfy themselves by inspection or otherwise as to their correctness. No employee of Winkworth has authority to make or give any representation or warranty in relation to this property.

Energy Efficiency Rating		
	Current	Potential
Very energy efficient - lower running costs		
(92+) <b>A</b>		
(81-91) <b>B</b>		
(69-80) <b>C</b>		
(55-68) <b>D</b>		
(39-54) <b>E</b>		
(21-38) <b>F</b>		
(1-20) <b>G</b>		
Not energy efficient - higher running costs		
	69	83
England, Scotland & Wales	EU Directive 2002/91/EC	

FIRST FLOOR  
399 sq.ft. (37.1 sq.m.) approx.

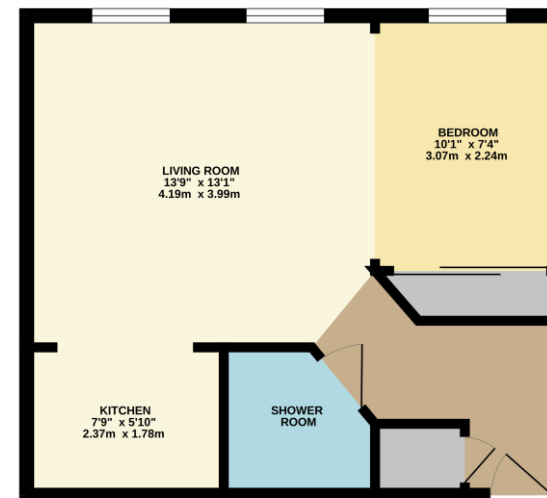

TOTAL FLOOR AREA: 399 sq.ft. (37.1 sq.m.) approx.  
Whilst every attempt has been made to ensure the accuracy of the figures contained here, measurements of floors, windows, rooms and any other items are approximate and no responsibility is taken for any errors, omissions or misstatements. This plan is for illustrative purposes only and should not be used as a basis for any prospective purchase. The dimensions, layout and appearance shown here are for information only and no guarantee as to their operability or efficiency can be given.  
Made with Hergo 12/22



## Basingstoke Office

10B Church Street, Basingstoke, Hampshire, RG21 7QE  
01256 811730 | basingstoke@winkworth.co.uk

[winkworth.co.uk/Basingstoke](https://www.winkworth.co.uk/Basingstoke)

# Winkworth

See things differently.