



VERTO, READING, BERKSHIRE, RG1 3FR
£1,400 PER MONTH FURNISHED

**MODERN ONE BEDROOM SIXTH FLOOR
RIVERSIDE APARTMENT. AVAILABLE 28TH
JUNE.**

Reading | 0118 4022 300 | reading@winkworth.co.uk

Winkworth

for every step...

winkworth.co.uk



DESCRIPTION:

Modern one bedroom second floor Town Centre apartment overlooking the Kennet and Avon. Located on the southern side of this popular development with a balcony overlooking the river this contemporary apartment is finished to a high specification throughout. Living accommodation comprises; an open plan living space with high spec. fitted kitchen and patio doors opening onto the balcony, there is a double bedroom with fitted wardrobes and contemporary bathroom suite. The development further benefits from lift access, communal gym and communal roof garden Available 28th June 2025. Furnished.

AT A GLANCE

- One Bedroom Apartment
- Second Floor
- Overlooking Kennet and Avon Canal
- Communal Gym and Roof Garden
- Council Tax Band C
- No Parking
- Furnished
- Available 28th June





Winkworth

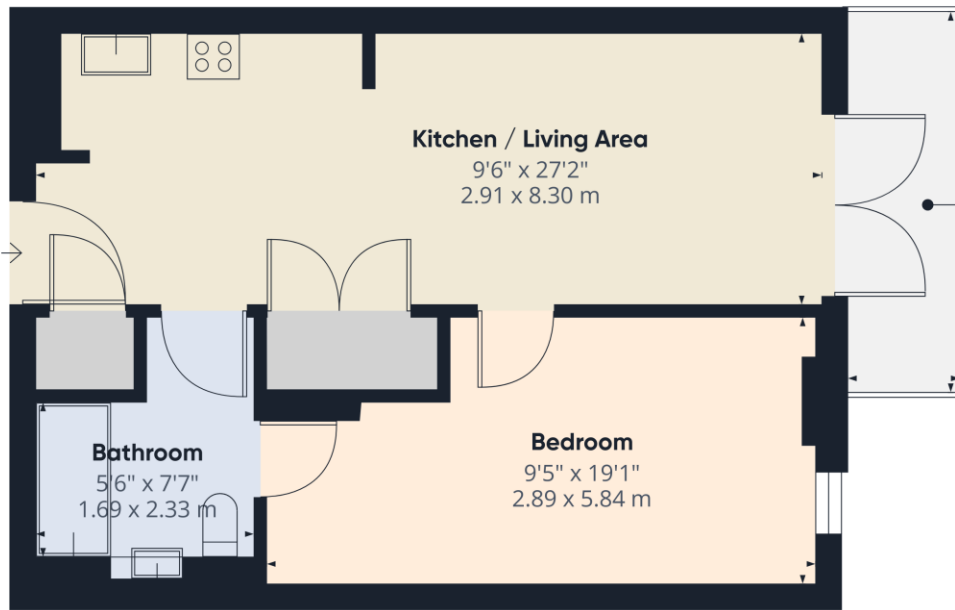

Balcony
13'3" x 3'11"
4.05 x 1.21 m

Approximate total area⁽¹⁾

500 ft²
46.5 m²

Balconies and terraces

53 ft²
4.9 m²

(1) Excluding balconies and terraces

Calculations reference the RICS IPMS 3C standard. Measurements are approximate and not to scale. This floor plan is intended for illustration only.

GIRAFFE 360

This floorplan is for illustration purposes only and is not to scale. The position and size of doors, windows, appliances and other features are approximate.

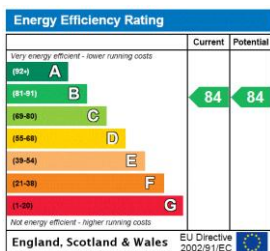

Deposit: £1,615.38

Holding Deposit: £323.07

Council Tax Band: C

Where no figures are shown, we have been unable to ascertain the information. All figures that are shown were correct at the time of printing.

Winkworth

Reading | 0118 4022 300 | reading@winkworth.co.uk

for every step...

winkworth.co.uk

Winkworth wishes to inform prospective buyers and tenants that these particulars are a guide and act as information only. All our details are given in good faith and believed to be correct at the time of printing but they don't form part of an offer or contract. No Winkworth employee has authority to make or give any representation or warranty in relation to this property. All fixtures and fittings, whether fitted or not are deemed removable by the vendor unless stated otherwise and room sizes are measured between internal wall surfaces, including furnishings.