



LONG LANE, FINCHLEY, LONDON, N3
£500,000 LEASEHOLD

A WELL PRESENTED TWO BEDROOM GROUND FLOOR GARDEN FLAT

Finchley | 020 8349 3388 | finchley@winkworth.co.uk



DESCRIPTION:

We are pleased to offer this beautifully presented ground floor period style conversion flat, ideally located for Victoria Park, Good Ofsted Rated Schools and all the transport and shopping facilities on Ballards Lane. The property has been modernised to a good standard and comprises spacious reception room, modern fitted kitchen and bathroom, two bedrooms, private rear garden, off street parking and potential to extend (stpp) & consents. An internal viewing is highly recommended!

TENURE:

Leasehold : 156 years 5 months
Ground Rent : £30.00 per annum

COUNCIL TAX:

Band D

AT A GLANCE

- Set in a period building
- Ground floor
- Modern kitchen & bathroom
- Spacious reception room
- Two bedrooms
- Private garden
- Off street parking
- Potential to extend (stpp)





Long Lane, N3

Approx. Gross Internal Floor Area 765 sq. ft / 71.10 sq. m

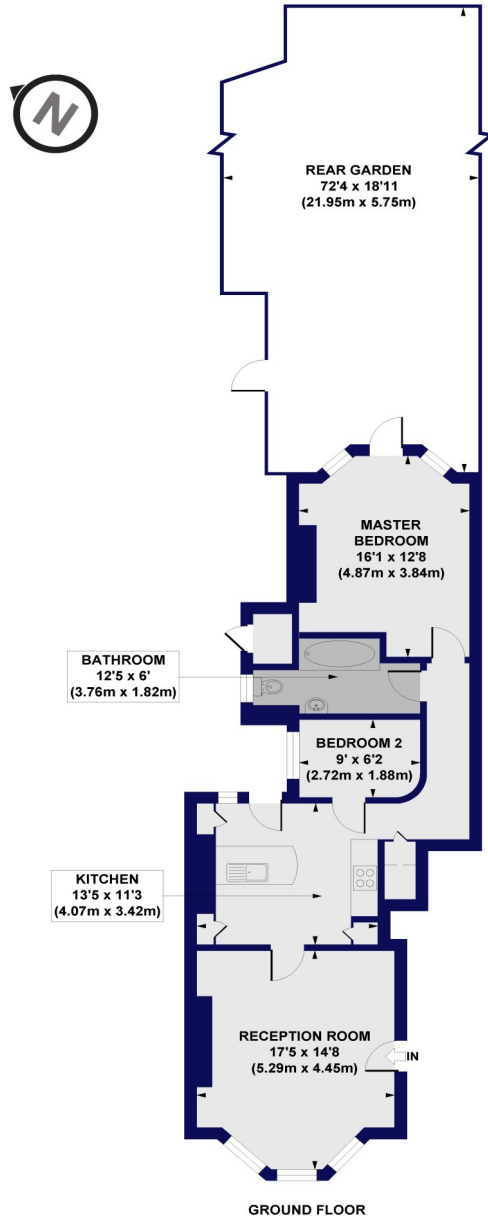

All measurements of walls, doors, windows, fittings and appliances, including their size and location, are shown as standard sizes and do not constitute any warranty or representation by the seller, their agent or CP Creative. Any intending purchaser must satisfy himself by inspection or otherwise as to the correctness of the information contained in these plans. This plan is for illustrative purposes only and should be used as such by any prospective purchasers.

Winkworth

