



RUDLAND CLOSE, BERKSHIRE, RG19 3XW
£1,200 PER MONTH UNFURNISHED

**TWO BEDROOM TERRACE HOUSE CLOSE TO
THATCHAM TOWN CENTRE. AVAILABLE 5TH
AUGUST.**

Reading | 0118 4022 300 | reading@winkworth.co.uk

Winkworth

for every step...

winkworth.co.uk



DESCRIPTION:

Two bedroom terrace house located within the Moors Development offering good access to Thatcham town centre and train station. Accommodation comprises modern kitchen, reception room, two bedrooms and a three piece bathroom. Further benefits include residents off road parking and private rear garden. Available 5th August 2025. Unfurnished.

AT A GLANCE

- Two bedroom terrace house
- Residents parking
- Private rear garden
- Council tax band C
- Available 5th August
- Unfurnished

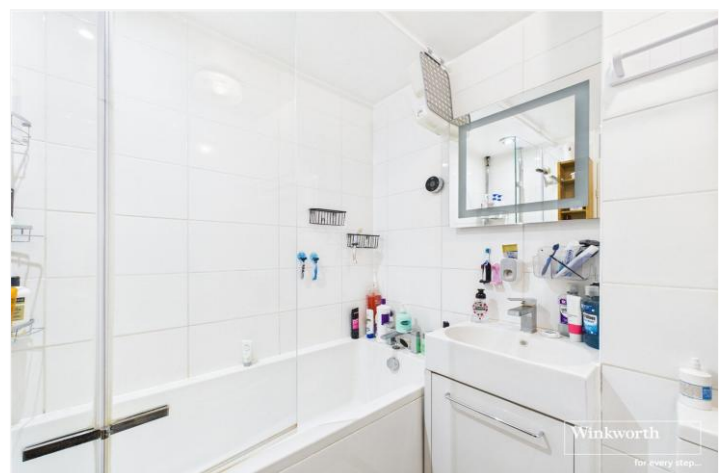

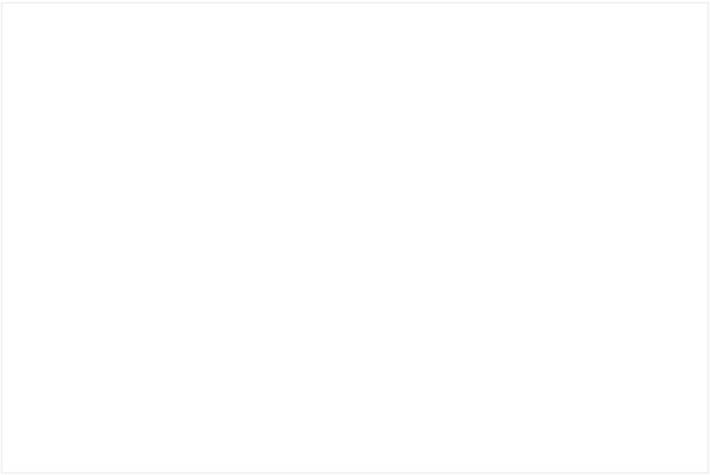

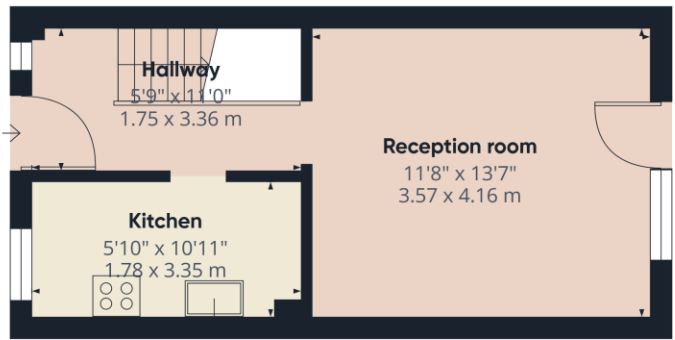

Ground Floor

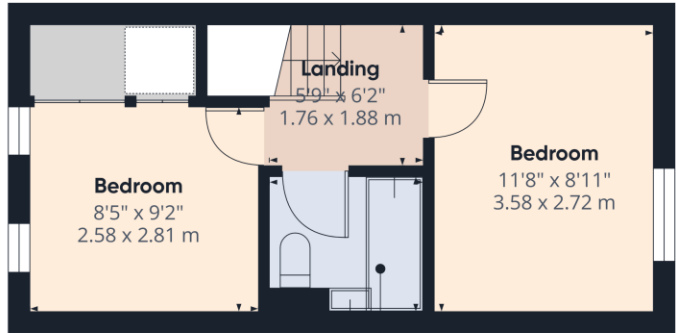

Floor 1

Approximate total area⁽¹⁾
541 ft²
50.2 m²

(1) Excluding balconies and terraces

Calculations reference the RICS IPMS 3C standard. Measurements are approximate and not to scale. This floor plan is intended for illustration only.

GIRAFFE 360

This floorplan is for illustration purposes only and is not to scale. The position and size of doors, windows, appliances and other features are approximate.

Score	Energy rating	Current	Potential
92+	A		92 A
81-91	B		
69-80	C	74 C	
55-68	D		
39-54	E		
21-38	F		
1-20	G		

Deposit: £1,384.62

Holding Deposit: £276.92

Council Tax Band: C

Where no figures are shown, we have been unable to ascertain the information. All figures that are shown were correct at the time of printing.