



Golders Green Road, NW11

£350,000 *LEASEHOLD*



1



1



1

**A SPACIOUS GROUND FLOOR APARTMENT IN THIS CENTRALLY LOCATED POPULAR BLOCK**

LEASEHOLD 130 Yrs Remaining/ Service Charge: TBC/  
Ground Rent: Nil/ EPC Rating: C/ Council Tax Band: D

## Description

Located in Golders Green Road, close to the junction with Princes Park Avenue and Highfield Gardens, is this spacious ground floor 1 bedroom apartment. The flat has a spacious double bedroom, separate fitted kitchen and a large 'L' shaped living room with a balcony overlooking Highfield Road.

The flat has independent Central Heating, communal parking (on a 1<sup>st</sup> come, 1<sup>st</sup> serve basis) and is in good order throughout. It is being sold Chain free.

Viewing is highly recommended.

### Melvin Hall, Golders Green Road, London NW11 9QB

Ground Floor  
GROSS INTERNAL FLOOR AREA  
APPROX. 61.51 SQ M / 662 SQ FT

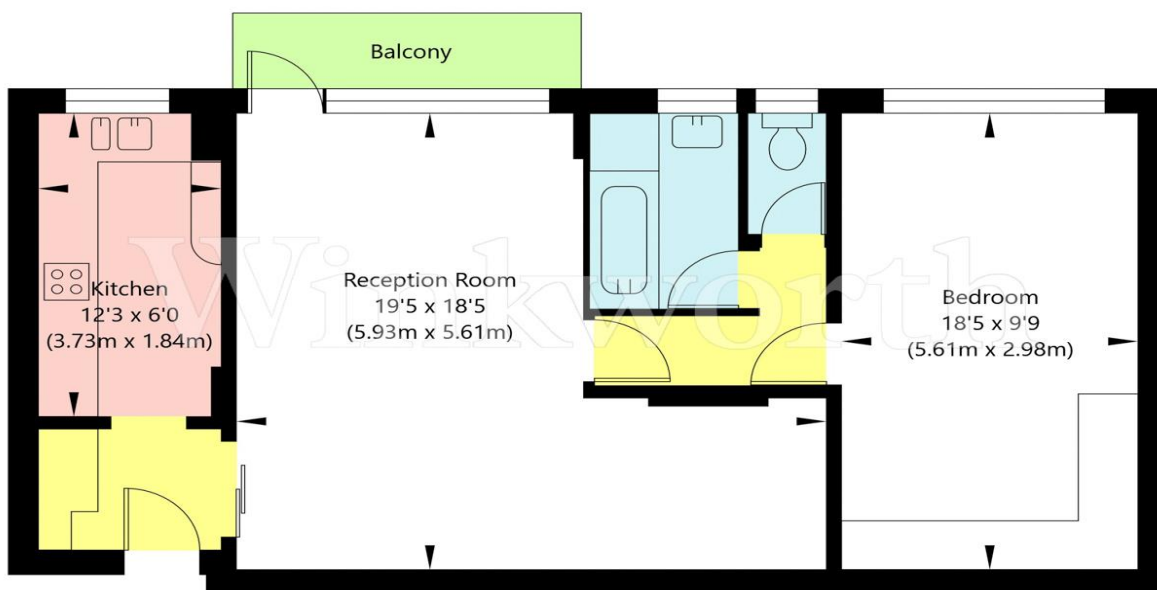

APPROXIMATE GROSS INTERNAL FLOOR AREA 61.51 SQ M / 662 SQ FT  
THIS FLOOR PLAN IS FOR ILLUSTRATIVE PURPOSES ONLY AND  
SHOULD BE USED FOR THIS PURPOSE BY PROSPECTIVE APPLICANTS AS ITS NOT TO SCALE.

(c) AMBERSHORE PIX LIMITED / PHOTO - VIDEO - FLOOR PLANS / 0800 999 1577 / WWW.AMERSHOREPIX.CO.UK