



FINSBURY PARK ROAD, FINSBURY PARK, N4
£400 PER WEEK

WINKWORTH ARE PLEASED TO OFFER THIS UPPER FLOOR TWO BEDROOM FLAT SET CLOSE TO FINSBURY PARK

Islington | 0207 354 2480 | islington@winkworth.co.uk

Winkworth

Tenant Fees Apply: Details of fees for tenant referencing, tenancy agreement admin fees and renewal fees are available on the Winkworth website and the link can be found with the displayed rent for the property. Tenants should ensure they are fully conversant with these upfront fees and other costs that are involved at the outset of the tenancy before making an offer to rent and your local Winkworth office will provide written details upon request.

winkworth.co.uk

See things differently



DESCRIPTION:

Winkworth are pleased to offer this upper floor two bedroom flat set close to Finsbury Park. Standing at over 650 square feet, the property comprises of a large open plan kitchen/reception room, two evenly sized double bedrooms and modern bathroom. Situated within walking distance of Finsbury Park station, this no through road benefits from its proximity to Clissold Park as well as the pubs, boutiques and restaurants on Highbury Barn and Blackstock Road.

Winkworth



Winkworth

Finsbury Park Road, N4

Approx. Gross Internal Floor Area 687 sq. ft / 63.89 sq. m (Including Restricted Height Area)

Approx. Gross Internal Floor Area 640 sq. ft / 59.52 sq. m (Excluding Restricted Height Area)

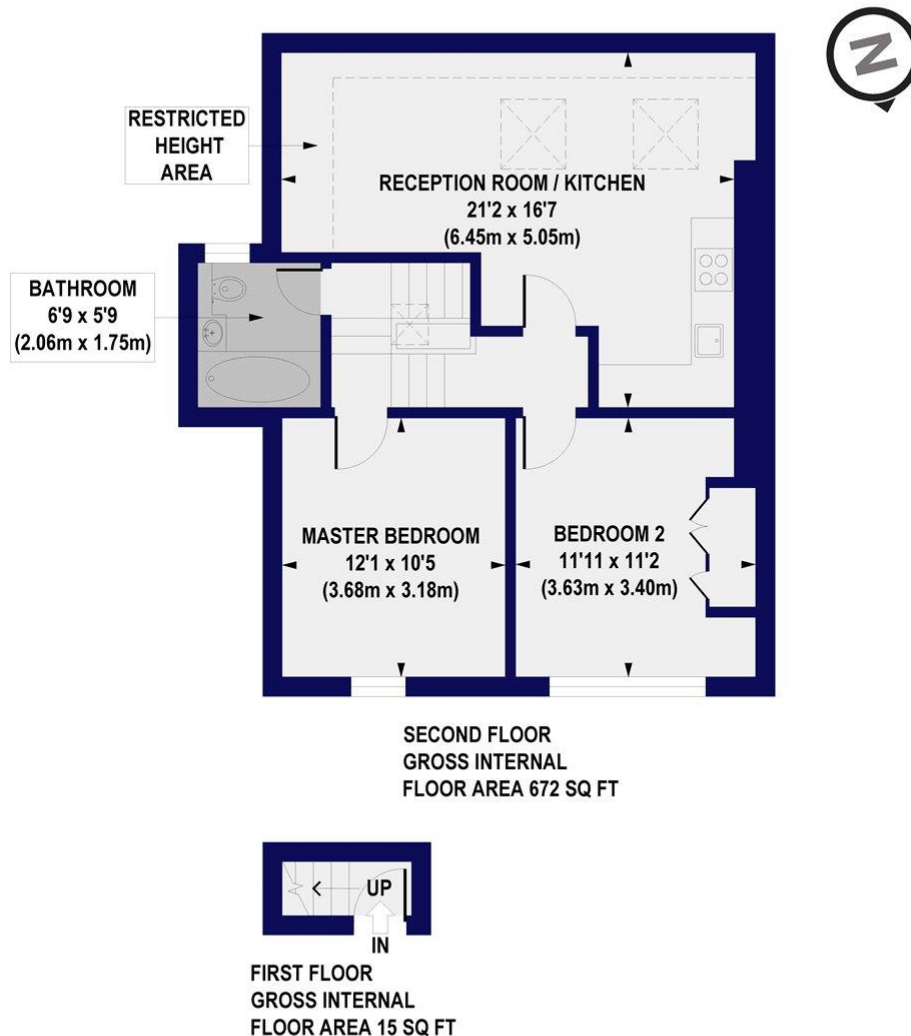

All measurements of walls, doors, windows, fittings and appliances, including their size and location, are shown as standard sizes and do not constitute any warranty or representation by the seller, their agent or CP Creative. Any intending purchaser must satisfy himself by inspection or otherwise as to the correctness of the information contained in these plans. This plan is for illustrative purposes only and should be used as such by any prospective purchasers.

Winkworth

This floorplan is for illustration purposes only and is not to scale. The position and size of doors, windows, appliances and other features are approximate.

Islington | 0207 354 2480 | islington@winkworth.co.uk

Winkworth

winkworth.co.uk

See things differently

Winkworth wishes to inform prospective buyers and tenants that these particulars are a guide and act as information only. All our details are given in good faith and believed to be correct at the time of printing but they don't form part of an offer or contract. No Winkworth employee has authority to make or give any representation or warranty in relation to this property. All fixtures and fittings, whether fitted or not are deemed removable by the vendor unless stated otherwise and room sizes are measured between internal wall surfaces, including furnishings.