



‘Warriston’ Moorside Road
West Moors, Ferndown, BH22 0EH
Offers Over £800,000

Winkworth



**OFFERS OVER £800,000
FREEHOLD**

‘Warriston’ is a rarely available Edwardian five double bedroom, three reception room, three bathroom detached house positioned on a secluded plot in one of the area’s most sought after residential roads.

With over 2500sq ft of versatile accommodation this lovely, character filled family home further benefits from a gated driveway, oversized garage and secluded garden with home office and decked terrace.

Immaculate Throughout
Three Reception Rooms
Very Sought After Location
Five Double Bedrooms
Detached Edwardian House
Kitchen/Diner/Family Room
Bedroom With Walk In Wardrobe & En-suite Shower Room
Secluded Garden With Home Office
Detached Oversized Garage
Driveway

EPC D | Council Tax Band F

01202 434365
ferndown@winkworth.co.uk





Moorside road

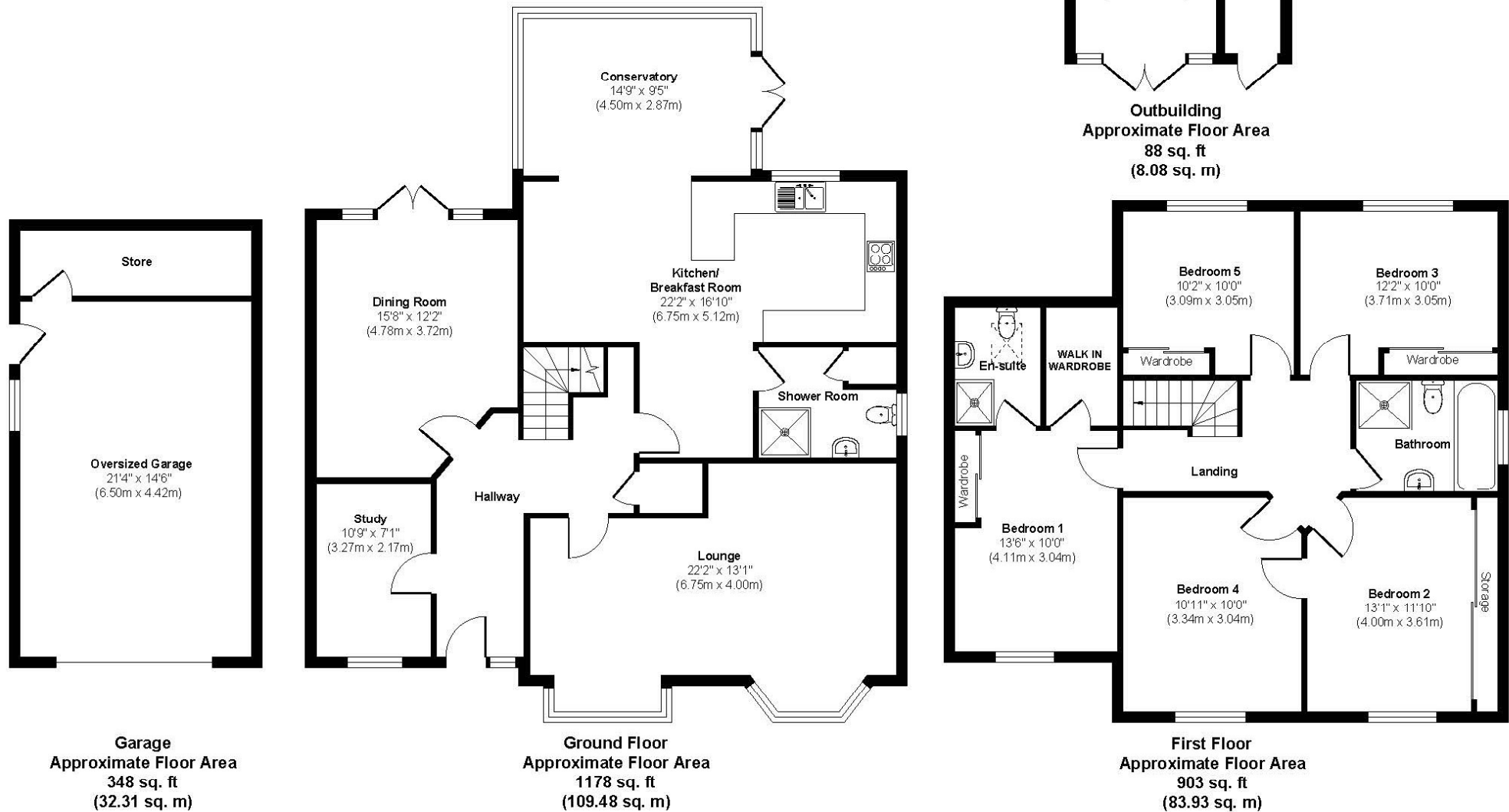

Approx. Gross Internal Floor Area 2517 sq. ft / 233.80 sq. m
Illustration for identification purposes only, measurements approximate and not to scale.



LOCATION

A short walk from of a range of amenities and leisure facilities in the popular village of West Moors, within catchment for excellent schools and close to bus routes which give you easy access to Bournemouth, Poole & Wimborne all of which have an excellent range of shops, bars and restaurants. The property is also conveniently located within walking distance of West Moors plantation with its lovely walks and cycle paths, as well as the Castleman Trailway. The A31 provides quick access to the New Forest, Southampton, London and beyond for the commuter by car and award winning beaches are just twenty minutes away.

Winkworth Ferndown

406 Ringwood Road, Ferndown, Dorset, BH22 9AU

01202 434365 | ferndown@winkworth.co.uk

winkworth.co.uk/ferndown

Winkworth