



LAKESIDE COURT, BOREHAMWOOD, HERTFORDSHIRE, WD6
£475,000 SHARE OF FREEHOLD

AN EXCLUSIVE THREE BEDROOM, TWO BATHROOM FIRST FLOOR APARTMENT

Borehamwood | 020 8953 8899 | borehamwood@winkworth.co.uk



Winkworth

DESCRIPTION:

Situated in a highly desirable location and rarely available is this three bedroom, two bathroom first floor apartment with Westerly facing views over a large private lake.

Still in occupation by the original vendors, the property provides in excess of 1000 square feet of well-proportioned, bright and spacious accommodation, which has been meticulously maintained throughout.

Located in a quiet turning just off Deacons Hill Road the property has extensive and immaculately maintained communal gardens which border the private lake and a garage en bloc

AT A GLANCE

- 3 Bedrooms
- Two Bathroom
- Westerly Facing Double Reception and Kitchen
- 1060 Square Feet
- Overlooking Private Lake
- Share Of Freehold
- Garage En Bloc



Winkworth



Winkworth



Winkworth



Winkworth

Approximate Gross Internal Area = 98.5 sq m / 1060 sq ft

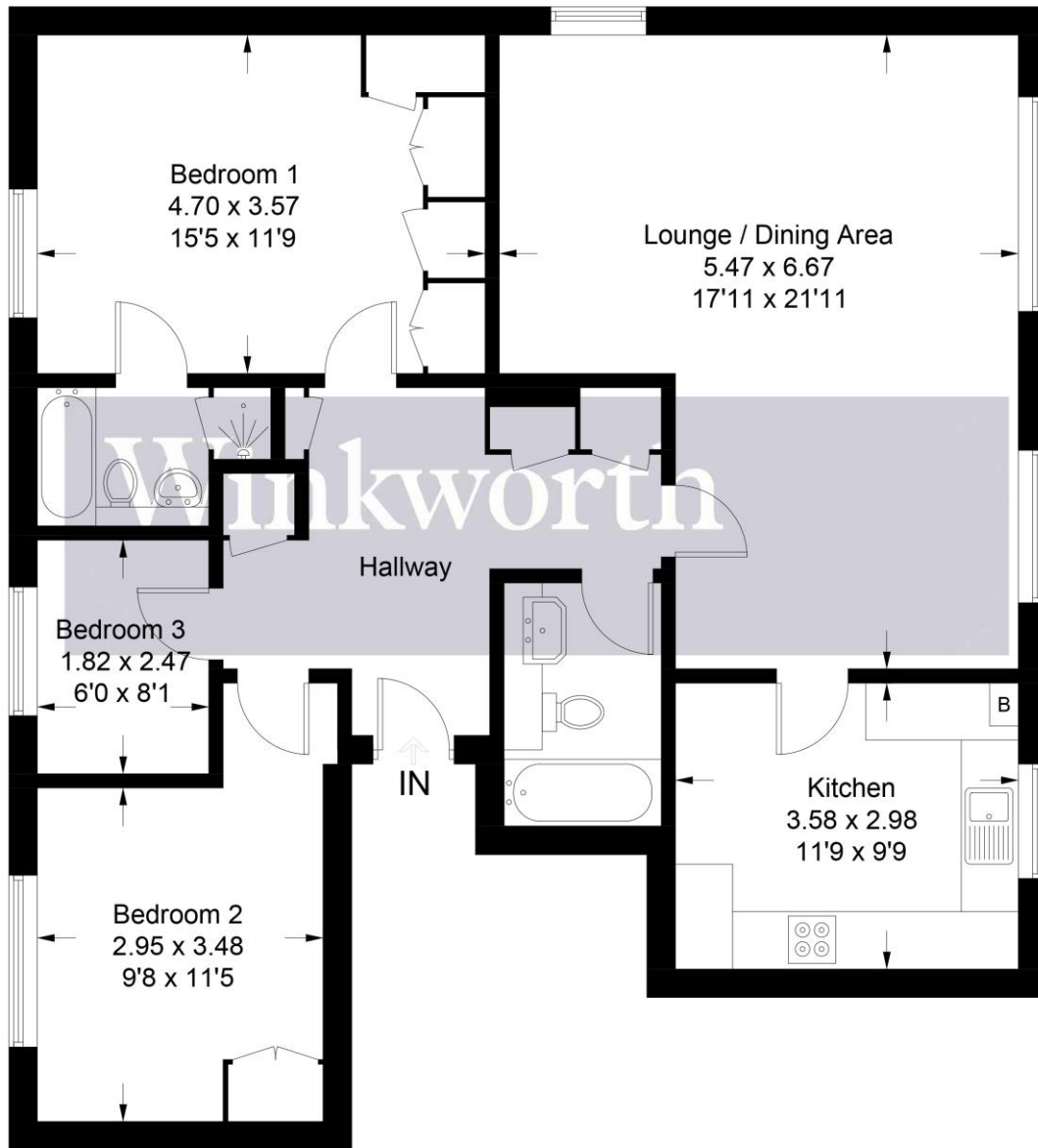

Illustration for identification purposes only, measurements are approximate, not to scale. Winkworth © 2021 (ID768324)

This floorplan is for illustration purposes only and is not to scale. The position and size of doors, windows, appliances and other features are approximate.

Energy Efficiency Rating		
	Current	Potential
Very energy efficient - lower running costs		
(92-100) A		
(81-91) B		
(69-80) C		
(55-68) D		
(39-54) E		
(21-38) F		
(1-20) G		
Not energy efficient - higher running costs		
England, Scotland & Wales	80	84
EU Directive 2002/91/EC		

Borehamwood | 020 8953 8899 | borehamwood@winkworth.co.uk