

Winkworth

22 Aslett Street, London, SW18 2BN





A three-bedroom terraced house in need of modernisation, located in this very popular Earlsfield location.

Coming to the market for the first time in over a century, the characterful property boasts flexible family accommodation throughout. The entrance hall leads to both reception rooms and then onto the kitchen/dining room. From the kitchen is direct access into a generous sized garden, that also offers potential to extend into both the side return and further into the garden, from the rear of the property.

The upper floor hosts three well-proportioned bedrooms, complemented with a family bathroom. Above is approximately 340 sq. ft. of loft space that has masses of potential to extend into, subject to necessary planning permissions from Wandsworth Council.

Aslett Street is located conveniently in the heart of Earlsfield, in easy reach of amenities, artisan coffee shops, and ample green open space offered by King George's Park and Wandsworth Common. In short walking distance from the house, Earlsfield Station connects this prosperous community with Central London, providing services to Clapham Junction and Waterloo.

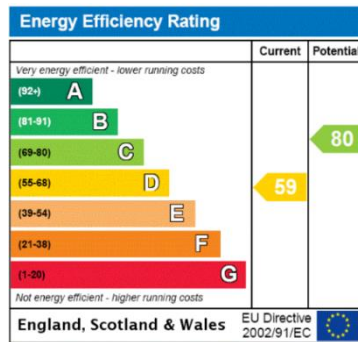

Features

- Masses of potential for renovation and extension
- Garden
- Residents Parking
- Freehold

Leasehold

Internal area

Total 1,111 sq. ft/ 103.21 sq. m

Price

£875,000

Aslett Street, SW18

Approx. Gross Internal Floor Area 1111 sq. ft / 103.21 sq. m (Excuding Loft)

Approx. Gross Internal Floor Area 1451 sq. ft / 134.80 sq. m (Incuding Loft)

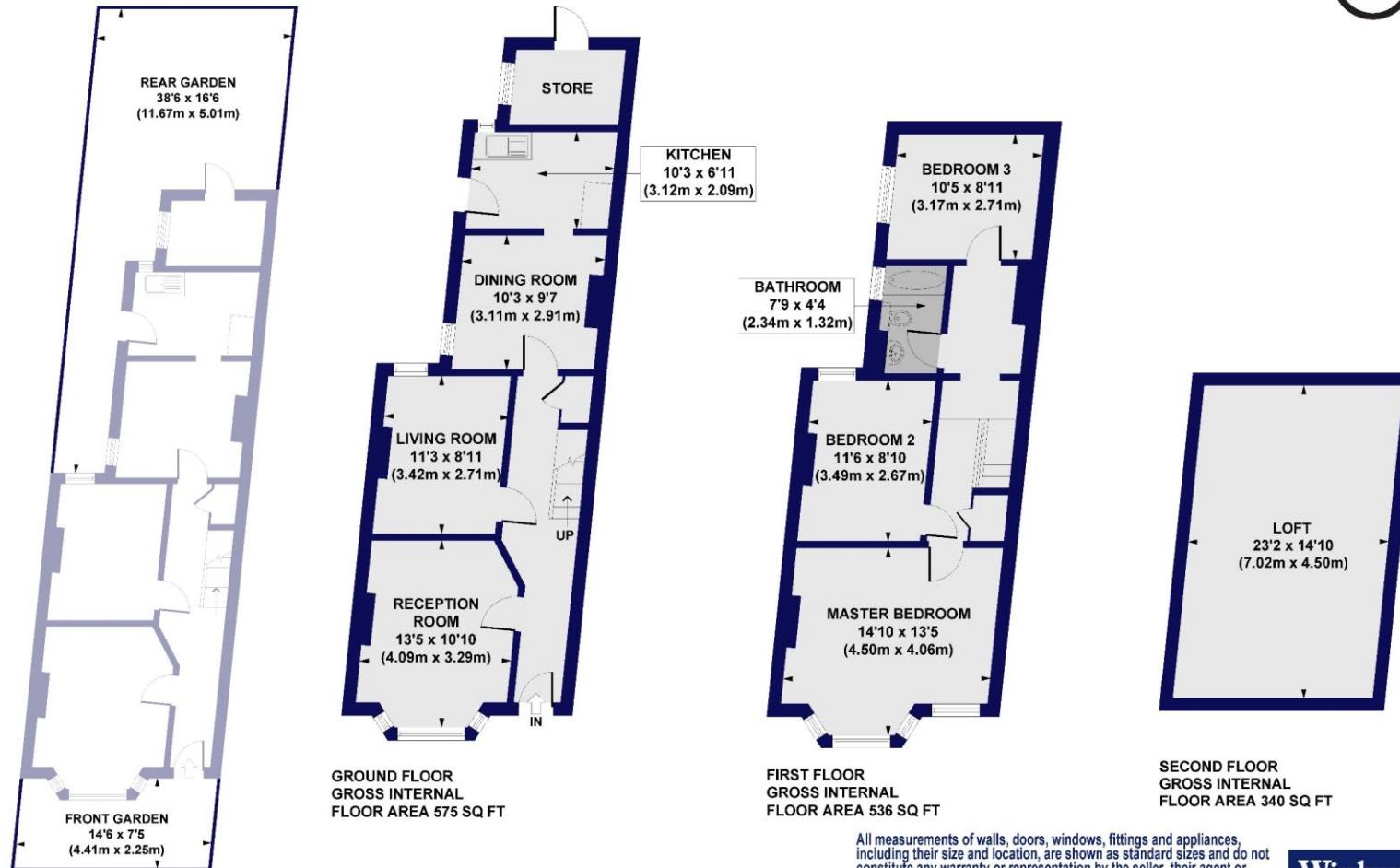

SITE PLAN

All measurements of walls, doors, windows, fittings and appliances, including their size and location, are shown as standard sizes and do not constitute any warranty or representation by the seller, their agent or CP Creative. Any intending purchaser must satisfy himself by inspection or otherwise as to the correctness of the information contained in these plans. This plan is for illustrative purposes only and should be used as such by any prospective purchasers.

Winkworth