



Alexandria Court, West Parley, Ferndown
BH22 8PW
Guide Price £125,000

Winkworth



GUIDE PRICE £125,000 LEASEHOLD

***VACANT POSSESSION**

This spacious one bedroom ground floor retirement apartment for the over 60's is positioned within the popular Alexandria Court development, benefiting from direct access onto a private patio style garden leading to well maintained communal gardens.

The apartment is tucked away at the rear of the development in a quiet position and has recently been decorated throughout.

Further benefits include no onward chain and a remaining lease of 93 years.

01202 434365
ferndown@winkworth.co.uk



KEY FEATURES

- Ground Floor Retirement Apartment
- Private Patio Directly Overlooking Communal Gardens
- Guest Cloakroom
- Resident & Visitor Parking
- Onsite House Manager
- 93 Year Lease Remaining
 - No Onward Chain
- Immaculate Throughout
 - 24hr Care Lines
- Service Charge: £1,311 Per 6 months
- Ground Rent: £256 Per 6 months

EPC TBC | Council Tax Band C



Alexandria Court

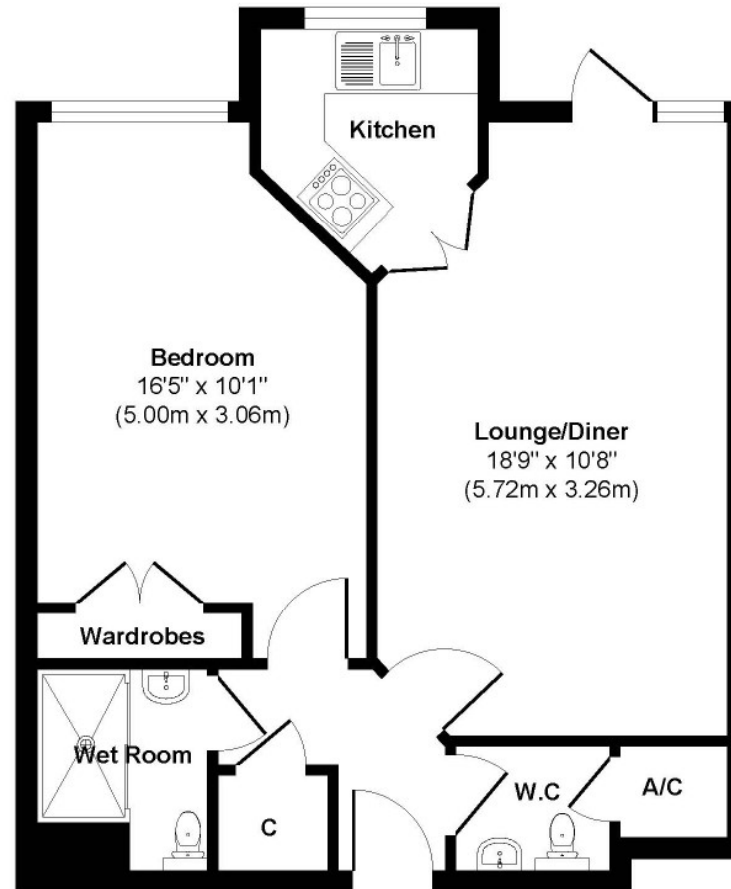

Ground Floor

Approx. Gross Internal Floor Area 497 sq. ft / 46.20 sq. m

Illustration for identification purposes only, measurements are approximate and not to scale.



LOCATION

Alexandria Court is within a short level walk of Ferndown town centre, which has a range of shops, cafes and amenities including an M&S Foodhall and a championship golf course. There are bus routes within walking distance giving you easy access to Bournemouth, Poole & Wimborne all of which have an excellent range of shops and leisure facilities. Award winning sandy beaches are just twenty minutes away in Bournemouth and the A31 provides quick access to the New Forest, Southampton, London and beyond.

Winkworth Ferndown

406 Ringwood Road, Ferndown, Dorset, BH22 9AU

01202 434365 | ferndown@winkworth.co.uk

winkworth.co.uk/ferndown

Winkworth