

SYLVAN ROAD, LONDON, SE19
£1,600 PER MONTH UNFURNISHED

A SPLIT LEVEL THREE-BEDROOM VICTORIAN CONVERSION FLAT

Crystal Palace | 02038693222 | crystalpalace@winkworth.co.uk

Tenant Fees Apply: Details of fees for tenant referencing, tenancy agreement admin fees and renewal fees are available on the Winkworth website and the link can be found with the displayed rent for the property. Tenants should ensure they are fully conversant with these upfront fees and other costs that are involved at the outset of the tenancy before making an offer to rent and your local Winkworth office will provide written details upon request.

winkworth.co.uk

Winkworth

for every step...



DESCRIPTION:

We are thrilled to offer to the letting market this split level three bedroom Victorian conversion flat. Set in a lovely detached Victorian building with great period features including stained glass windows, this flat is a must see. The property benefits from a very large communal garden, lots of storage space, and ground floor entryway. Located on Sylvan Road, the very green and leafy section of Crystal Palace, this is an ideal location for the Crystal Palace "triangle", Crystal Palace station and Park, and only steps from Norwood Lakes park. Available 11th July 2022. Council Tax band C.

Winkworth

for every step...



Winkworth

for every step...

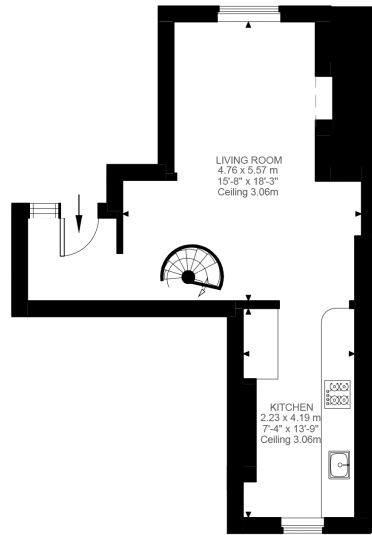

Ground Floor
363 ft²

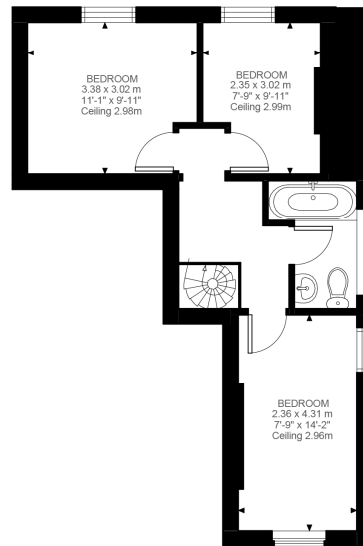

First Floor
413 ft²

Sylvan Road, SE19

Approximate Gross Internal Area

72.13 SQ.M / 776 SQ.FT

KEY: CH = Ceiling Height
Restricted Head Height

Illustration for identification purposes only. Not to scale.
Floor Plan Drawn According To RICS Guidelines.

This floorplan is for illustration purposes only and is not to scale. The position and size of doors, windows, appliances and other features are approximate.

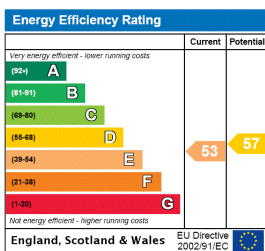

Winkworth

Crystal Palace | 02038693222 | crystalpalace@winkworth.co.uk

for every step...

winkworth.co.uk

Winkworth wishes to inform prospective buyers and tenants that these particulars are a guide and act as information only. All our details are given in good faith and believed to be correct at the time of printing but they don't form part of an offer or contract. No Winkworth employee has authority to make or give any representation or warranty in relation to this property. All fixtures and fittings, whether fitted or not are deemed removable by the vendor unless stated otherwise and room sizes are measured between internal wall surfaces, including furnishings.