



WESTBURY AVENUE, N22
£450,000 LEASEHOLD

DESCRIPTION:

Two bedroom first floor period maisonette with private rear garden, located within close proximity to Turnpike Lane Underground Station.

Harringay | 020 8800 5151 | harringay@winkworth.co.uk

Winkworth

for every step...

winkworth.co.uk

Westbury Avenue, N22
Approx. Gross Internal Floor Area 805 sq. ft / 74.76 sq. m

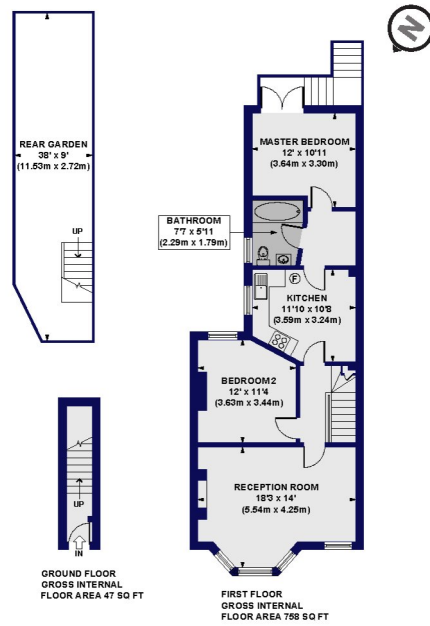

All measurements of walls, doors, windows, fittings and appliances, including gas and electricity, are shown on this plan and do not constitute any warranty or representation by the seller, their agent or Winkworth. Any measurements shown on this plan are for illustrative purposes only and should be used as a guide only. The position and size of doors, windows, appliances and other features are approximate.

This floorplan is for illustration purposes only and is not to scale. The position and size of doors, windows, appliances and other features are approximate.

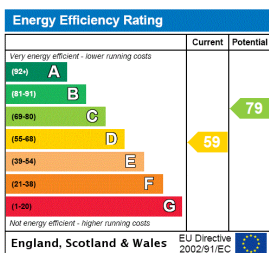

Harringay | 020 8800 5151 | harringay@winkworth.co.uk

Winkworth

for every step...

winkworth.co.uk

winkworth wishes to inform prospective buyers and tenants that these particulars are a guide and act as information only. All our details are given in good faith and believed to be correct at the time of printing but they don't form part of an offer or contract. No winkworth employee has authority to make or give any representation or warranty in relation to this property. All fixtures and fittings, whether fitted or not are deemed removable by the vendor unless stated otherwise and room sizes are measured between internal wall surfaces, including furnishings.