



FURZEHILL ROAD, HERTFORDSHIRE, WD6
£650,000 FREEHOLD

**AN UNMODERNISED CHARACTER STYLE
PROPERTY IN SOUTH BOREHAMWOOD.**

Borehamwood | 020 8953 8899 | borehamwood@winkworth.co.uk



DESCRIPTION:

Currently configured as two separate self-contained flats, this four bedroom character style semi-detached property is offered for sale chain free.

In need of modernisation throughout, the overall accommodation totals approaching 1300 square feet and could be either modernised in its current layout or converted back to its original use as a family house, subject to the usual planning consents.

Located in South Borehamwood, a moment's walk from the town centre and Thameslink station the property benefits from a South Westerly facing garden and two parking spaces to the rear and would be attractive to both investors and end users.

AT A GLANCE

- 4 Bedrooms
- Three Receptions
- Chain Free
- 1266 Square Feet
- South Westerly Rear Garden
- Two Parking Spaces to Rear
- South Borehamwood





Approximate Gross Internal Area = 117.6 sq m / 1266 sq ft

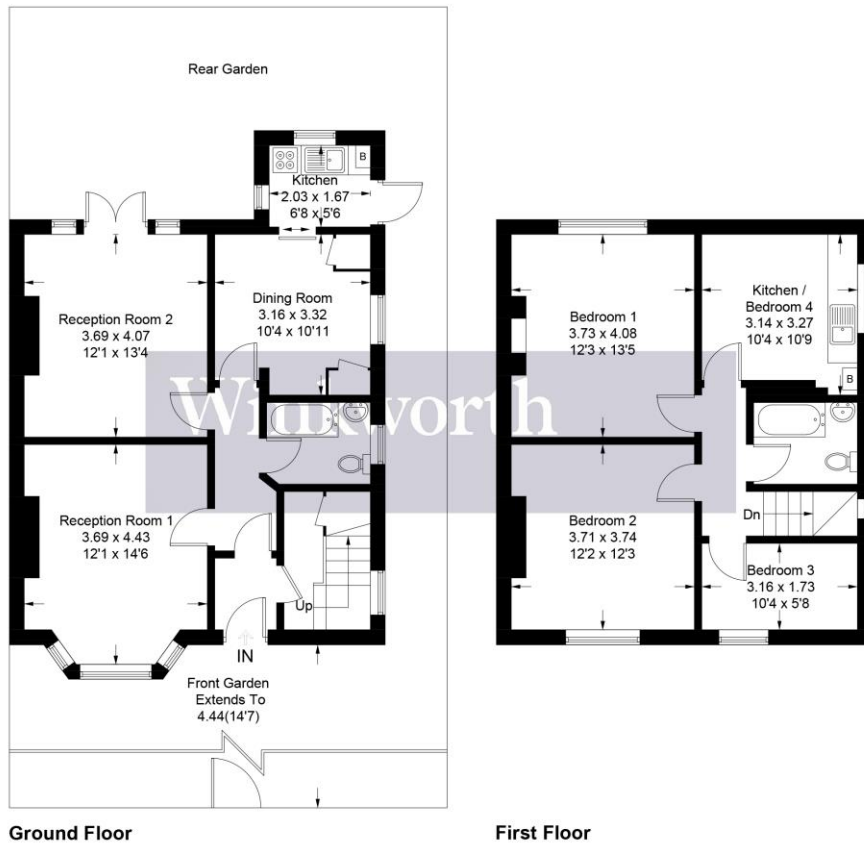

Illustration for identification purposes only, measurements are approximate, not to scale. Winkworth © 2023 (ID1025242)

This floorplan is for illustration purposes only and is not to scale. The position and size of doors, windows, appliances and other features are approximate.