



CEDAR PLACE, 14 BRUCE GROVE, TOTTENHAM, LONDON, N17
£385,000 LEASEHOLD

A ONE BEDROOM GARDEN FLAT

Harringay | 020 8800 5151 | harringay@winkworth.co.uk



DESCRIPTION:

A well-presented one bedroom ground floor conversion within this attractive grade 2 listed Georgian building in Bruce Grove N17.





Cedar Place, Bruce Grove, N17
Approx. Gross Internal Floor Area 638 sq. ft / 59.25 sq. m

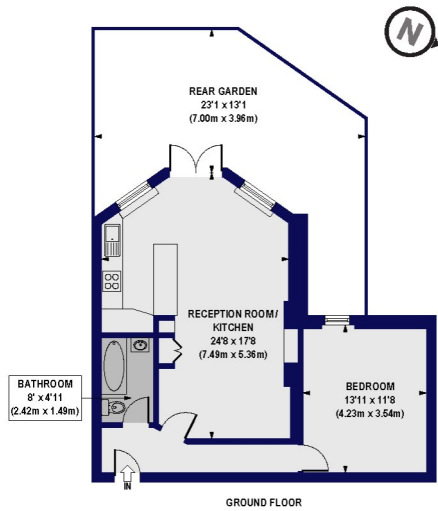

All measurements of walls, doors, windows, fittings and appliances, include plaster and insulation, as shown in standard form and do not include any repairs or replacement by the seller, their agent or 3rd Parties. Any measurements shown must always be confirmed and otherwise as to the correctness of the information contained in these plans. This plan is for illustration purposes only and should be used as a guide only for prospective purchasers.

Winkworth

This floorplan is for illustration purposes only and is not to scale. The position and size of doors, windows, appliances and other features are approximate.

