



MANOR COURT, W3 £375,000 LEASEHOLD

Tenure: 125 years from 1995 (approx. 94 years remaining)

Ground rent: £200 per annum

Service Charge: £2,575 per annum

(Information Supplied by vendor)

EPC: C

Council Tax Band: C

Ealing & Acton | 0208 896 0123 | ealing@winkworth.co.uk

Winkworth

for every step...

winkworth.co.uk



DESCRIPTION:

Spacious two bedroom apartment which is offered to the market in very good condition throughout and with no onward chain. Situated within a gated development, the property provides 659 sq ft of internal accommodation and is comprised of two bedrooms, generously-sized reception room, separate kitchen and a modern bathroom. It further benefits from an allocated off-street parking space.

The property is located 0.9 miles away from Gunnersbury station (District and Overground lines) and the open green space of Gunnersbury Park is just a short walk away.



Winkworth

for every step...



Winkworth

for every step...

Manor Court, W3

Approx. Gross Internal Area 659 Sq Ft - 61.22 Sq M

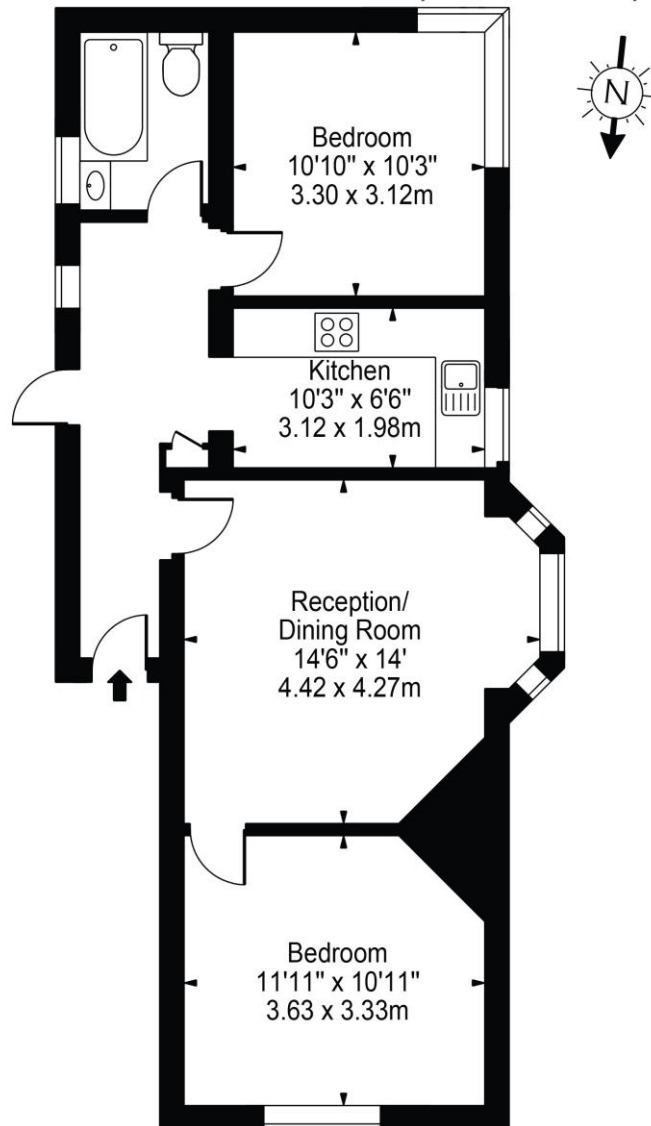

Second Floor

For Illustration Purposes Only - Not To Scale Floor Plan by Mira Nikolova Photography

This floor plan should be used as a general outline for guidance only and does not constitute in whole or in part an offer or contract. Any intending purchaser or lessee should satisfy themselves by inspection, searches, enquiries and full survey as to the correctness of each statement. Any areas, measurements or distances quoted are approximate and should not be used to value a property or be the basis of any sale or let.

This floorplan is for illustration purposes only and is not to scale. The position and size of doors, windows, appliances and other features are approximate.

Score	Energy rating	Current	Potential
92+	A		
81-91	B		
69-80	C	70 C	80 C
55-68	D		
39-54	E		
21-38	F		
1-20	G		

Tenure: Leasehold

Term: 94 years and 6 months

Service Charge: £2,575 per annum (subject to increase)

Ground Rent: £200 per annum (subject to increase)

Council Tax Band: C

Where no figures are shown, we have been unable to ascertain the information. All figures that are shown were correct at the time of printing.

Winkworth

Ealing & Acton | 0208 896 0123 | ealing@winkworth.co.uk

for every step...

winkworth.co.uk

Winkworth wishes to inform prospective buyers and tenants that these particulars are a guide and act as information only. All our details are given in good faith and believed to be correct at the time of printing but they don't form part of an offer or contract. No Winkworth employee has authority to make or give any representation or warranty in relation to this property. All fixtures and fittings, whether fitted or not are deemed removable by the vendor unless stated otherwise and room sizes are measured between internal wall surfaces, including furnishings.