

FELIXSTOWE ROAD, NW10
£2,250 PER MONTH UNFURNISHED

A VERY WELL PRESENTED TWO BEDROOM FIRST FLOOR APARTMENT WITH THE LOFT SPACE ALREADY CONVERTED.

Kensal Rise & Queens Park | 0208 960 4947 | kensalrise@winkworth.co.uk

Winkworth

for every step...

winkworth.co.uk



DESCRIPTION:

This lovely split-level flat has over 800 sq.ft. of internal accommodation arranged over two floors. The flat comprises of two bedrooms with the primary bedroom having built in wardrobes, a contemporary three piece bathroom, a modern separate kitchen and a full width bright and airy reception and dining room to the front of the property.

The flat was finished to an excellent standard throughout, with any new tenants being able to move in from 31/07/25

Maintly Unfurnished with the below provided

- Small coffee table in the living room
- Red folding chair 2 or 3
- TV

Council tax - Band B

Ward - Kensal Green

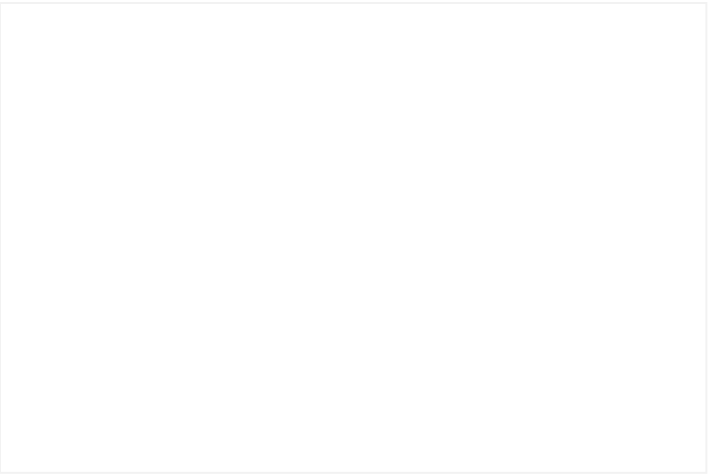
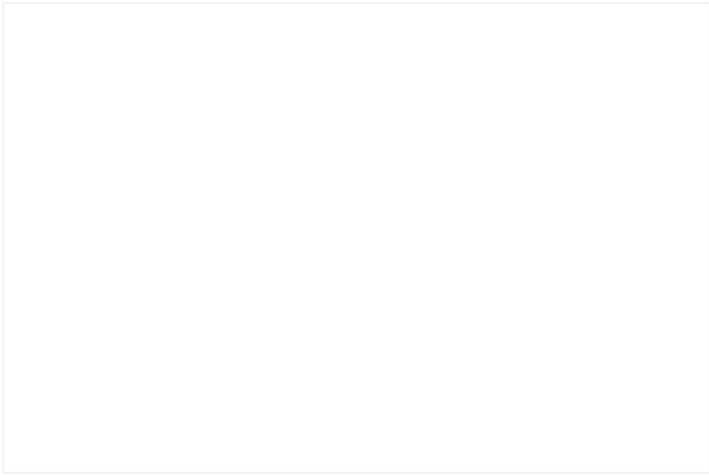
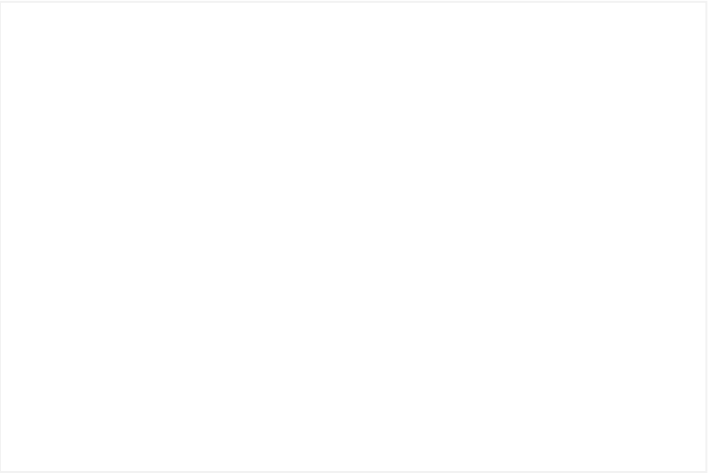

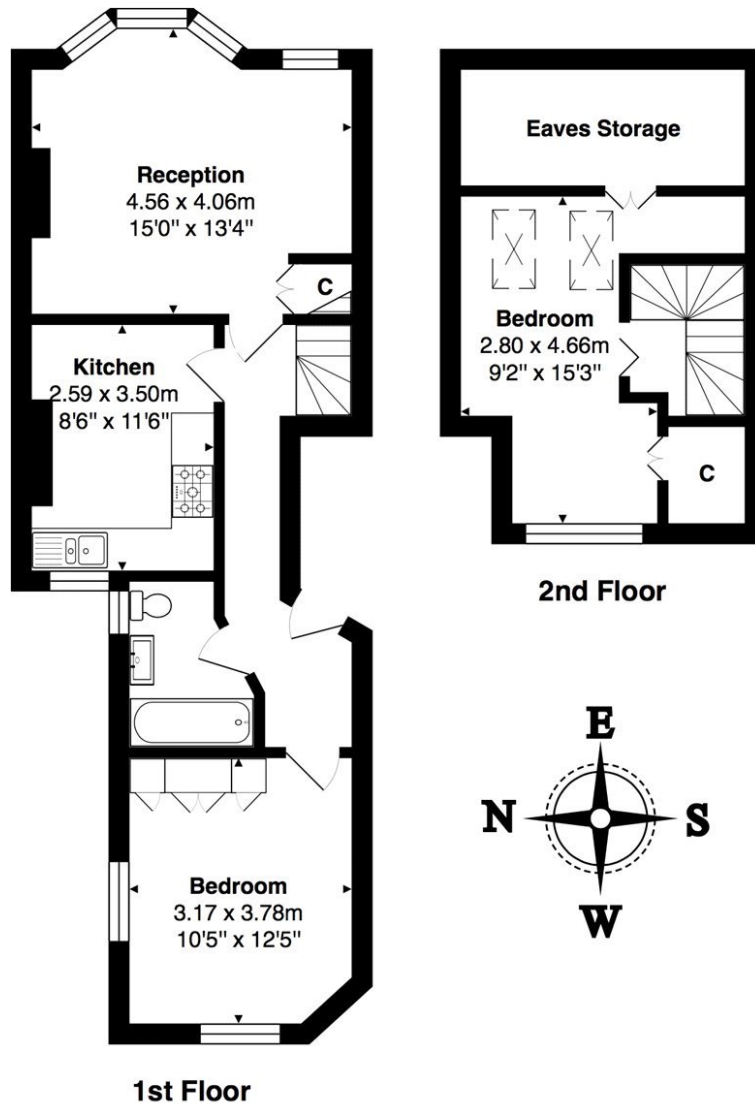

Total Area: 75.9 m² ... 817 ft²
All measurements are approximate and for display purposes only

This floorplan is for illustration purposes only and is not to scale. The position and size of doors, windows, appliances and other features are approximate.

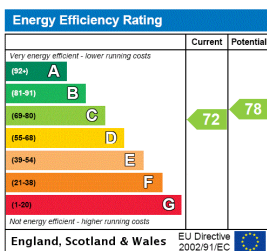

Deposit: £2,596.15

Holding Deposit:

Council Tax Band: B

Where no figures are shown, we have been unable to ascertain the information. All figures that are shown were correct at the time of printing.

Winkworth

Kensal Rise & Queens Park | 0208 960 4947 | kensalrise@winkworth.co.uk

for every step...

winkworth.co.uk

Winkworth wishes to inform prospective buyers and tenants that these particulars are a guide and act as information only. All our details are given in good faith and believed to be correct at the time of printing but they don't form part of an offer or contract. No Winkworth employee has authority to make or give any representation or warranty in relation to this property. All fixtures and fittings, whether fitted or not are deemed removable by the vendor unless stated otherwise and room sizes are measured between internal wall surfaces, including furnishings.