



FLAT 2, 29 OLD TIVERTON ROAD, EXETER, EX4 6LG

Winkworth



Old Tiverton Road is located ideally for access to the city centre, local shops and Exeter university. The property is a one bedroom ground floor flat with living room, kitchen and shower room. The property would make an ideal investment or first time home.

- At a glance...
- One large double Bedroom
- Good Size Living Room
- Shower Room
- Fitted Kitchen
- Ground Floor
- Good Condition Throughout
- Share of Freehold
- Easy Access to Exeter City Centre
- Viewing Recommended

Utilities ...

- All mains services connected
- Share of Freehold
- Lease 999 years from 2004
- Service Charge £60 per month
- Council tax band A

01392 271177 | exeter@winkworth.co.uk

Old Tiverton Road is located in the st.James area of Exeter and offers easy access to the city centre, Exeter university and St. James railway station for with regular services to Exeter central station, Paington & Exmouth.

The Property

Situated on the ground floor, this one bedroom flat is offered in good condition with one double bedroom, living room with fire place and large sash window with a front aspect. Kitchen with some built in appliances and shower room. The property would make an ideal investment or first time home. Offered with a long lease and share of the freehold, the service charges are only £60 per calendar month. The heating and water is fired by a gas combination boiler fitted approximately five years ago. The central fire alarm system has recently been upgraded to comply with current regulations.

The external parts of the building to the front have recently been redecorated with plans to continue this work to the rear.

Location:

Exeter is a Cathedral city and capital of Exeter and is surrounded by beautiful countryside. In addition to this, access to Devon's two coastline and national parks are also easy accessible. The city offers an extensive range of shops, both large high street names and a number of independent traders. You will also find a good selection of bars, cafes and restaurants. The historic quay side is also easily accessible with its selection of shops, bars and restaurants. The city also offers a variety of large parks, places of historic interest and great sporting facilities. The city also has great cycle and walk ways along the river and canal, offering access to the coastal towns of Exmouth and Dawlish



Old Tiverton Road, Exeter, EX4

Approximate Area = 490 sq ft / 45.5 sq m

For identification only - Not to scale

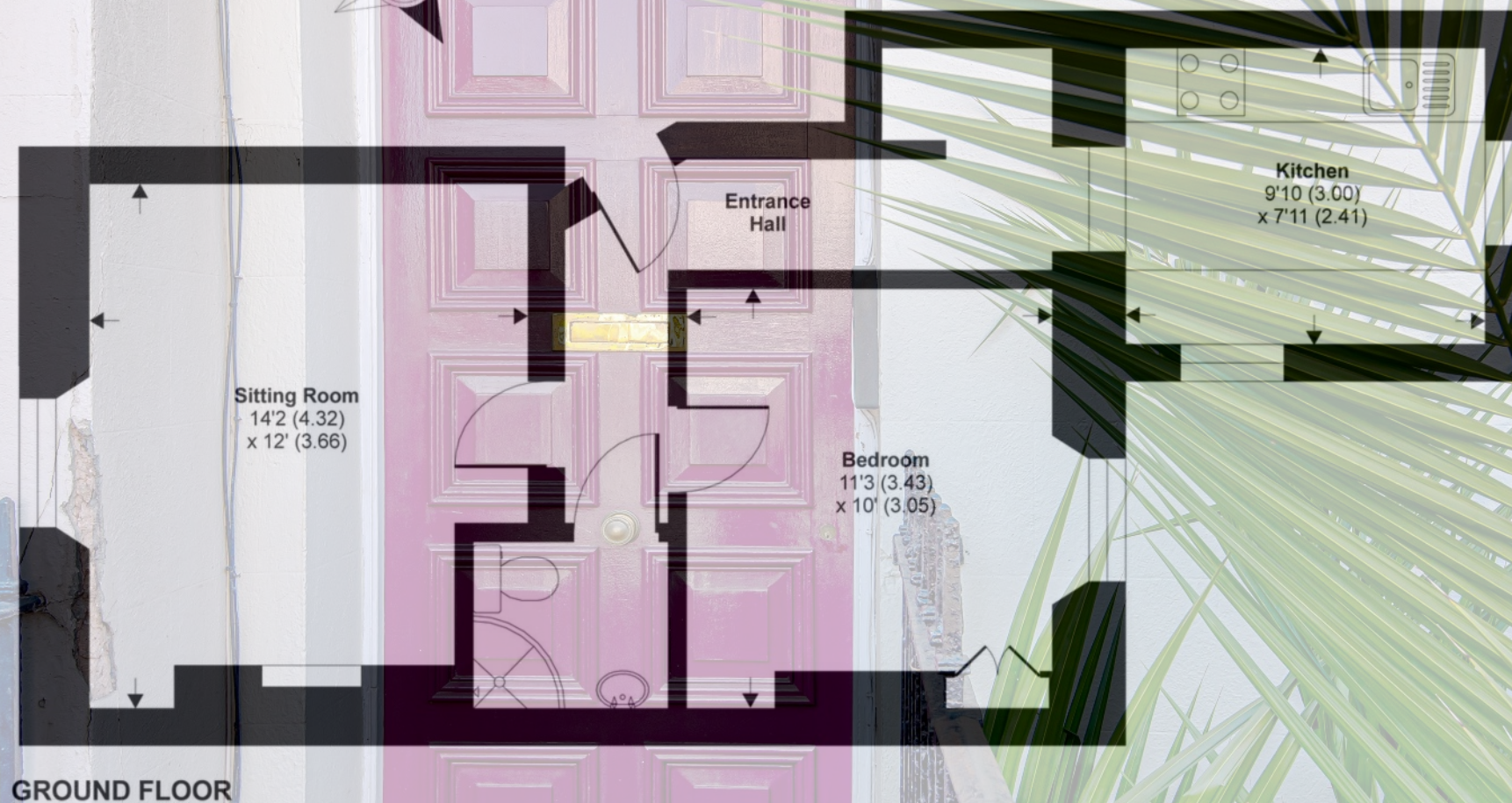

Exeter office

25 Southernhay East, Exeter, EX1 1QP
01392 271177 exeter@winkworth.co.uk

winkworth.co.uk/exeter

Winkworth

See things differently.