



HIGH STREET, KT13
£210,000 LEASEHOLD

DESCRIPTION:

A spacious one bedroom second floor flat with its own entrance located centrally in Weybridge High Street with ease of access to all of its bars, restaurants and local amenities. The Weybridge mainline train station with an approximately 35 minute commute to Central London is within a short walk. The property also has the benefit off-street car parking.

Weybridge | 01932 854400 | weybridge@winkworth.co.uk

Winkworth

for every step...

winkworth.co.uk

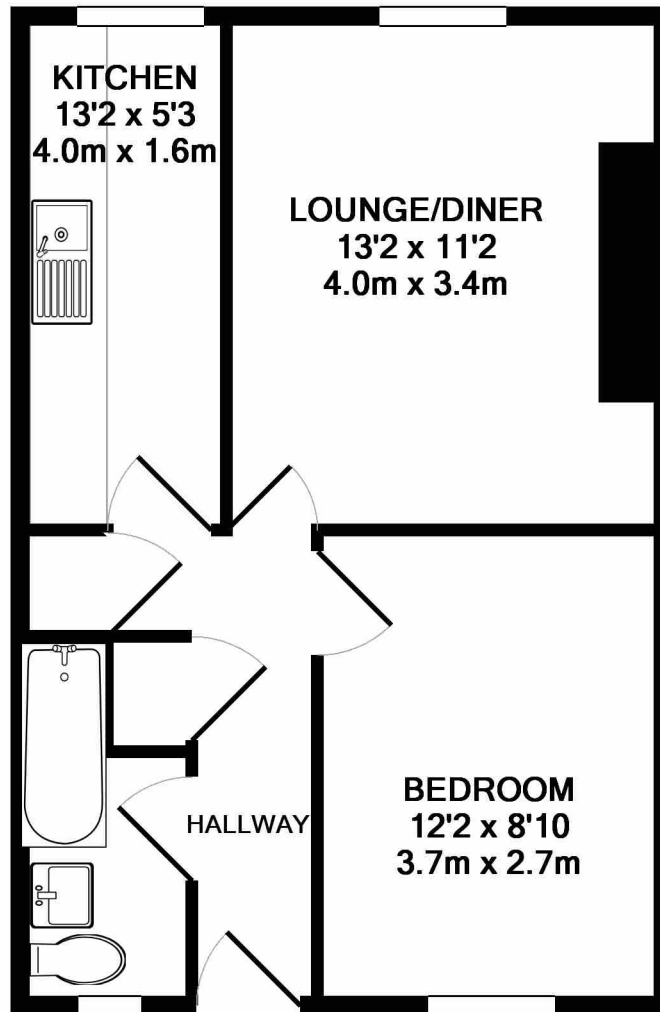

HIGH STREET, WEYBRIDGE
TOTAL APPROX. FLOOR AREA 406 SQ.FT. (37.7 SQ.M.)

Whilst every attempt has been made to ensure the accuracy of the floor plan contained here, measurements of doors, windows, rooms and any other items are approximate and no responsibility is taken for any error, omission, or mis-statement. This plan is for illustrative purposes only and should be used as such by any prospective purchaser. The services, systems and appliances shown have not been tested and no guarantee as to their operability or efficiency can be given
 Made with Metropix ©2019

This floorplan is for illustration purposes only and is not to scale. The position and size of doors, windows, appliances and other features are approximate.

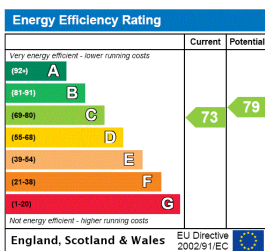

Weybridge | 01932 854400 | weybridge@winkworth.co.uk



for every step...

winkworth.co.uk

Winkworth wishes to inform prospective buyers and tenants that these particulars are a guide and act as information only. All our details are given in good faith and believed to be correct at the time of printing but they don't form part of an offer or contract. No Winkworth employee has authority to make or give any representation or warranty in relation to this property. All fixtures and fittings, whether fitted or not are deemed removable by the vendor unless stated otherwise and room sizes are measured between internal wall surfaces, including furnishings.