



WRICKLEMARSH ROAD, BLACKHEATH, LONDON, SE3 0NF
OFFERS IN EXCESS OF £875,000 FREEHOLD

A SUPERB AND SPACIOUS THREE BEDROOM, TWO RECEPTION ROOM, SEMI-DETACHED 1930'S HOUSE WITH FANTASTIC POTENTIAL TO EXTEND, A GARAGE AND 90 FT. SOUTH FACING GARDEN JUST ¾ MILE FROM BLACKHEATH VILLAGE.

Blackheath | 0208 8520999 | blackheath@winkworth.co.uk



DESCRIPTION:

The property is in excellent decorative order with features including; high ceilings, wood flooring, double glazed windows and gas fired central heating.

The accommodation comprises to the ground floor; a good size front reception room with bay window and fireplace, a good size rear reception room with patio doors to a modern conservatory and a separate modern kitchen. Upstairs are three bedrooms (two large doubles and a generous single bedroom), and a very attractive modern bathroom and a separate WC. To the rear is a fantastic 90ft south facing garden, a garage, side access and off street parking to the front for two/three cars. In our opinion the house offers excellent potential to extend as many neighbouring properties have done. (STPP).

This is a wonderful family home and your earliest viewing is essential. Video tour can be seen at Winkworth.co.uk

This section of Wricklemarsh Road is incredibly popular and properties are a very rare find. It is very convenient for transport links with buses stopping for Blackheath Station, 0.75 miles, Greenwich and North Greenwich, 1.9 miles. Blackheath Village with its array of restaurants, bar, boutique shops and farmers market is only 0.7 miles. There are many parks and green open spaces to enjoy, including Hornfair Park (with the Charlton Lido, cafe, tennis courts and BMX track within its bounds), Charlton House (gardens, play area and skate park), Oxleas Woods, Shrewsbury Park and nearest of all Blackheath Common and Greenwich Park.





Ground Floor

Approx. 56.1 sq. metres (604.3 sq. feet)

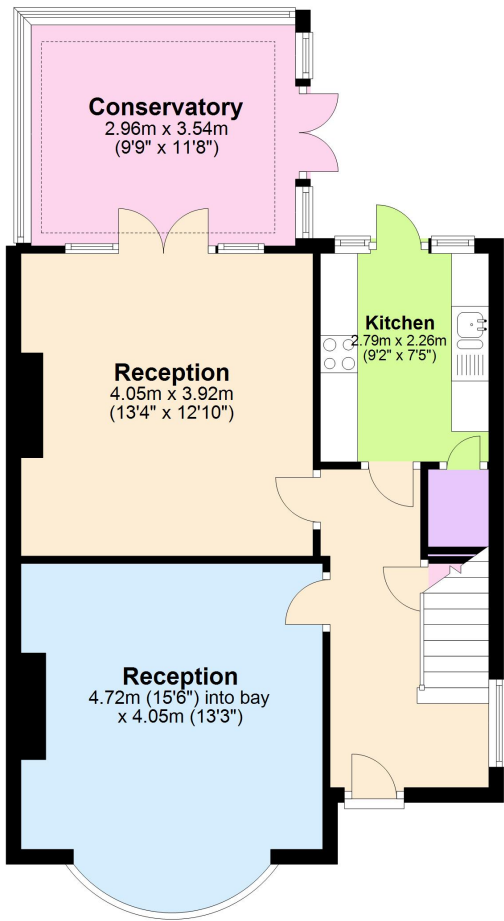

First Floor

Approx. 51.2 sq. metres (550.6 sq. feet)

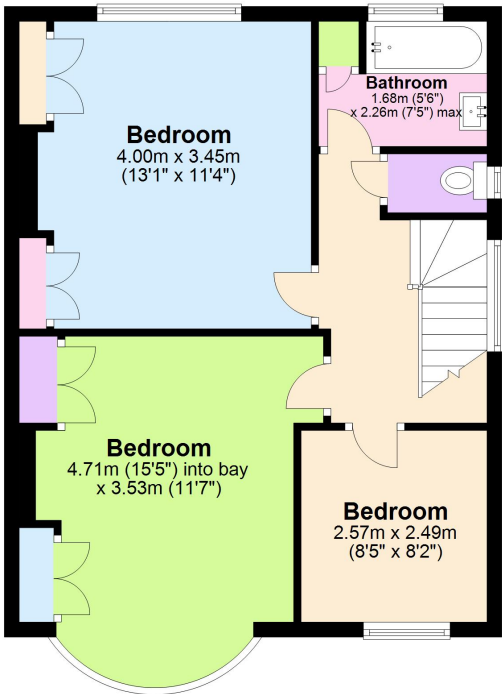

Total area: approx. 107.3 sq. metres (1154.9 sq. feet)

This floorplan is for illustration purposes only and is not to scale. The position and size of doors, windows, appliances and other features are approximate. Any lease and service charge details have been provided by the vendor. Any interest party should have these checked by a solicitor as part of the purchase process.

