



**EAST DULWICH GROVE, EAST DULWICH, SE22  
OFFERS IN EXCESS OF £600,000 SHARE OF FREEHOLD**

**AN IMPRESSIVE TWO DOUBLE BEDROOM  
GROUND FLOOR GARDEN FLAT IS SITUATED IN  
A PRIME CENTRAL EAST DULWICH LOCATION.**

Dulwich | 020 8299 2722 | [dulwich@winkworth.co.uk](mailto:dulwich@winkworth.co.uk)

**Winkworth**

*winkworth.co.uk*

See things differently



## DESCRIPTION:

This newly refurbished and impressive two double bedroom ground floor garden flat is situated on a prime central East Dulwich location, close to the bars and restaurants on Lordship Lane and Dulwich Village. The flat offers two double bedrooms, modern bathroom and a large open planned kitchen-reception with bi-fold doors leading out to the private garden to the rear. This is a wonderful flat in a superb location also with all brand-new fixtures and fittings provided throughout. You also have easy access to the bars and restaurants on Lordship Lane, both Dulwich Park and Peckham Rye Park are just a short walk away and transport links into Central London are superb including the East London tube line at Denmark Hill or Peckham Rye stations.

## AT A GLANCE

- Two Double Bedrooms
- Ground Floor Flat
- Open Plan Kitchen-Reception
- Modern Bathroom
- Garden
- Recently Refurbished
- Share of Freehold





# East Dulwich Grove, East Dulwich, SE22

Approximate Gross Internal Area = 54.7 sq m / 589 sq ft

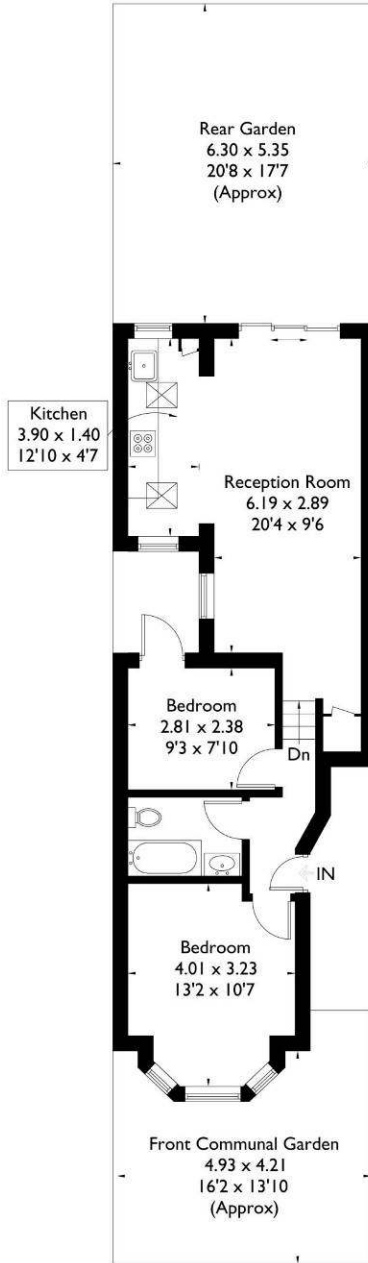

Ground Floor

FLOORPLANZ © 2016 0845 6344080 Ref: 163910

This plan is for layout guidance only. Drawn in accordance with RICS guidelines. Not drawn to scale unless stated. Windows & door openings are approximate. Whilst every care is taken in the preparation of this plan, please check all dimensions, shapes & compass bearings before making any decisions reliant upon them.

This floorplan is for illustration purposes only and is not to scale. The position and size of doors, windows, appliances and other features are approximate.

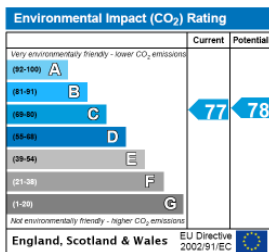
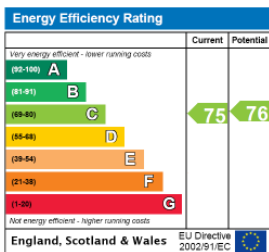

Dulwich | 020 8299 2722 | dulwich@winkworth.co.uk



winkworth.co.uk

See things differently

Winkworth wishes to inform prospective buyers and tenants that these particulars are a guide and act as information only. All our details are given in good faith and believed to be correct at the time of printing but they don't form part of an offer or contract. No Winkworth employee has authority to make or give any representation or warranty in relation to this property. All fixtures and fittings, whether fitted or not are deemed removable by the vendor unless stated otherwise and room sizes are measured between internal wall surfaces, including furnishings.