

BROWNS HILL, DARTMOUTH
£169,000 FLYING FREEHOLD

A LOCK UP AND LEAVE PROPERTY IN THE HEART OF DARTMOUTH

Dartmouth | 01803 832288 | dartmouth@winkworth.co.uk

Winkworth

for every step...

winkworth.co.uk

DIRECTIONS: (One minutes' walk from our Winkworth Office) From our office turn right on Market Street, into Broadstone. Pass Newport Street on your left, then take the next left onto Browns Hill.

DESCRIPTION: Located on one of Dartmouth's most photographed pedestrian ways and so central to town. Minutes' walk to The Market, Royal Avenue Gardens, and the River Dart. This Flying Freehold property has been well maintained but is ready for its makeover. Ideal as a holiday let, long term let, or come on down and enjoy it for yourself?

Central location

Area of Outstanding Beauty

Conservation area

1 Bedroom

Lockup and leave

Separate Dining Room

Electric Heating

POSTCODE: TQ6 9NU

EPC RATING: D

COUNCIL TAX BAND: B

SERVICES - Water and electricity are connected.

N.B - This property is a Flying Freehold

Energy Efficiency Rating		Current	Potential
Very energy efficient - lower running costs			
92-100	A		
81-91	B		
69-80	C		
55-68	D		
39-54	E		
21-38	F		
1-20	G		
Not energy efficient - higher running costs			
		59	81
England, Scotland & Wales		EU Directive 2002/91/EC	

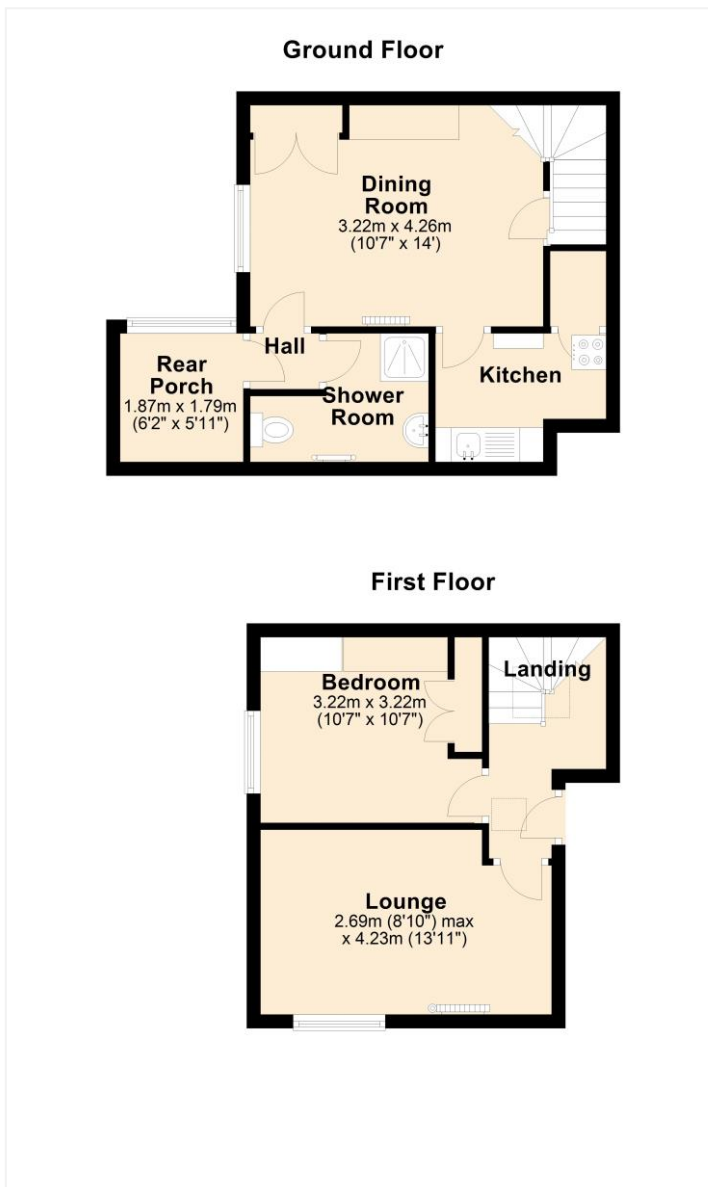

This floorplan is for illustration purposes only and is not to scale. The position and size of doors, windows, appliances and other features are approximate.

Dartmouth | 01803 832288 | dartmouth@winkworth.co.uk

Winkworth

for every step...

winkworth.co.uk

Winkworth wishes to inform prospective buyers and tenants that these particulars are a guide and act as information only. All our details are given in good faith and believed to be correct at the time of printing but they don't form part of an offer or contract. No Winkworth employee has authority to make or give any representation or warranty in relation to this property. All fixtures and fittings, whether fitted or not are deemed removable by the vendor unless stated otherwise and room sizes are measured between internal wall surfaces, including furnishings.