



ESKMONT RIDGE, SE19
£1,475 PER MONTH UNFURNISHED

BEAUTIFULLY PRESENTED ONE BEDROOM FLAT TO RENT

Crystal Palace | 02038693222 | crystalpalace@winkworth.co.uk

Winkworth

for every step...

winkworth.co.uk



DESCRIPTION:

Winkworth is pleased to offer this beautifully presented one bedroom ground floor flat, set within this popular purpose built block conveniently located between the amenities and green spaces of Crystal Palace & South Norwood.

The property is in superb cosmetic condition and comprises a well-sized living space with space to dine, separate fitted kitchen, and a good-sized double bedroom with built in wardrobes and modern bathroom.

The property further benefits from residents parking and well-maintained communal gardens. There is also the option for renting a garage for an additional £150 per month on top of the rental figure.

AT A GLANCE

- One Bedroom
- Ground Floor Flat
- Separate Fitted Kitchen
- Modern Finish Throughout
- Communal Gardens
- Unfurnished
- Residents Parking
- Garage Available for Additional £150 per month





N
↑
↓
S

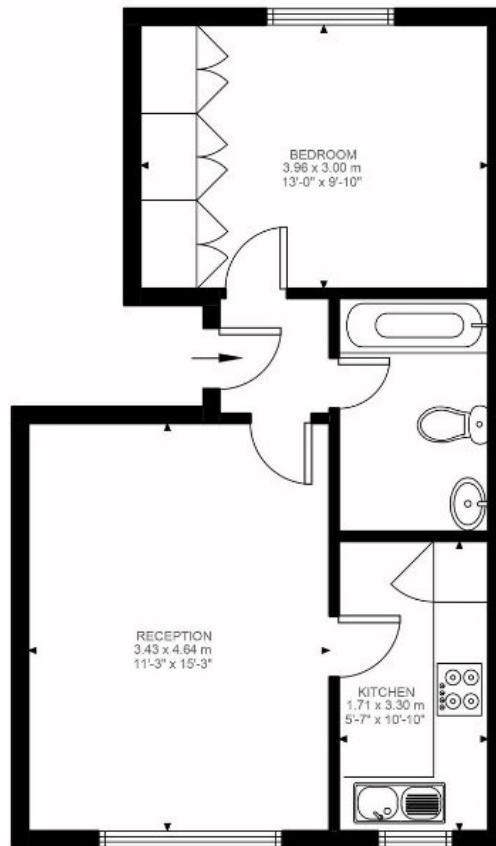

Ground Floor
444 ft²

Eskmont Ridge, SE19
Approximate Gross Internal Area
41.22 SQ.M / 444 SQ.FT

KEY: CH = Ceiling Height
Restricted Head Height

Illustration for identification purposes only. Not to scale.
Floor Plan Drawn According To RICS Guidelines.

This floorplan is for illustration purposes only and is not to scale. The position and size of doors, windows, appliances and other features are approximate.

Deposit: £0.00

Holding Deposit:

Council Tax Band: B

Where no figures are shown, we have been unable to ascertain the information. All figures that are shown were correct at the time of printing.

Energy Efficiency Rating	
Current	Potential
Very energy efficient - lower running costs	
(92+) A	
(81-91) B	
(69-80) C	71 77
(55-68) D	
(39-54) E	
(21-38) F	
(1-20) G	
Not energy efficient - higher running costs	
England, Scotland & Wales EU Directive 2002/91/EC	

Crystal Palace | 02038693222 | crystalpalace@winkworth.co.uk

Winkworth

for every step...

winkworth.co.uk

Winkworth wishes to inform prospective buyers and tenants that these particulars are a guide and act as information only. All our details are given in good faith and believed to be correct at the time of printing but they don't form part of an offer or contract. No Winkworth employee has authority to make or give any representation or warranty in relation to this property. All fixtures and fittings, whether fitted or not are deemed removable by the vendor unless stated otherwise and room sizes are measured between internal wall surfaces, including furnishings.