



BELFORD ROAD, HERTFORDSHIRE, WD6

£200,000 LEASEHOLD

A WELL PRESENTED ONE BEDROOM GROUND FLOOR GARDEN FLAT

Borehamwood | 020 8953 8899 | borehamwood@winkworth.co.uk



DESCRIPTION:

Offered for sale on a Chain Free basis is this spacious and well-presented one bedroom ground floor purpose built garden flat.

Benefitting from its own generous section of garden the property faces open spaces and offers just under 500 square feet of bright and well-proportioned accommodation, is located within walking distance of local shops and bus routes including the 292 and would make an ideal purchase for a first time buyer, downsizer or buy to let investor.

AT A GLANCE

- 1 Bedroom
- 498 Square Feet
- South Westerly Facing Garden
- Gas Central Heating
- Double Glazed
- Chain Free
- Entryphone

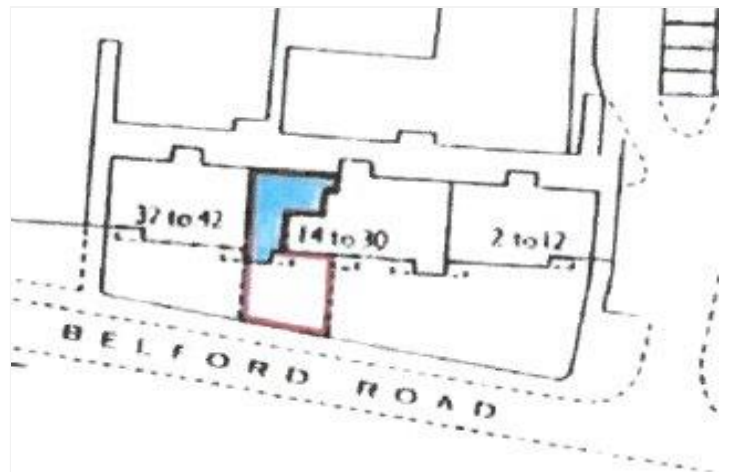



Winkworth



Winkworth

Approximate Gross Internal Area = 46.4 sq m / 499 sq ft

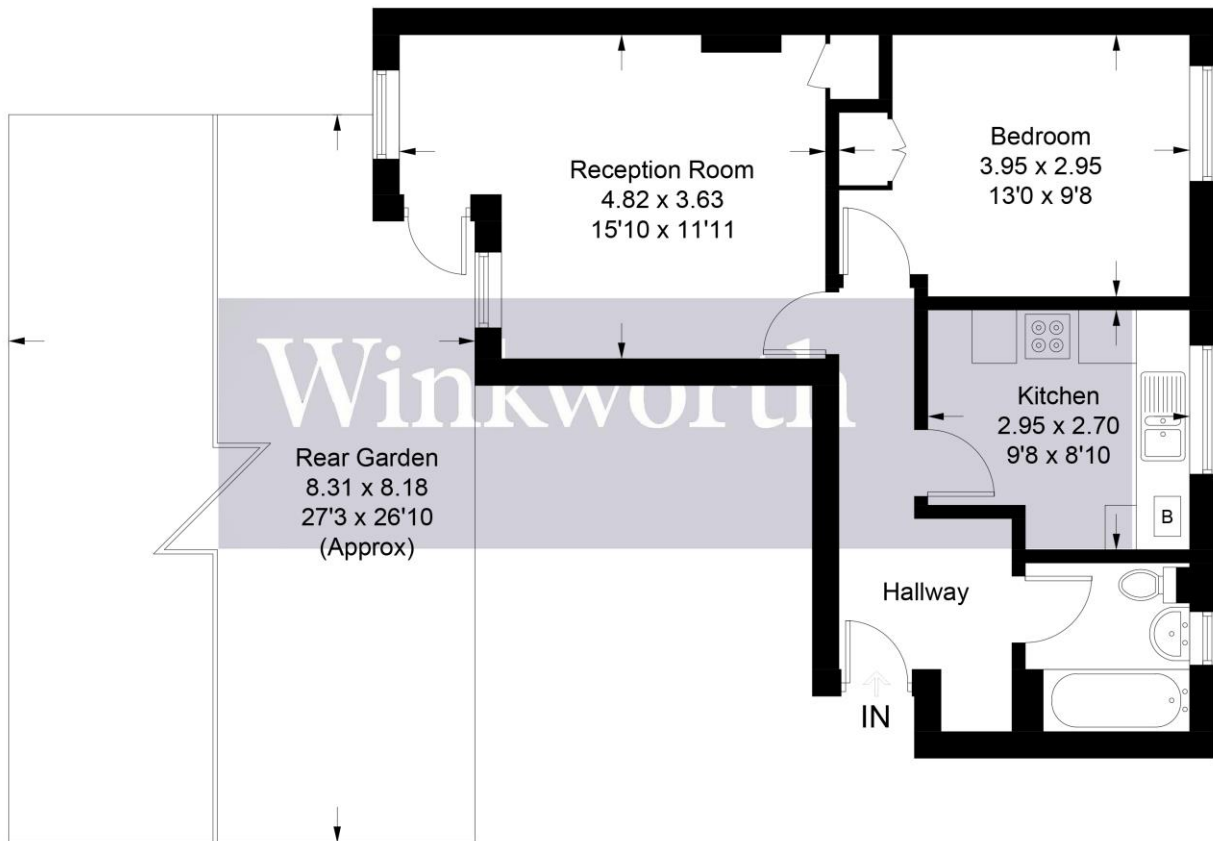
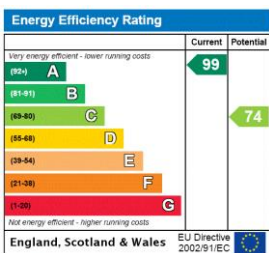

Illustration for identification purposes only, measurements are approximate, not to scale. Winkworth © 2023 (ID1030314)

This floorplan is for illustration purposes only and is not to scale. The position and size of doors, windows, appliances and other features are approximate.



Tenure: Leaseholda
Term: Expires - 18/10/2110
Service Charge: £747.76 per annum
Ground Rent: £ 10 Annually (subject to increase)
Council Tax Band:

Where no figures are shown, we have been unable to ascertain the information. All figures that are shown were correct at the time of printing.