



FAKENHAM CLOSE, LOWER EARLEY, READING, BERKSHIRE, RG6 4AB  
**£365,000 FREEHOLD**

## AN UPGRADED TWO BEDROOM SEMI-DETACHED HOME

Reading | 0118 4022 300 | [reading@winkworth.co.uk](mailto:reading@winkworth.co.uk)

**Winkworth**

for every step...

[winkworth.co.uk](http://winkworth.co.uk)



## DESCRIPTION:

A neat and well-presented home positioned on a popular location within easy access of local amenities including the Asda shopping complex. This two bedroom semi-detached home has been the subject of improvement and upgrading, with a refitted kitchen and shower room. The property further benefits from gas radiator heating and double glazed windows. There is an established garden with a patio providing an ideal alfresco dining space. There is also a garage and driveway parking the property is offered for sale with no onward chain.

## AT A GLANCE

- Two bedroom semi-detached home
- Wonderful cul-de-sac location
- Kitchen/breakfast room
- Re-fitted shower room
- Garage and driveway parking
- No onward chain





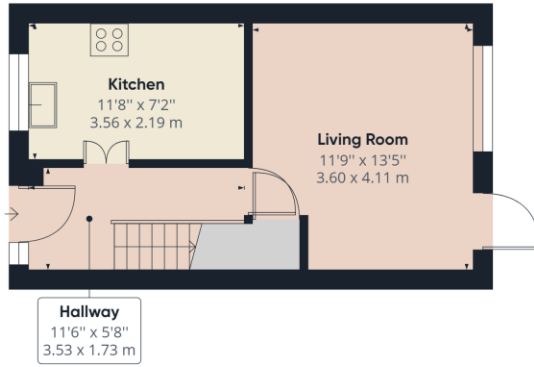

Ground Floor

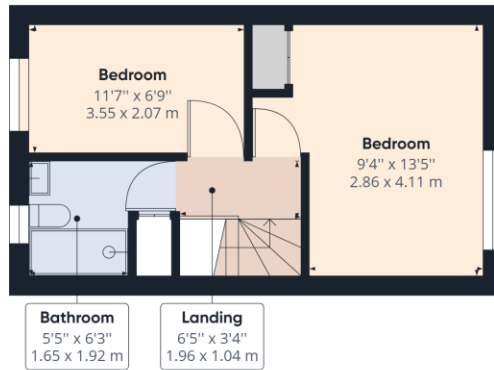

Floor 1

Approximate total area<sup>(1)</sup>  
608.92 ft<sup>2</sup>  
56.57 m<sup>2</sup>

(1) Excluding balconies and terraces

While every attempt has been made to ensure accuracy, all measurements are approximate, not to scale. This floor plan is for illustrative purposes only.

GIRAFFE360

This floorplan is for illustration purposes only and is not to scale. The position and size of doors, windows, appliances and other features are approximate.

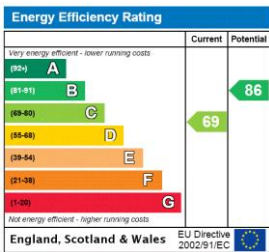

Reading | 0118 4022 300 | reading@winkworth.co.uk

for every step...

winkworth.co.uk

Winkworth wishes to inform prospective buyers and tenants that these particulars are a guide and act as information only. All our details are given in good faith and believed to be correct at the time of printing but they don't form part of an offer or contract. No Winkworth employee has authority to make or give any representation or warranty in relation to this property. All fixtures and fittings, whether fitted or not are deemed removable by the vendor unless stated otherwise and room sizes are measured between internal wall surfaces, including furnishings.