



HAMILTON PARK, LONDON, N5
£850,000 LEASEHOLD

**STUNNING TWO BEDROOM, TOP FLOOR
APARTMENT POSITIONED MOMENTS FROM
HIGHBURY BARN AND HIGHBURY FIELDS.**

Highbury | 0207 989 7000 | highbury@winkworth.co.uk





DESCRIPTION:

Boasting two genuine double bedrooms and an additional room tailored as a home office, this top-floor period conversion is situated on Hamilton Park and seamlessly blends village ambiance with the hustle and bustle of Highbury & Islington. The lateral space ensures ample room for both relaxation and work, with the separate living room and kitchen benefitting from abundant natural light thanks to the new double-glazed sash windows throughout. The flat is completed with authentic oak floorboards to elevate its charm and a contemporary family bathroom. With recent upgrades and a shared garden. There is also the potential to extend into the enormous loft space that spans the length of the building STPP.

Hamilton Park is set moments from the famous green spaces of Highbury Fields, and the prestigious Highbury Barn. The property is moments away from highly regarded local amenities such as Godfrey's butchers, La Fromagerie, Da Mario's delicatessen, Bourne's fishmongers and Highbury Vintners, all of which are hugely popular with locals, as well as drawing those from further afield.

Transport links are well serviced by a selection of good bus routes as well Highbury & Islington station (Victoria and Overground) and Arsenal Station (Piccadilly Line) both within a short distance.

Winkworth



Winkworth

Hamilton Park, N5
Approx. Gross Internal Floor Area 956 sq. ft / 88.83 sq. m

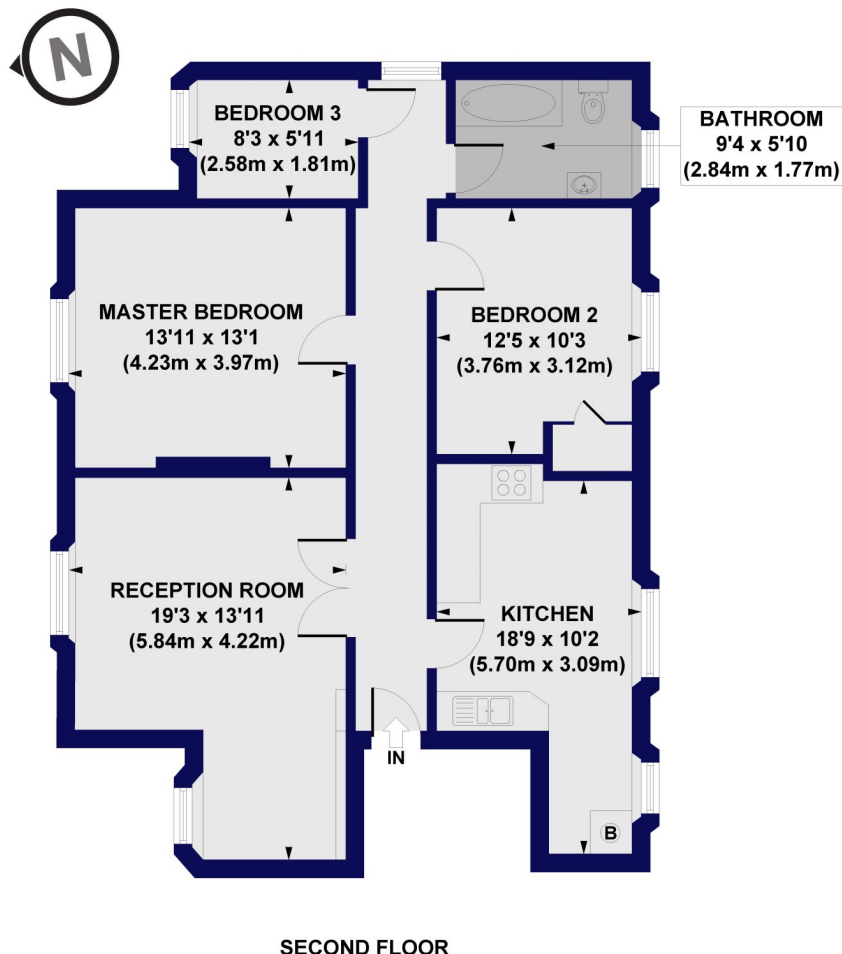

All measurements of walls, doors, windows, fittings and appliances, including their size and location, are shown as standard sizes and do not constitute any warranty or representation by the seller, their agent or CP Creative. Any intending purchaser must satisfy himself by inspection or otherwise as to the correctness of the information contained in these plans. This plan is for illustrative purposes only and should be used as such by any prospective purchasers.

Winkworth

This floorplan is for illustration purposes only and is not to scale. The position and size of doors, windows, appliances and other features are approximate.

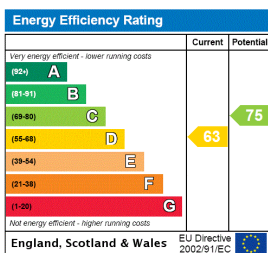

Highbury | 0207 989 7000 | highbury@winkworth.co.uk

Winkworth

winkworth.co.uk

See things differently

Winkworth wishes to inform prospective buyers and tenants that these particulars are a guide and act as information only. All our details are given in good faith and believed to be correct at the time of printing but they don't form part of an offer or contract. No Winkworth employee has authority to make or give any representation or warranty in relation to this property. All fixtures and fittings, whether fitted or not are deemed removable by the vendor unless stated otherwise and room sizes are measured between internal wall surfaces, including furnishings.