



BRUNSWICK HOUSE, THURTLER ROAD, LONDON, E2  
**£525,000 LEASEHOLD**

## A TOP FLOOR THREE DOUBLE BEDROOM APARTMENT CONVENIENT FOR HOXTON STATION.

Hackney | 020 8986 4216 | [hackney@winkworth.co.uk](mailto:hackney@winkworth.co.uk)

**Winkworth**



## DESCRIPTION:

This spacious top-floor apartment in Brunswick House offers excellent living space in a highly convenient East London location. The property features three well-proportioned double bedrooms, a bright reception room, and a separate fitted kitchen, making it an ideal home for sharers, families, or professionals.

### Key Features:

- Three genuine double bedrooms
- Light-filled reception room
- Separate fitted kitchen with good storage and workspace
- Bathroom and en-suite to principal bedroom
- Private balcony with open views
- Secure entry system and lift access

### Transport Links:

- Brunswick House is perfectly placed for quick access across London:
- Bethnal Green Underground (Central Line) – approx. 8 mins walk
- Cambridge Heath Overground – approx. 5 mins walk
- Multiple bus routes connecting to the City, Shoreditch, and Canary Wharf

### Lifestyle & Local Area:

The property is within walking distance of Columbia Road Flower Market, Broadway Market, and Shoreditch. Popular restaurants such as Brawn, Morito, and Sager + Wilde are nearby, along with independent cafés, bakeries, and bars. For green space, both Victoria Park and London Fields are close at hand.

Offering generous space, excellent transport links, and a vibrant local area, this apartment represents a great opportunity in the heart of East London

**Winkworth**





Winkworth

## Brunswick House, E2

Approx. Gross Internal Floor Area 777 sq. ft / 72.15 sq. m

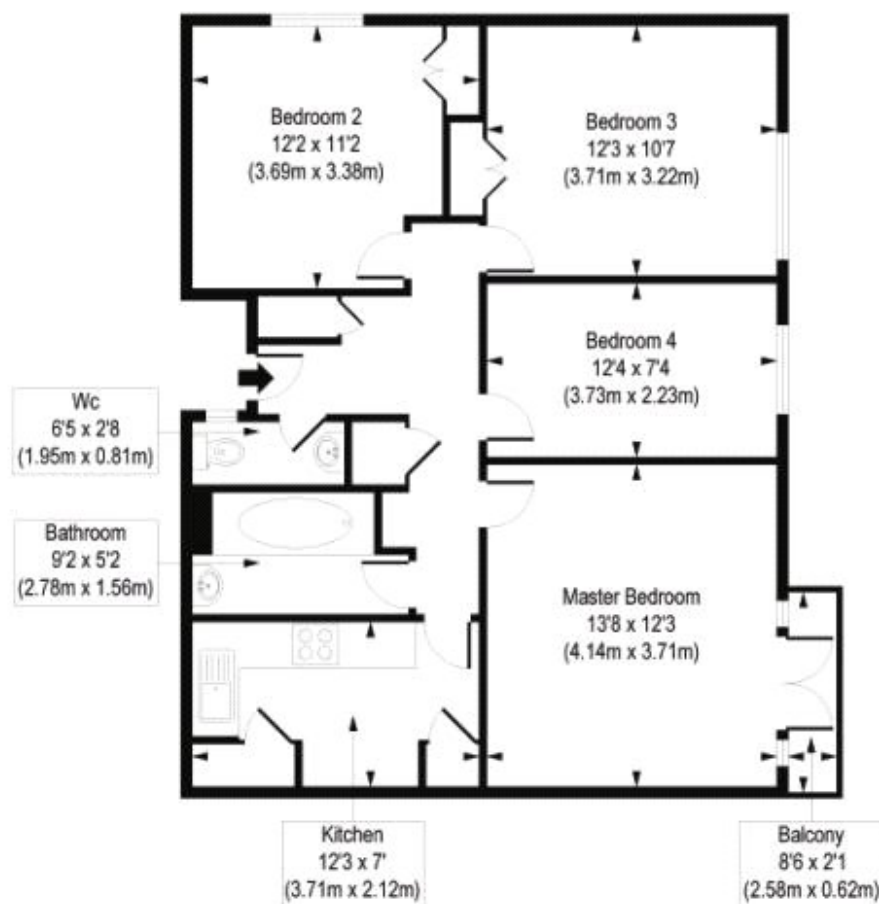
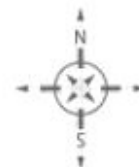

Fourth Floor

COMPLIANT WITH RICS CODE OF MEASURING PRACTICE: Floorplan is for illustrative purposes only and is not to scale. Every attempt has been made to ensure the accuracy of the floorplan shown, however all measurements, fixtures, fittings and data shown are an approximate interpretation for illustrative purposes only. Liability for errors, omissions or mis-statement through negligence or otherwise is hereby excluded.

This floorplan is for illustration purposes only and is not to scale. The position and size of doors, windows, appliances and other features are approximate.

Score	Energy rating	Current	Potential
92+	A		
81-91	B		
69-80	C		79 C
55-68	D	63 D	
39-54	E		
21-38	F		
1-20	G		



<https://www.winkworth.co.uk/sale/property/SO240112>

**Tenure:** Leasehold

**Term:** 90 year and 0 months

**Service Charge:** £2360 per annum

**Ground Rent:** £9 Annually (subject to increase)

**Council Tax Band:** B

Where no figures are shown, we have been unable to ascertain the information. All figures that are shown were correct at the time of printing.

Hackney | 020 8986 4216 | [hackney@winkworth.co.uk](mailto:hackney@winkworth.co.uk)

**Winkworth**

[winkworth.co.uk](https://www.winkworth.co.uk)

See things differently

Winkworth wishes to inform prospective buyers and tenants that these particulars are a guide and act as information only. All our details are given in good faith and believed to be correct at the time of printing but they don't form part of an offer or contract. No Winkworth employee has authority to make or give any representation or warranty in relation to this property. All fixtures and fittings, whether fitted or not are deemed removable by the vendor unless stated otherwise and room sizes are measured between internal wall surfaces, including furnishings.