



North Street, Witheridge, EX16 8AG

A generously sized three bedroom character home located near the heart of this sought-after Mid Devon village.

Winkworth

Winkworth.co.uk

Crediton: 01363 773757
crediton@winkworth.co.uk

Exeter: 01392 271177
exeter@winkworth.co.uk

Tiverton: 01884 675 675
tiverton@winkworth.co.uk



DESCRIPTION:

This beautifully presented three-bedroom home has been renovated to an exceptional standard throughout, offering a perfect combination of modern design, generous proportions, and practical family living. Situated in a desirable residential area, the property provides a turnkey opportunity for buyers seeking high-quality accommodation with stylish interiors and a thoughtful layout.

On the ground floor, is a spacious and light-filled sitting room featuring multiple windows and double doors that open out to the garden, creating a seamless indoor-outdoor flow—ideal for relaxing or entertaining. The elegant dining room leads through to a contemporary kitchen, finished with sleek cabinetry, premium worktops, and integrated appliances. A utility area and a modern cloakroom add convenience, while internal access to the large integral garage provides ample storage or parking space.

Upstairs, the first floor hosts three generously sized bedrooms. The principal bedroom is bright and well-proportioned, while Bedrooms 2 and 3 offer flexible accommodation, perfect for children, guests, or a home office. The family bathroom is modern and stylish, fitted with quality fixtures and a clean, contemporary finish.

OUTSIDE:

One of the standout features of this home is the fantastically well-maintained rear garden, thoughtfully designed for both relaxation and entertaining. A spacious patio area provides the perfect setting for outdoor dining and summer gatherings, complete with a built-in BBQ area. At the top of the garden sits a charming summer house, ideal for use as a home office, studio, or quiet retreat. A well-kept lawn offers space for children to play or to simply enjoy the outdoors in comfort and privacy.

Located in a quiet and well-connected area, the property offers easy access to local amenities, schools, transport links, and green spaces, making it ideal for families, professionals, or those looking to enjoy modern living in a beautifully finished home.

Council Tax: Band C- Mid Devon

Services: Mains electricity, water and drainage. Oil heating.

Broadband: Super-Fast Broadband Available Within This Postcode. Fibre to the Cabinet.

Mobile Signal: You are likely to get good coverage.

Tenure: Freehold

Directions:-

Using the what3words app, search:-



AT A GLANCE:

Three Bedrooms

Bathroom

Two Large Reception Rooms

Kitchen/Breakfast Room

Downstairs Shower Room

Pretty Garden

Garage

PROPERTY INFORMATION:

To be advised

Council tax Band: C

Mains electric, gas, water and drainage.



Ground

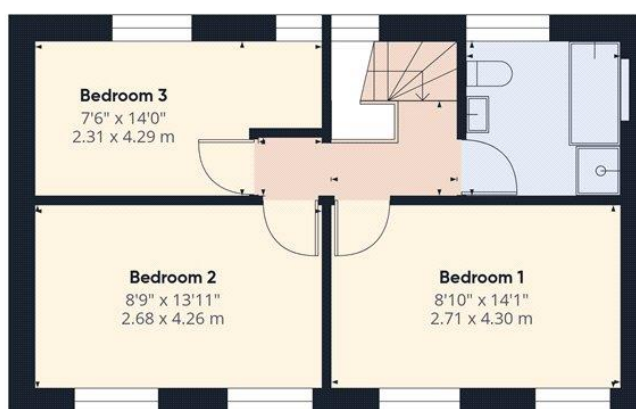

Floor 1

Score	Energy rating	Current	Potential
92+	A		
81-91	B		81 B
69-80	C		
55-68	D		
39-54	E		
21-38	F	38 F	
1-20	G		

NOTICE: Whilst every effort has been made to ensure the accuracy of these sales details, they are for guidance purposes only and prospective purchasers are advised to seek their own professional advice as well as to satisfy themselves by inspection or otherwise as to their correctness. No representation or warranty whatsoever is made in relation to this property by Winkworth or its employees nor do such sales details form part of any offer or contract.

Winkworth

Crediton: 01363 773757
crediton@winkworth.co.uk

Exeter: 01392 271177
exeter@winkworth.co.uk

Tiverton: 01884 675 675
tiverton@winkworth.co.uk