



Churchill Place

Basingstoke RG21 7AA

Description

This fourth floor brand new apartment has an allocated underground parking space and is offered unfurnished.

It is located just a short stroll from the Festival Place shopping centre and Basingstoke's mainline railway station (45 minutes to London Waterloo).

It has a spacious kitchen/diner with a large window giving lots of natural light. The kitchen has high gloss finish units with stone composite worksurfaces and integrated appliances including an oven and hob, washer/drier, dishwasher and fridge/freezer.

The bedroom is a good size 'double' with a built-in wardrobe and the stunning bathroom has a bath with a shower and screen over, complemented by stylish wall and floor tiling.

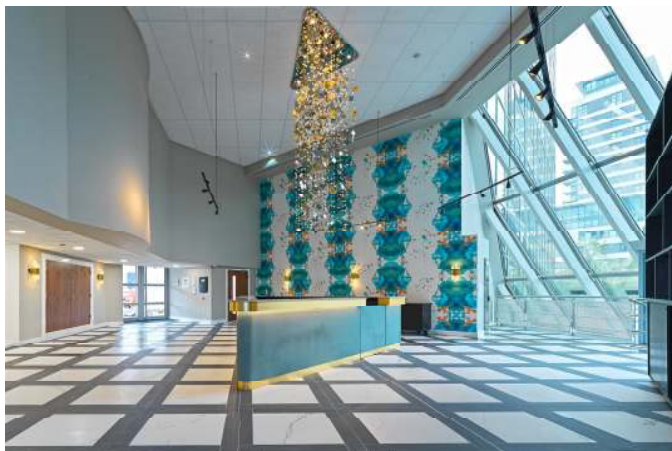

Winkworth

Accommodation

Brand new apartment
 Prime town centre location
 Kitchen/living room
 Double bedroom
 Luxury bathroom
 Unfurnished
 Allocated parking space

Under the Property Misdescriptions Act 1991, these Particulars are a guide and act as information only. All details are given in good faith and are believed to be correct at time of printing. Winkworth give no representation as to their accuracy and potential purchasers or tenants must satisfy themselves by inspection or otherwise as to their correctness. No employee of Winkworth has authority to make or give any representation or warranty in relation to this property.

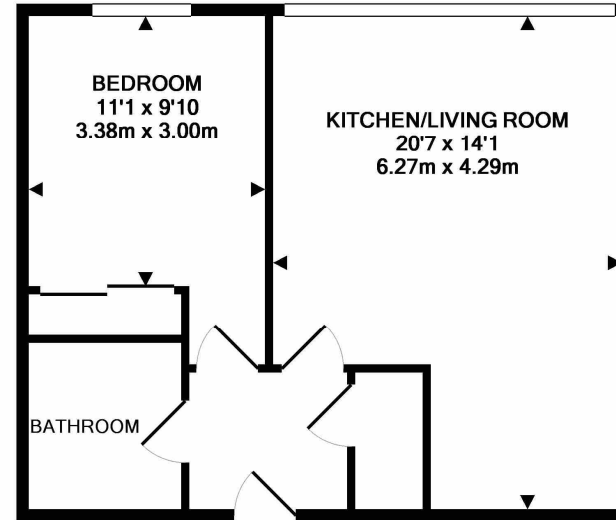

Whilst every attempt has been made to ensure the accuracy of the floor plan contained here, measurements of doors, windows, rooms and any other items are approximate and no responsibility is taken for any error, omission, or mis-statement. This plan is for illustrative purposes only and should be used as such by any prospective purchaser. The services, systems and appliances shown have not been tested and no guarantee as to their operability or efficiency can be given
 Made with Metropix ©2019

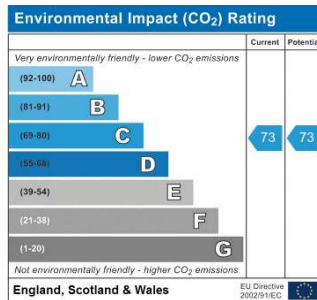
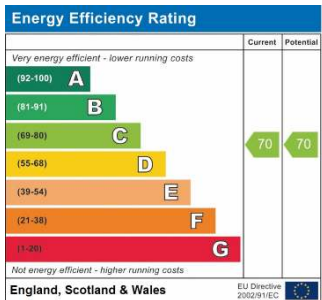

Basingstoke Office

10B Church Street, Basingstoke, Hampshire, RG21 7QE
 01256 811730 | basingstoke@winkworth.co.uk

winkworth.co.uk/Basingstoke



See things differently.