



Winkworth

The Drive, Finchley, London, N3

£500,000 *Share of Freehold*

2  1  2 

Winkworth is delighted to offer this well presented, two double bedrooms two-bathroom, first floor apartment, ideally located for local schools, transport links, such as West Finchley underground, North Finchley & Finchley Central High Road amenities, lovely greenbelt walks along Dollis Brook and catchment for good schools. The property is comprised of an open plan fully fitted kitchen/ living room, two double bedrooms, tiled family bathroom, en suite,

KEY FEATURES

- Purpose built block
- First floor
- Open plan living
- Two bedrooms
- Two bathrooms
- Parking
- Share of freehold



Winkworth



Winkworth

Finchley

020 8349 3388 | finchley@winkworth.co.uk

Winkworth

for every step...



Winkworth

wooden flooring throughout and carpets to bedrooms.

The property is being sold with a share of the freehold and on a chain free basis.

An internal viewing is highly recommended.



Winkworth



Winkworth



Winkworth



MATERIAL INFO

Tenure: Share of Freehold
Term: 994 years
Council Tax Band: D
EPC Rating: B

The Drive, N3
Approx. Gross Internal Floor Area 652 sq. ft / 60.59 sq. m

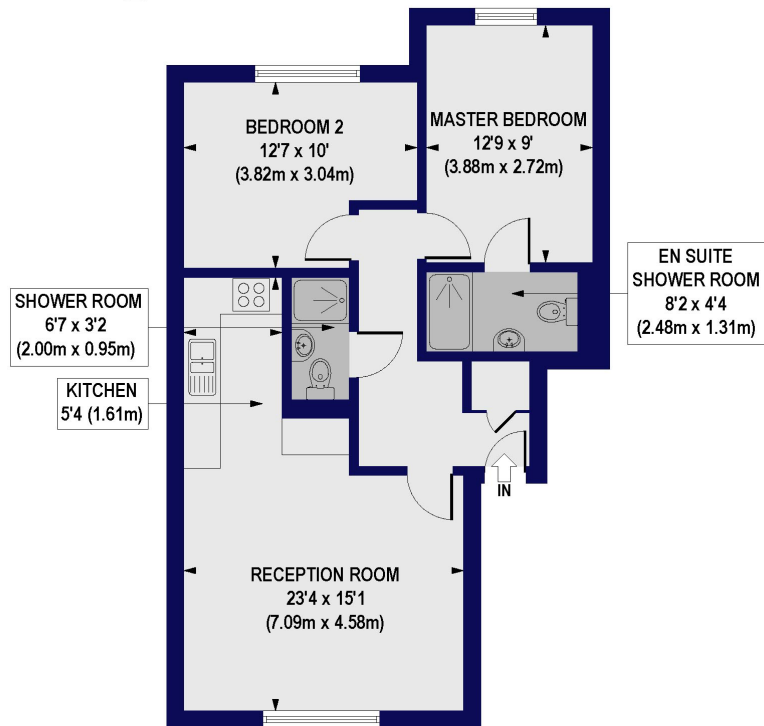

FIRST FLOOR

All measurements of walls, doors, windows, fittings and appliances, including their size and location, are shown as standard sizes and do not constitute any warranty or representation by the seller, their agent or CP Creative. Any intending purchaser must satisfy himself by inspection or otherwise as to the correctness of the information contained in these plans. This plan is for illustrative purposes only and should be used as such by any prospective purchasers.

Winkworth

Score	Energy rating	Current	Potential
92+	A		
81-91	B	85 B	85 B
69-80	C		
55-68	D		
39-54	E		
21-38	F		
1-20	G		

For more information, scan the QR code or visit the link below



<https://www.winkworth.co.uk/sale/property/FIN210001>

Where no figures are shown, we have been unable to ascertain the information. All figures that are shown were correct at the time of printing.

Finchley

020 8349 3388 | finchley@winkworth.co.uk

Winkworth

for every step...

Winkworth wishes to inform prospective buyers and tenants that these particulars are a guide and act as information only. All our details are given in good faith and believed to be correct at the time of printing but they don't form part of an offer or contract. No Winkworth employee has authority to make or give any representation or warranty in relation to this property. All fixtures and fittings, whether fitted or not are deemed removable by the vendor unless stated otherwise and room sizes are measured between internal wall surfaces, including furnishings.