



Dukes Avenue, Barnet, London, N3

£575,000 *Share of Freehold*

2 1 2

Set on a sought-after residential street, this charming extended ground floor garden flat offers an ideal blend of contemporary living and period features. Located on Dukes Avenue, the property provides a peaceful retreat while still being within easy reach of the local amenities, transport links, and green space of Victoria Park. The property benefits further from having an en-suite to the master bedroom, and is being offered on a chain free basis.

KEY FEATURES

- Two Bedrooms
- Ensuite to master bedroom
- Garden
- Gas central heating
- Chain free
- Double glazing



Finchley

020 8349 3388 | finchley@winkworth.co.uk

Winkworth

for every step...



Further features include: an extra room off bedroom two, which can be used as either a study, guest bedroom or dressing room. A modern terrace to the front of the house, a cosy, multi-fuel stove in the living room, and a useful shed for storage.

An internal viewing is highly recommended!





MATERIAL INFO

Tenure: Share of Freehold
Council Tax Band: C
EPC rating: D

Dukes Avenue N3
Approx. Gross Internal Floor Area 66.32 sq. m / 713 sq. ft

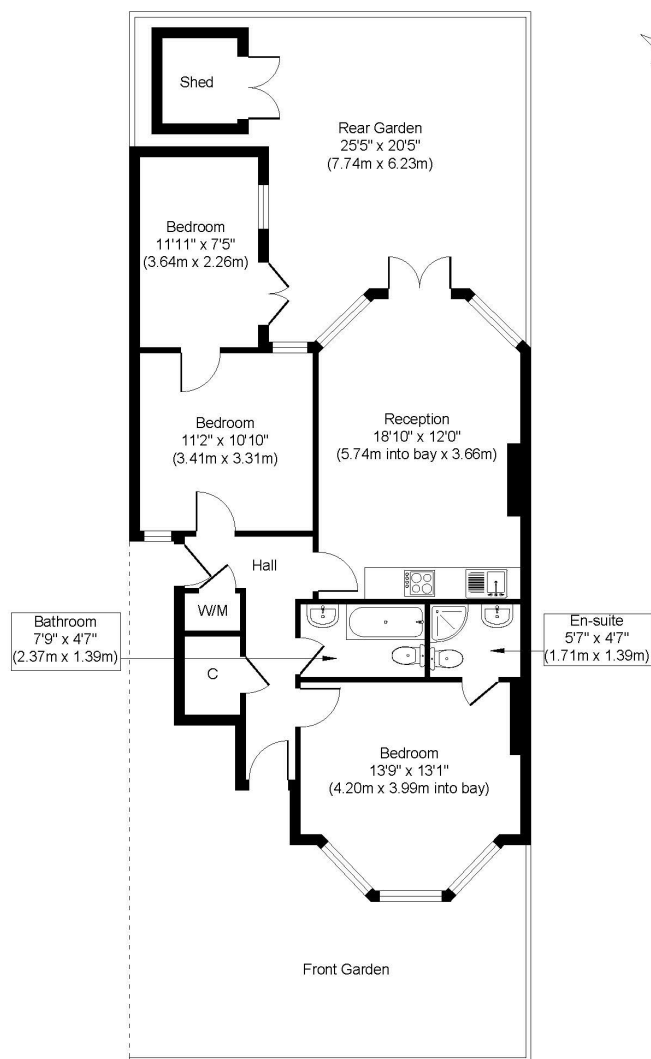

For identification purposes only
 Measurements are not to scale and are approximate only.

Score	Energy rating	Current	Potential
92+	A		
81-91	B		
69-80	C		72 C
55-68	D	56 D	
39-54	E		
21-38	F		
1-20	G		

For more information, scan the QR code or visit the link below



<https://www.winkworth.co.uk/sale/property/CLS251959>

Where no figures are shown, we have been unable to ascertain the information. All figures that are shown were correct at the time of printing.

Finchley

020 8349 3388 | finchley@winkworth.co.uk

Winkworth

for every step...

Winkworth wishes to inform prospective buyers and tenants that these particulars are a guide and act as information only. All our details are given in good faith and believed to be correct at the time of printing but they don't form part of an offer or contract. No Winkworth employee has authority to make or give any representation or warranty in relation to this property. All fixtures and fittings, whether fitted or not are deemed removable by the vendor unless stated otherwise and room sizes are measured between internal wall surfaces, including furnishings.