



MAYGOOD HOUSE, MAYGOOD STREET, LONDON, N1
£450,000 LEASEHOLD

A SUPERB TWO BEDROOM FLAT SET OVER
THE FOURTH FLOOR OF THIS BLOCK NEXT TO
REGENTS CANAL.

Islington | 0207 354 2480 | islington@winkworth.co.uk

Winkworth

winkworth.co.uk

See things differently



DESCRIPTION:

This wonderful two bedroom apartment is set on the fourth floor of Maygood House, a charming early 1900's private purpose built development, located moments from Angel & Regents Canal. The flat benefits from well-proportioned rooms and is flooded with natural light throughout. Accommodation includes two double bedrooms, a bathroom, a reception room and well-equipped kitchen with ample worktop space. The property further benefits from being offered to the market chain free.

Maygood House is perfectly situated for an array of fantastic transport links as well as being just moments from the restaurants, bars and shops located on Upper Street. The exciting new development at Granary Square, famous for its' stunning architecture alongside high end shops, restaurants and waterside location is easily reached via Regents Canal. A superb selection of transport links are at hand with an array of bus routes providing effortless access across London whilst Angel and Kings Cross offer a selection of underground and overground links as well as international travel from St Pancras.

Winkworth



Winkworth

Maygood House, Maygood Street, N1
 Approx. Gross Internal Floor Area 506 sq. ft / 47.05 sq. m

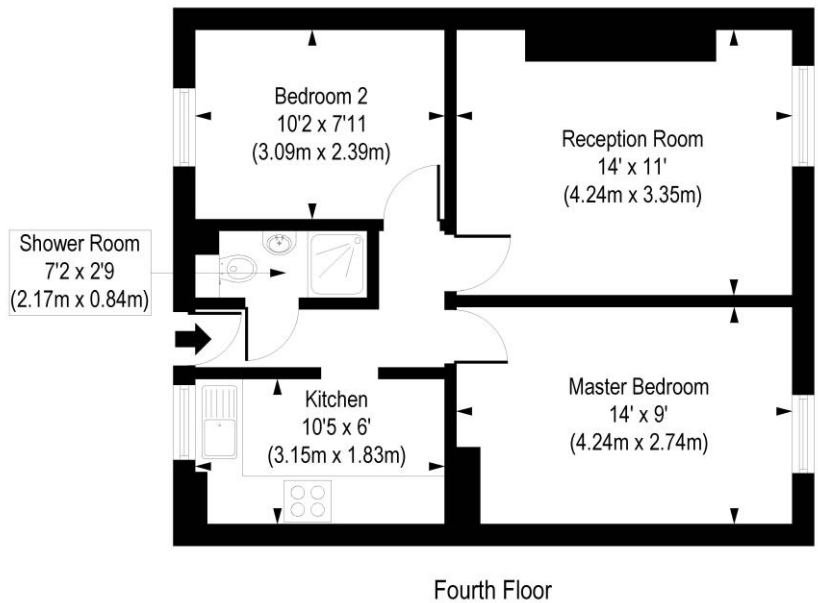
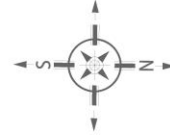

COMPLIANT WITH RICS CODE OF MEASURING PRACTICE. Floorplan is for illustrative purposes only and is not to scale. Every attempt has been made to ensure the accuracy of the floorplan shown, however all measurements, fixtures, fittings and data shown are an approximate interpretation for illustrative purposes only. Liability for errors, omissions or mis-statement through negligence or otherwise is hereby excluded.

This floorplan is for illustration purposes only and is not to scale. The position and size of doors, windows, appliances and other features are approximate.

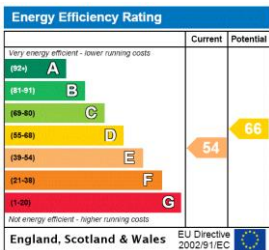

Islington | 0207 354 2480 | islington@winkworth.co.uk



winkworth.co.uk

See things differently

Winkworth wishes to inform prospective buyers and tenants that these particulars are a guide and act as information only. All our details are given in good faith and believed to be correct at the time of printing but they don't form part of an offer or contract. No Winkworth employee has authority to make or give any representation or warranty in relation to this property. All fixtures and fittings, whether fitted or not are deemed removable by the vendor unless stated otherwise and room sizes are measured between internal wall surfaces, including furnishings.