



Campion Way, Kings Worthy, Winchester, Hampshire, SO23 7QP

Winkworth



Campion Way, Kings Worthy, Winchester, Hampshire, SO23 7QP

Charming Two-Bed Bungalow in Peaceful Cul-de-Sac, Offered with No Forward Chain

This delightful end-of-terrace bungalow is well proportioned throughout and situated in a quiet cul-de-sac location in the popular village of Kings Worthy. It is close to Kings Worthy Primary School and Eversley Park - a fantastic local park with a recreation ground, sports facilities, newly renovated children's playground, and a social club.

The front door leads into a useful inner porchway which in turn gives access to the spacious sitting room. This sizeable reception space is lovely and bright courtesy of large windows overlooking the front garden. The smart kitchen is fitted with base and eye-level units providing plenty of storage with space for appliances such as oven, washing machine and fridge/freezer. There is a small bar-style seating area and a handy larder cupboard providing extra storage space.

The main bedroom is a good size and lies to the rear of the bungalow with views over the garden and built-in wardrobes. Alongside is a further bedroom which also benefits from garden views and a door leading directly out to the patio and garden beyond. A shower room with large walk-in shower completes the internal accommodation.

Outside, the open-plan front garden is laid to lawn with a gravel path leading to the front door. A gate provides side access to the enclosed rear garden which is a real delight. A patio directly behind the bungalow creates a perfect seating area to admire the wonderful views across Kings Worthy. The remainder is mainly laid to lawn bordered by mature shrubs and there is useful access to the garage from the rear of the garden.



Campion Way, Kings Worthy, Winchester, Hampshire, SO23 7QP

Directions

Leaving Winchester on the Worthy Road, continue onto the London Road. Before the T-Junction with the A33, turn left into Church Lane, then take the fourth right into Campion Way where the property can be found towards the end on the left, on the corner of Field End and Campion Way.

Location

Campion Way is in the heart of the village of Kings Worthy and a short distance from Kings Worthy Primary School. Locally there are two public houses, a Tesco Express, post office and Cobbs farm shop with café. Kings Worthy is an excellent location for access to the A34, A33 and M3 motorway. The City of Winchester is a short distance away, with its mainline railway station (links to London Waterloo in about 60 minutes), High Street shops, boutiques, library, coffee shops, public houses, restaurants, theatre, cinema, museums and, of course, the city's historic cathedral. There are regular buses from the end of the road taking you directly into the city centre.

Tenure: Freehold

Services

Mains gas, electricity, water and drainage

Winchester City Council

Council tax band: C

EPC rating: E

Viewings

Strictly by appointment with Winkworth Winchester Office

Winkworth.co.uk/winchester

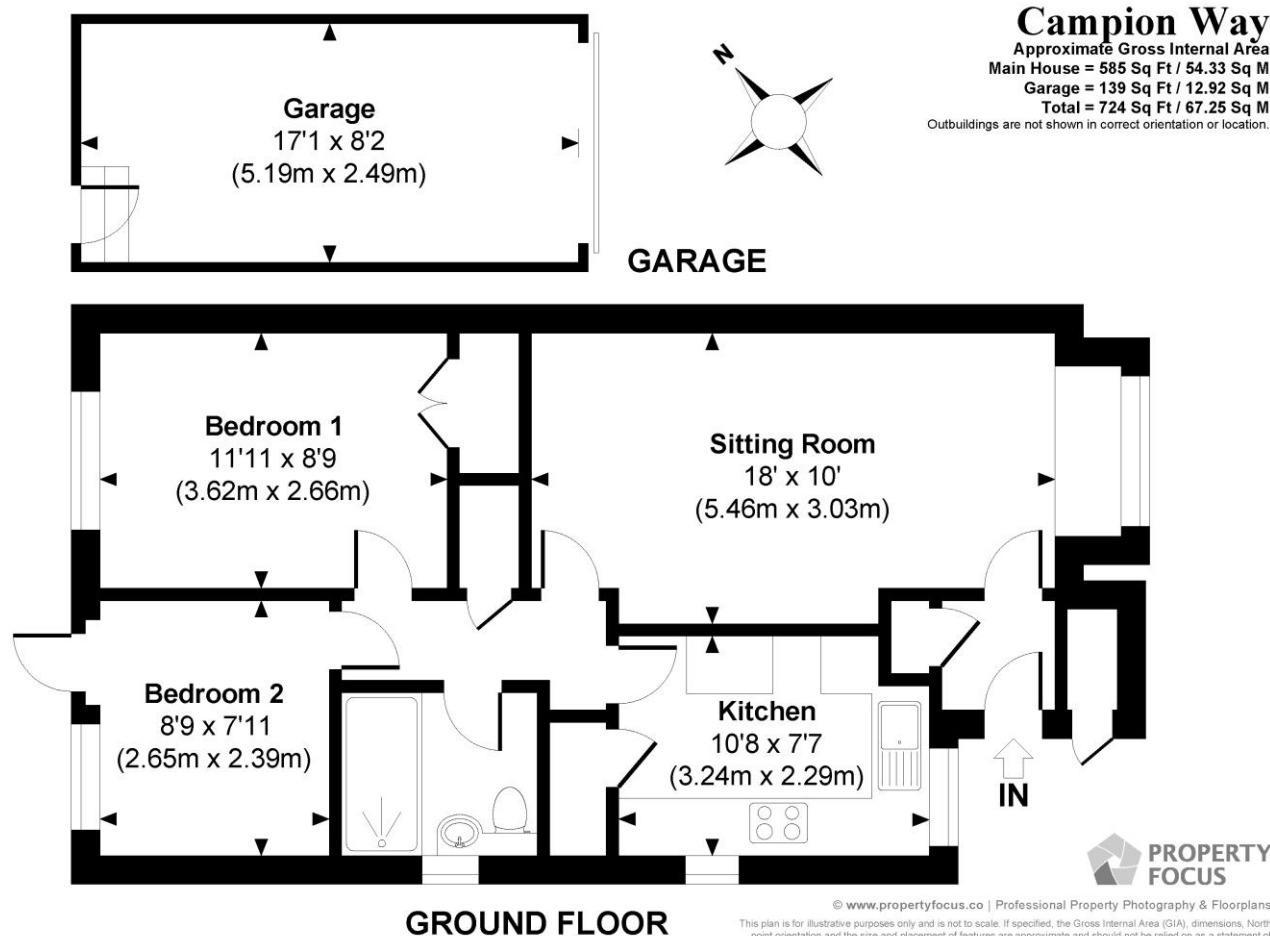

Winkworth Winchester

2 Black Swan Buildings, Southgate Street, Winchester, SO23 9DT
01962 866 777 | winchester@winkworth.co.uk

Winkworth Country House Department

13 Charles II Street, St James's, London, SW1Y 4QU
020 7870 4878 | countryhouse@winkworth.co.uk

Winkworth

See things differently