



## The Hedgerows, Fleet, Hampshire, GU51 5EP

£2,000 per month *Unfurnished*

3  2  2 

This well presented three bedroom semi detached family home benefits from three double bedrooms, one en-suite, kitchen, living room, downstairs W/C, family bathroom and private garden. The property has two allocated parking spots and is offered unfurnished. Situated in the quiet village of Crookham, this would be ideal for a family or professional couple. Available 18th October 2025.

### KEY FEATURES

- Three bedrooms
- Semi detached
- New build
- Unfurnished
- Council tax band: D
- Available: 18th October



Reading

0118 4022 300 | [reading@winkworth.co.uk](mailto:reading@winkworth.co.uk)

**Winkworth**

for every step...



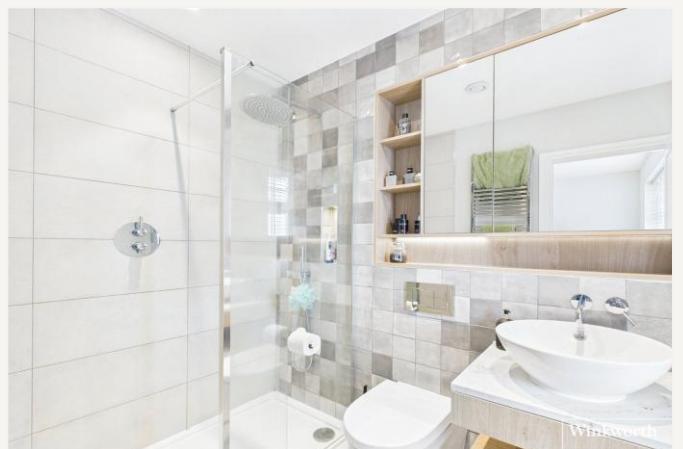





## MATERIAL INFO

**Deposit:** £2,307.69

**Holding Deposit:** £461.53

**Council Tax Band:** D

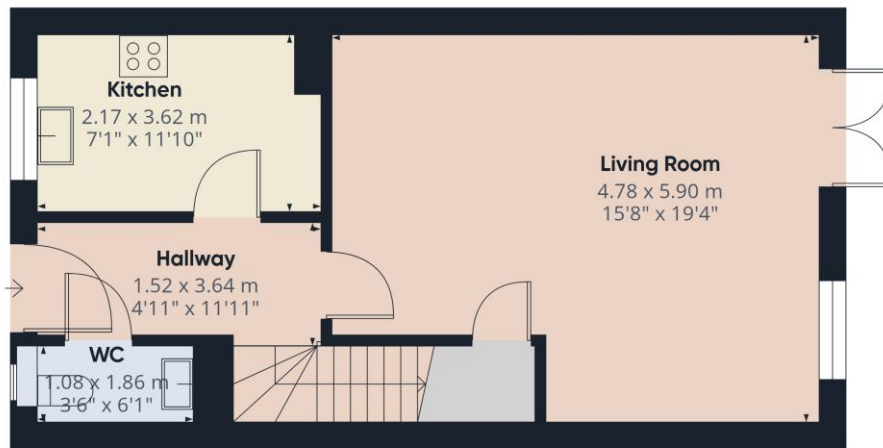

Ground Floor

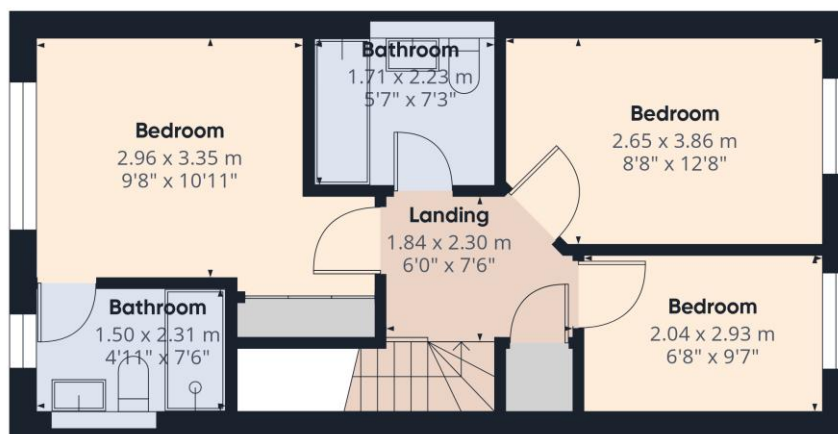

Floor 1

**Winkworth**

**Approximate total area<sup>(1)</sup>**  
85 m<sup>2</sup>  
918 ft<sup>2</sup>

(1) Excluding balconies and terraces

Calculations reference the RICS IPMS 3C standard. Measurements are approximate and not to scale. This floor plan is intended for illustration only.

GIRAFFE360

Score	Energy rating	Current	Potential
92+	A		95 A
81-91	B	84 B	
69-80	C		
55-68	D		
39-54	E		
21-38	F		
1-20	G		

For more information, scan the QR code or visit the link below

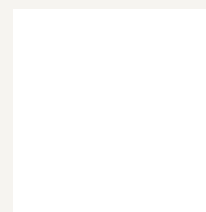

<https://www.winkworth.co.uk/rent/property/REA250822>

Where no figures are shown, we have been unable to ascertain the information. All figures that are shown were correct at the time of printing.

**Reading**

0118 4022 300 | [reading@winkworth.co.uk](mailto:reading@winkworth.co.uk)

**Winkworth**

for every step...

Winkworth wishes to inform prospective buyers and tenants that these particulars are a guide and act as information only. All our details are given in good faith and believed to be correct at the time of printing but they don't form part of an offer or contract. No Winkworth employee has authority to make or give any representation or warranty in relation to this property. All fixtures and fittings, whether fitted or not are deemed removable by the vendor unless stated otherwise and room sizes are measured between internal wall surfaces, including furnishings.