



CITY PAVILION, CHILTON STREET, LONDON, E2  
**£1,050,000 SHARE OF FREEHOLD**

## STUNNING 3-BEDROOM APARTMENT IN GATED DEVELOPMENT WITH OFF-STREET PARKING

Shoreditch | 020 7749 7650 | [shoreditch@winkworth.co.uk](mailto:shoreditch@winkworth.co.uk)

**Winkworth**

*[winkworth.co.uk](http://winkworth.co.uk)*

See things differently





## DESCRIPTION:

This beautifully presented 3-bedroom, 2-bathroom apartment offers 1450 sqft of modern living space and is nestled in a highly desirable gated development. With access to iconic landmarks like Spitalfields Market, The Truman Brewery, Brick Lane and Columbia Flower Market, you'll be at the centre of everything Shoreditch has to offer.

Recently repainted throughout, this immaculate home is chain-free and features a seamless blend of contemporary finishes and practical design.

Located on the desirable Chilton Street, this apartment features a spacious, open plan living and kitchen area that is bathed in natural light from large windows, creating a bright and airy ambiance all day long. The effortless transition between the living space and kitchen sets a welcoming tone, ideal for unwinding or entertaining.

The master bedroom features a modern ensuite bathroom and ample built-in storage, while the two additional double bedrooms, also with built-in storage, share a three-piece family bathroom. This apartment further benefits from off-street parking and a share of the freehold.

Located just moments from Shoreditch's vibrant cultural scene, featuring trendy cafes, bars, restaurants, and boutique shops, this apartment is also well-connected with excellent transport links nearby. Shoreditch High Street Station is just 0.3 miles away, while Liverpool Street (0.8 miles), Whitechapel (0.8 miles), and Old Street (1.0 mile) Stations offer easy access to the City and Canary Wharf.

**Winkworth**



Winkworth



**Chilton Street, E2**  
**Approx. Gross Internal Floor Area 1467 sq. ft / 136.26 sq. m**

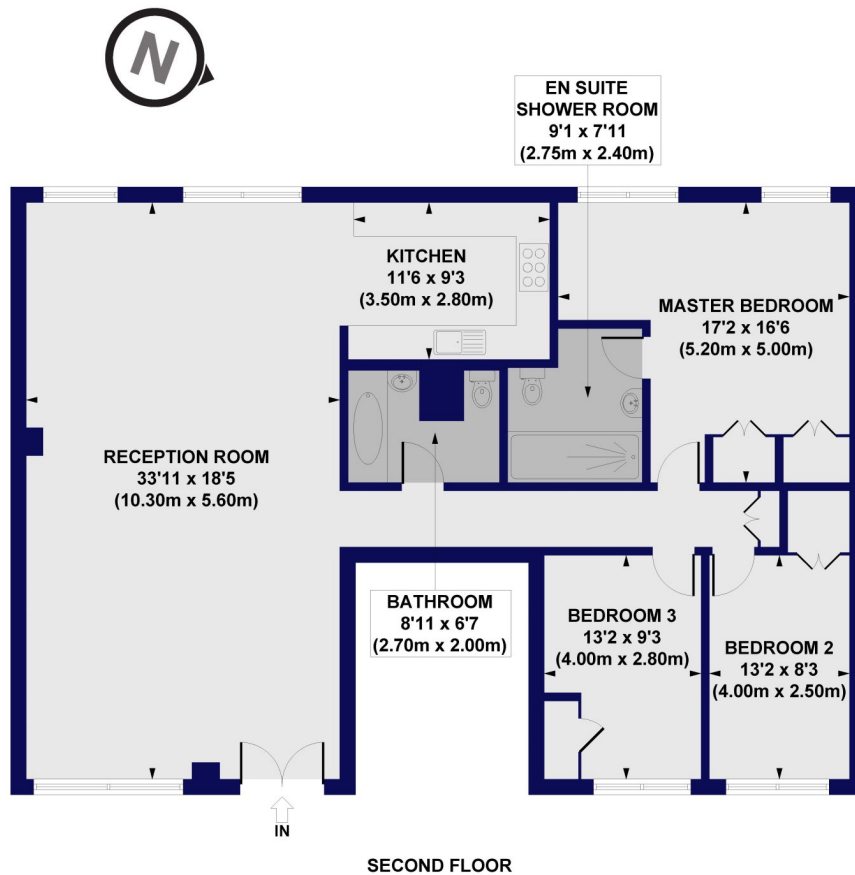

All measurements of walls, doors, windows, fittings and appliances, including their size and location, are shown as standard sizes and do not constitute any warranty or representation by the seller, their agent or CP Creative. Any intending purchaser must satisfy himself by inspection or otherwise as to the correctness of the information contained in these plans. This plan is for illustrative purposes only and should be used as such by any prospective purchasers.

**Winkworth**

This floorplan is for illustration purposes only and is not to scale. The position and size of doors, windows, appliances and other features are approximate.

Energy Efficiency Rating		
	Current	Potential
Very energy efficient - lower running costs		
(92-100) <b>A</b>		
(81-91) <b>B</b>	85	85
(69-80) <b>C</b>		
(55-68) <b>D</b>		
(39-54) <b>E</b>		
(21-38) <b>F</b>		
(1-20) <b>G</b>		
Not energy efficient - higher running costs		
England, Scotland & Wales EU Directive 2002/91/EC		

Shoreditch | 020 7749 7650 | shoreditch@winkworth.co.uk

**Winkworth**

*winkworth.co.uk*

See things differently

Winkworth wishes to inform prospective buyers and tenants that these particulars are a guide and act as information only. All our details are given in good faith and believed to be correct at the time of printing but they don't form part of an offer or contract. No Winkworth employee has authority to make or give any representation or warranty in relation to this property. All fixtures and fittings, whether fitted or not are deemed removable by the vendor unless stated otherwise and room sizes are measured between internal wall surfaces, including furnishings.