



IVYDALE ROAD, NUNHEAD, LONDON, SE15
£1,200,000 FREEHOLD

**A TRULY STUNNING FIVE DOUBLE-BEDROOM
VICTORIAN HOME IN ONE OF NUNHEAD'S
MOST SOUGHT AFTER LOCATIONS.**

Dulwich | 020 8299 2722 | dulwich@winkworth.co.uk

Tenure Freehold | Council Tax Band D – London Borough of Southwark |

Winkworth

winkworth.co.uk

See things differently



DESCRIPTION:

A truly stunning five double-bedroom Victorian home in one of Nunhead's most sought after locations. The property comprises on the ground floor a large double reception with high ceilings; original wood floors and period features and original fireplaces; a picture perfect eat in Kitchen-diner with a feature bay window and a downstairs cloakroom. Through the bi-fold doors in the eat-in kitchen-diner is a large east-facing sunny garden, boasting a large raised patio, ideal for summer evenings or dry winter nights. The garden benefits from mature trees and raised beds. The first floor comprises three large double bedrooms with a large family bathroom finished to an impeccable standard. The top floor has been extended fully and provides two large double, one of which is en-suite. Located within easy reach of the open green spaces of Peckham Rye Park and local amenities. In addition, access to transport links including Peckham Rye, Honor Oak and Nunhead stations are within easy walking distance with connections to Central London, The City, Canary Wharf and beyond. This is a fantastic family house in a superb location with early viewing recommended.

AT A GLANCE

- Five Double Bedrooms
- Two Reception Rooms
- Two Bathrooms
- Ground Floor WC/Cloakroom
- Feature Bay Windows
- Victorian Home
- Great Transport Links
- Fantastic Location





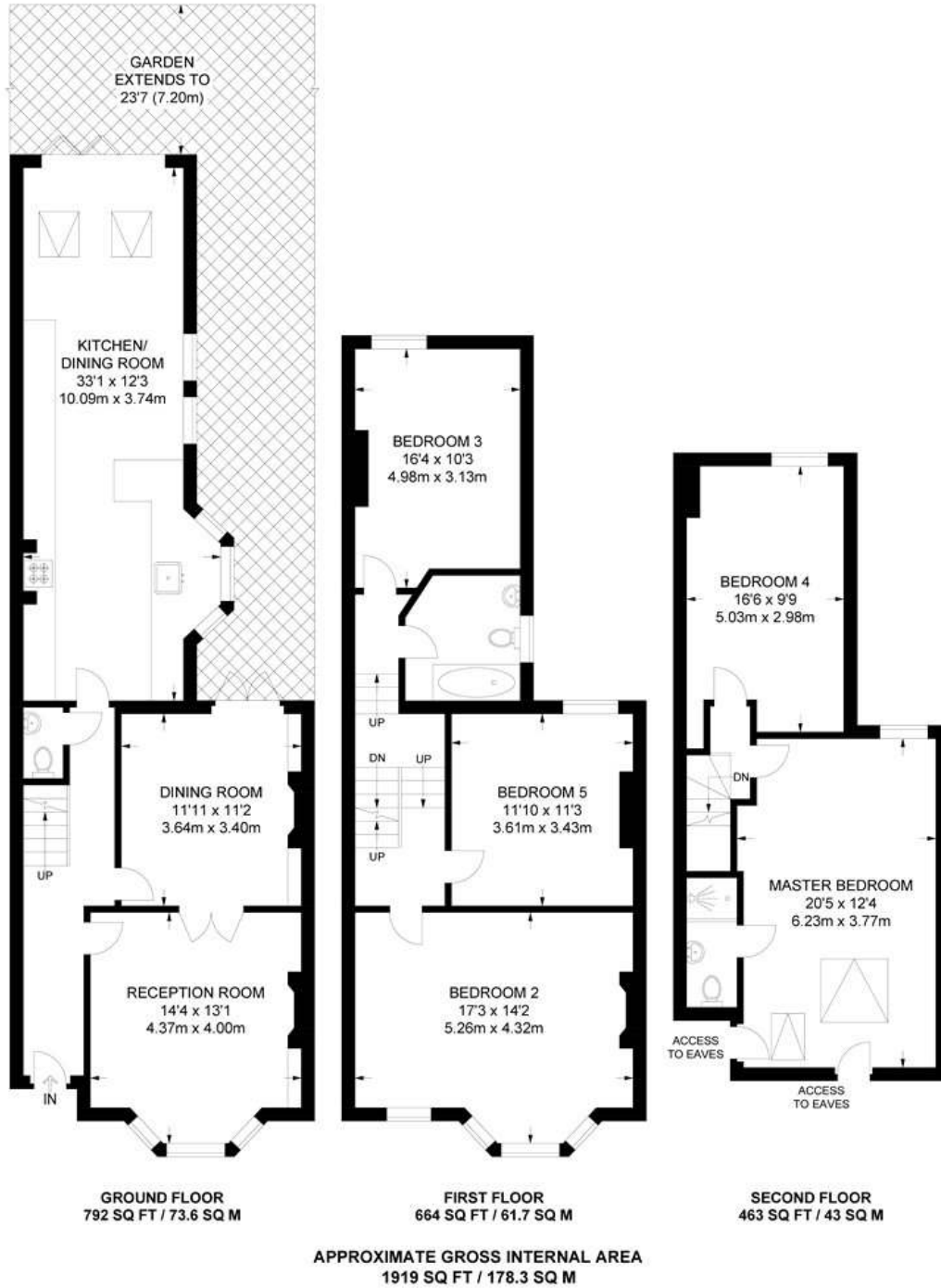

This floorplan is for illustration purposes only and is not to scale. The position and size of doors, windows, appliances and other features are approximate.

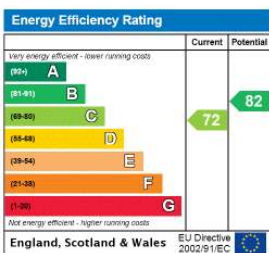

Dulwich | 020 8299 2722 | dulwich@winkworth.co.uk



winkworth.co.uk

See things differently

Winkworth wishes to inform prospective buyers and tenants that these particulars are a guide and act as information only. All our details are given in good faith and believed to be correct at the time of printing but they don't form part of an offer or contract. No Winkworth employee has authority to make or give any representation or warranty in relation to this property. All fixtures and fittings, whether fitted or not are deemed removable by the vendor unless stated otherwise and room sizes are measured between internal wall surfaces, including furnishings.