



**WHISTON HOUSE, BINGHAM COURT, HALTON ROAD, LONDON, N1
OFFERS IN EXCESS OF £425,000 LEASEHOLD**

A BRIGHT SECOND FLOOR FLAT ONLY 0.5 MILES FROM Highbury AND Islington STATION

Islington | 0207 354 2480 | islington@winkworth.co.uk

Winkworth



DESCRIPTION:

Set in a quiet secure development in Canonbury is this charming one bedroom third floor apartment, ideal for anyone looking for a spacious apartment in a prime location. The property offers a wonderfully generous living space bathed in light with a fantastic outlook overlooking a large communal garden. The kitchen is recessed to the side of the living room making it the perfect entertaining space. There is one good sized double bedroom overlooking the courtyard. The property also benefits from a bright three-piece bathroom with shower.

Whiston House is situated in a prime location on a residential street just walking distance to Upper Street and its many boutiques and restaurants, with easy access to both Angel (Northern Line) and Highbury and Islington (Victoria, North London and Northern City Lines) stations. It is also just moments from Essex Road station which takes you straight to into the city.

Winkworth



Winkworth

Whiston House, Bingham Court, Halton Road, N1
Approx. Gross Internal Floor Area 474 sq. ft / 44 sq. m

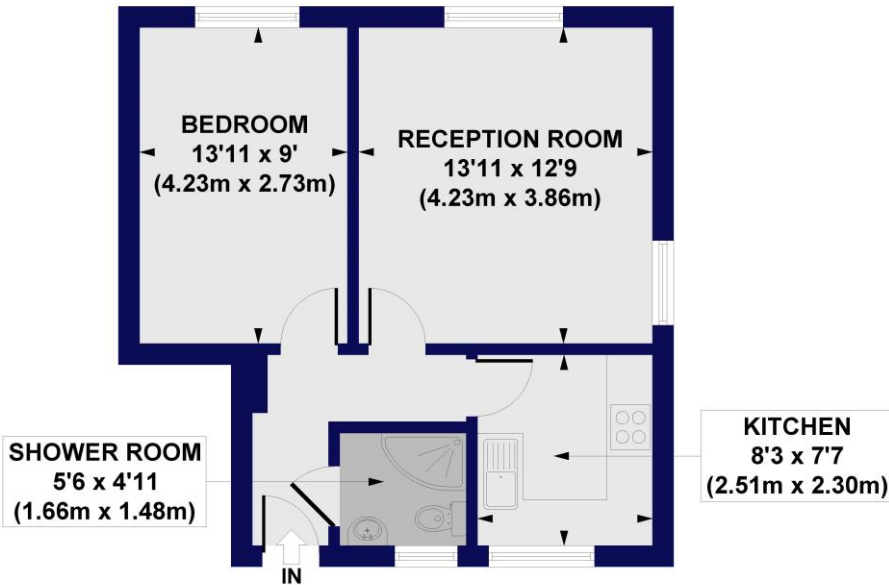

SECOND FLOOR

All measurements of walls, doors, windows, fittings and appliances, including their size and location, are shown as standard sizes and do not constitute any warranty or representation by the seller, their agent or CP Creative. Any intending purchaser must satisfy himself by inspection or otherwise as to the correctness of the information contained in these plans. This plan is for illustrative purposes only and should be used as such by any prospective purchasers.



This floorplan is for illustration purposes only and is not to scale. The position and size of doors, windows, appliances and other features are approximate.

Score	Energy rating	Current	Potential
92+	A		
81-91	B		
69-80	C	70 C	79 C
55-68	D		
39-54	E		
21-38	F		
1-20	G		

Islington | 0207 354 2480 | islington@winkworth.co.uk



winkworth.co.uk

See things differently

Winkworth wishes to inform prospective buyers and tenants that these particulars are a guide and act as information only. All our details are given in good faith and believed to be correct at the time of printing but they don't form part of an offer or contract. No Winkworth employee has authority to make or give any representation or warranty in relation to this property. All fixtures and fittings, whether fitted or not are deemed removable by the vendor unless stated otherwise and room sizes are measured between internal wall surfaces, including furnishings.