



HERBERT GARDENS, NW10
£2,500 PER MONTH FURNISHED

**PRESENTING THIS SUBSTANTIAL GROUND FLOOR,
TWO BEDROOM, GARDEN FLAT TO THE LETTINGS
MARKET.**

Kensal Rise & Queens Park | 0208 960 4947 | kensalrise@winkworth.co.uk

Winkworth

for every step...

winkworth.co.uk



DESCRIPTION:

Available 01/03/25

Presenting this substantial ground floor two bedroom conversion to the lettings market.

Wider than average as this is an end of Terrace, this apartment has an abundance of period features throughout and has been tastefully decorated by the owners.

Comprising of two spacious double bedrooms, good size fully tiled bathroom, a separate kitchen fully fitted with a dishwasher, washing machine, sleek double fridge and microwave.

To the front of the property there is a spacious reception offered with wooden flooring and a feature fireplace.

A spectacular feature of this property is the south facing private garden, with sunk seating and composite decking as well as the added benefit of access through the side ally from the front of the property.

Council tax - (Band D)

Ward - Kensal Green

Furnished – Please speak to the team who can provide a list. with the below

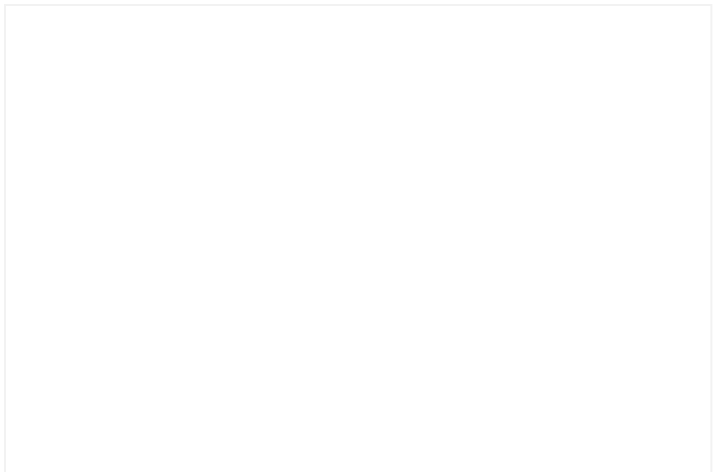
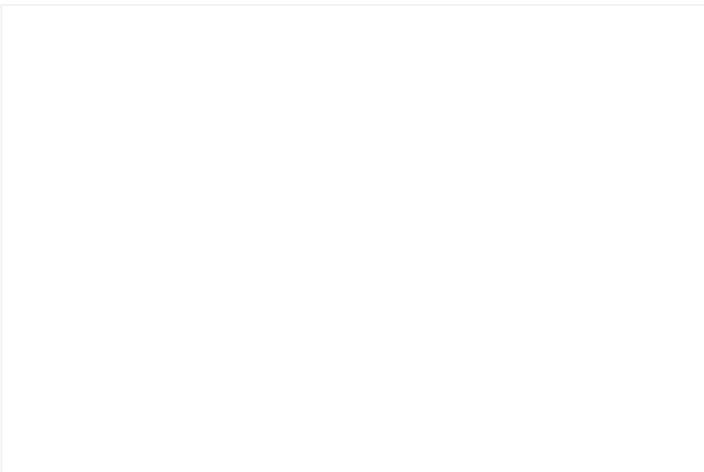

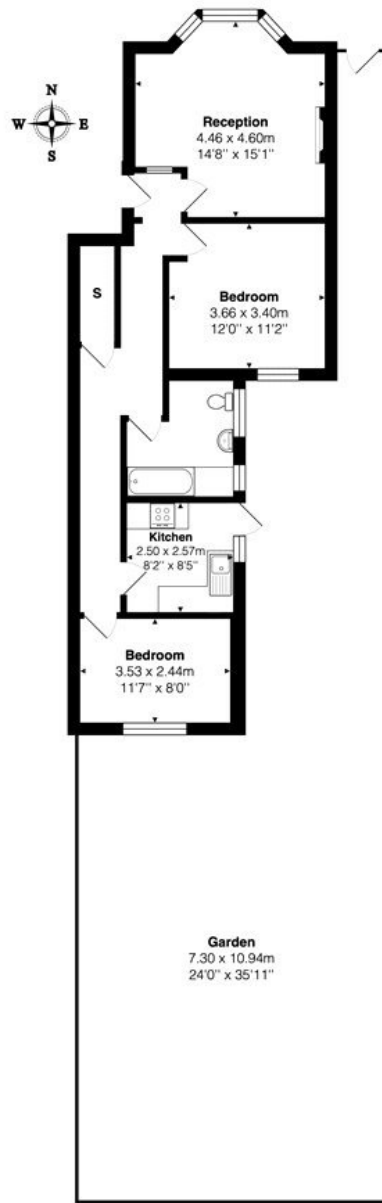

Ground Floor

Total Area: 68.3 m² ... 735 ft² (excluding garden)

All measurements are approximate and for display purposes only

This floorplan is for illustration purposes only and is not to scale. The position and size of doors, windows, appliances and other features are approximate.

Deposit: 5 weeks rent

Holding Deposit: 1 weeks rent

Council Tax Band: D

Where no figures are shown, we have been unable to ascertain the information. All figures that are shown were correct at the time of printing.

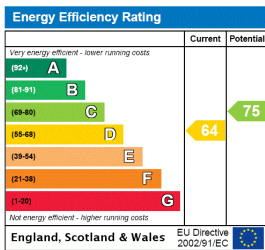

Kensal Rise & Queens Park | 0208 960 4947 | kensalrise@winkworth.co.uk



for every step...

winkworth.co.uk

Winkworth wishes to inform prospective buyers and tenants that these particulars are a guide and act as information only. All our details are given in good faith and believed to be correct at the time of printing but they don't form part of an offer or contract. No Winkworth employee has authority to make or give any representation or warranty in relation to this property. All fixtures and fittings, whether fitted or not are deemed removable by the vendor unless stated otherwise and room sizes are measured between internal wall surfaces, including furnishings.