



Whitley Wood Road, Reading, Berkshire, RG2 8JA

£1,850 per month *Furnished*

3  2  1 

Three bedroom semi detached house located to the South of Reading.

Three bedroom semi detached house located to the South of Reading with good links to local schools and M4 motorway. The property consists of two very good size reception rooms, modern kitchen with appliances, cloakroom and upstairs there are three double bedrooms, three piece bathroom and an additional cloakroom. Further benefits include large rear garden, garage and driveway. Furnished. Available 9th February 2026.

KEY FEATURES

- Three double Bedrooms
- Two large reception rooms
- Garage and driveway
- Council tax band E
- Furnished
- Available 9th February 2026



Reading

0118 4022 300 | reading@winkworth.co.uk

Winkworth

for every step...





MATERIAL INFO

Deposit: £2,134.61

Holding Deposit: £426.92

Council Tax Band: E

EPC rating: D



GROUND FLOOR

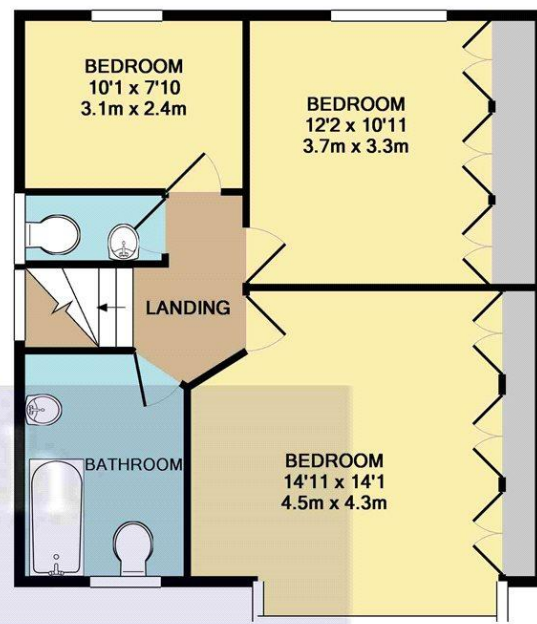

1ST FLOOR

Whilst every attempt has been made to ensure the accuracy of the floor plan contained here, measurements of doors, windows, rooms and any other items are approximate and no responsibility is taken for any error, omission, or mis-statement. This plan is for illustrative purposes only and should be used as such by any prospective purchaser. The services, systems and appliances shown have not been tested and no guarantee as to their operability or efficiency can be given
Made with Metropix ©2017

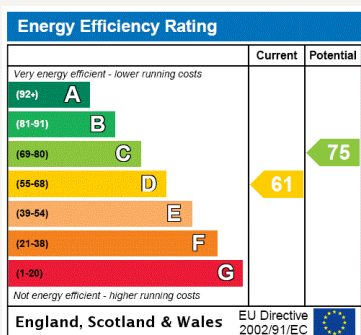

<https://www.winkworth.co.uk/rent/property/REA170148>

Where no figures are shown, we have been unable to ascertain the information. All figures that are shown were correct at the time of printing.

Reading

0118 4022 300 | reading@winkworth.co.uk

Winkworth

for every step...

Winkworth wishes to inform prospective buyers and tenants that these particulars are a guide and act as information only. All our details are given in good faith and believed to be correct at the time of printing but they don't form part of an offer or contract. No Winkworth employee has authority to make or give any representation or warranty in relation to this property. All fixtures and fittings, whether fitted or not are deemed removable by the vendor unless stated otherwise and room sizes are measured between internal wall surfaces, including furnishings.