



Borough Hill, Petersfield, Hampshire, GU32

Guide Price: £1,250 per month

A pretty cottage with off street parking, garden and conveniently located for the train station.

Two Bedrooms, Family Bathroom, Downstairs Shower Room, Sitting Room, Dining Room, Kitchen, Parking and Garden.

EPC Rating: "D" (59).

Winkworth

...for every step

winkworth.co.uk/Petersfield **01730 267274**



DESCRIPTION

A two bedroom older style terraced house of painted rendered elevations under a slate tiled roof. The accommodation is arranged over two floors as denoted on the floor plan but comprises a sitting room with a gas fire in the fireplace and some exposed beams. The kitchen sits in the middle of the house with stairs rising to the first floor and a door to a dining/study area. From here there is a door to a shower room and door to the rear garden. On the first floor there are two bedrooms, one with an en suite bathroom. Outside, to the front of the property is a paved area providing off street parking. To the rear is a small, low maintenance garden with a garden shed, enclosed by wooden fencing. A pedestrian gate provides rear access for bins and bikes etc.



LOCATION

The property is situated in a no through, private road convenient for the train station and town centre. The cottage overlooks playing fields to the front and there are further recreation fields at the end of the road. Petersfield is situated in the heart of The South Downs National Park and offers a variety of amenities in a bustling town centre. Shops include Waitrose, Tesco, M&S Food and there's a further array of boutiques, cafes, restaurants and independent shops. The train station provides a direct service to London Waterloo to the north (in approximately an hour) and Portsmouth to the south. The town has many active clubs and societies with golf available at Petersfield and Liphook, horse and motor racing at Goodwood, Polo at Cowdray Park and sailing along the South coast. There are many excellent schools in the area including Churcher's College, Bedales, Ditcham Park and The Petersfield School.

Ref: MD/180006/1

LOCAL AUTHORITY

East Hampshire District Council, Petersfield

DIRECTIONS

From our office in the High Street head west passing the square on the left hand side. Follow the road round the corner and as the road bends sharply to the right, continue straight on into Swan Street. Proceed to the crossroads and go straight on also into Swan Street. Pass the hospital on the left and as the road bends to the right, turn left into Borough Hill. Continue to the end of this narrow lane then turn right on the unmade private road. The property will be seen half way along on the right hand side.



Approximate Gross Internal Area = 65.2 sq m / 702 sq ft

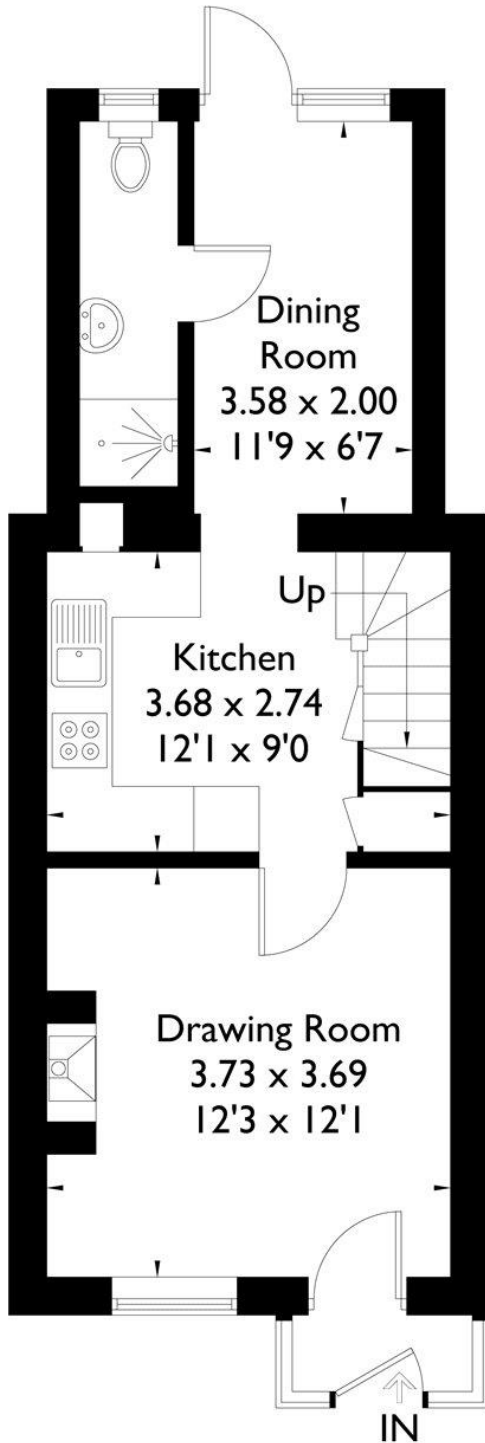

Ground Floor

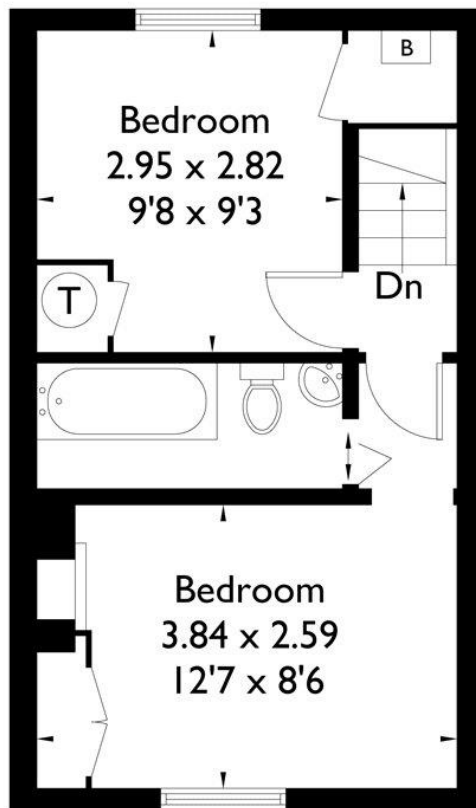

First Floor

FLOORPLANZ © 2018 0203 9056099 Ref: 203213

This plan is for layout guidance only. Drawn in accordance with RICS guidelines. Not drawn to scale unless stated. Windows & door openings are approximate. Whilst every care is taken in the preparation of this plan, please check all dimensions, shapes & compass bearings before making any decisions reliant upon them.

Under the Consumer Protection from Unfair Trading Regulations 2008 (CPR), these Particulars are a guide and act as information only. All details are given in good faith and are believed to be correct at time of printing. Winkworth give no representation as to their accuracy and potential purchasers or tenants must satisfy themselves by inspection or otherwise as to their correctness. No employee of Winkworth has authority to make or give any representation or warranty in relation to this

Petersfield | 01730 267274 | petersfield@winkworth.co.uk