

Saxon Way, Ruskington, Sleaford

*This floorplan is for illustration purposes only and is not to scale. The position and size of doors, windows, appliances and other features are approximate.*

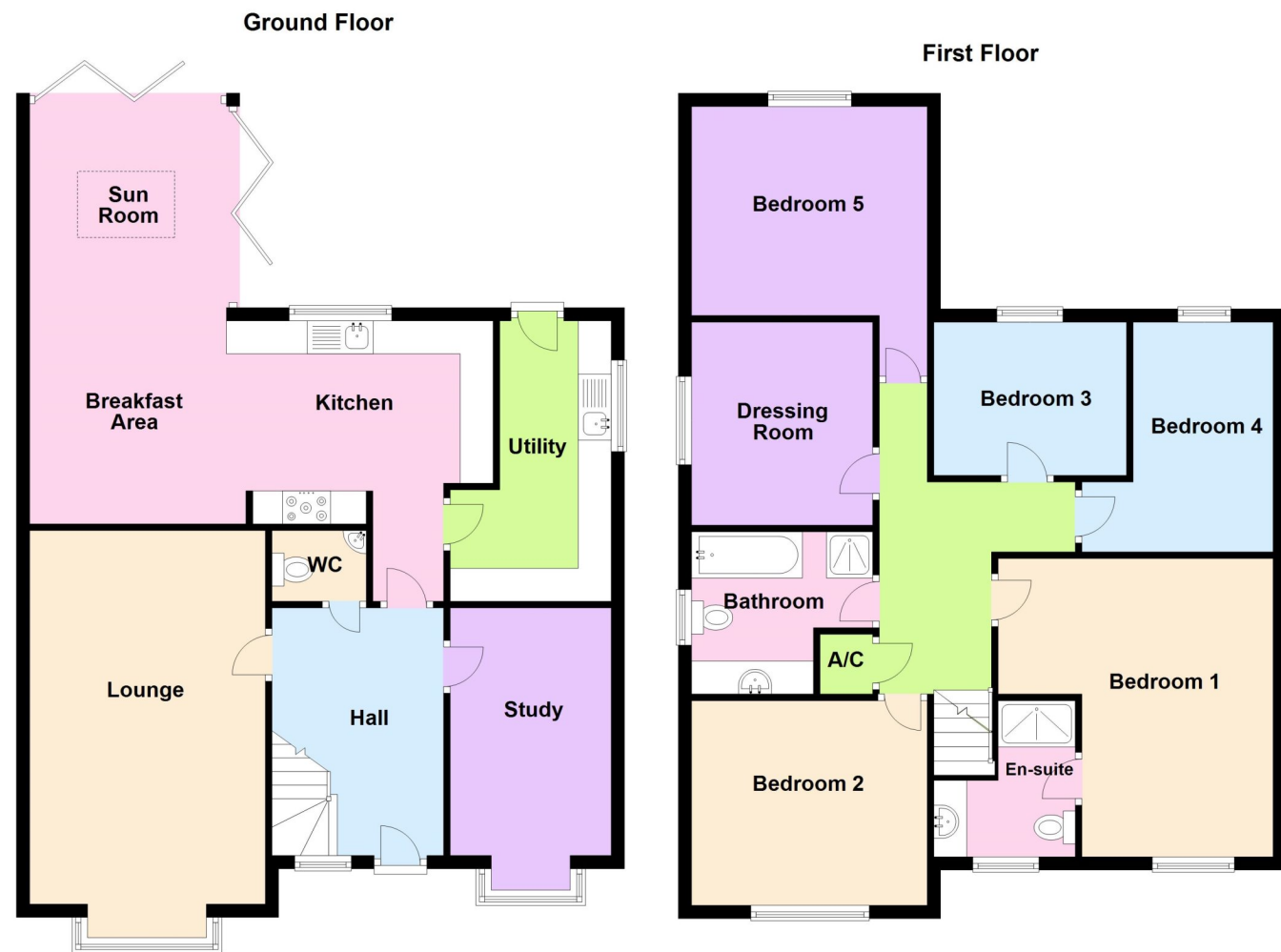

47 Saxon Way, Ruskington, Sleaford, Lincolnshire, NG34 9XG

£495,000 Freehold

**\*\*OPEN HOUSE BY APPOINTMENT ONLY ON SATURDAY 23RD MARCH 2024\*\*** WOW! Winkworth are delighted to present the COMPLETED FIVE BEDROOM DETACHED house on the ever popular Flaxwell Fields development in Ruskington. Built by local renowned builders Chanceoption Homes, this is the first to be completed in BLACK & WHITE. An early viewing is ESSENTIAL. The property benefits from EXTREMELY SPACIOUS accommodation. A large entrance hall with a fantastic sized living room to the left, a study/home office to the right and a downstairs toilet. Going on a particular feature of the property is the simply gorgeous Kitchen Breakfast Area with a stunning HIGH TECH GERMAN KITCHEN leading onto a lovely sun room to the rear with views over open fields. There is also a spacious utility room. Upstairs, there is a great sized landing, with five generously sized bedrooms, an en-suite to the master bedroom and a hugely popular dressing room. The family bathroom has a large shower and bath. Outside, to the rear there is a garden, laid to lawn with views over fields and a Jacuzzi outside power point. There is HEAPS of off road parking with a driveway and garage with an electric car charging point. This will not hang about!!

Winkworth Sleaford | 01529 303377 | sleaford@winkworth.co.uk

winkworth.co.uk/sleaford



See things differently.

Under the Property Misdescriptions Act 1991 these particulars are a guide and act as information only. All details are given in good faith and are believed to be correct at time of printing. Winkworth give no representation as to their accuracy and potential purchasers or tenants must satisfy themselves or otherwise as to their correctness. No employee of Winkworth has authority to make or give any representation or warranty in relation to this property.

OPEN HOUSE BY APPOINTMENT ONLY ON SATURDAY 23RD MARCH 2024 | BRAND NEW EXECUTIVE FIVE BEDROOM DETACHED HOME | ELECTRIC CAR CHARGING POINT AND JACUZZI OUTSIDE POWER POINT | STUNNING NEW BLACK AND WHITE FINISH THROUGHOUT | GORGEOUS KITCHEN | DRESSING ROOM | DRIVEWAY AND GARAGE | VIEWS OVER FIELDS



See things differently.

## ACCOMMODATION

Entrance Hall

Lounge - 18'7" x 11'9" (5.66m x 3.58m)

Study - 12'4" x 8' (3.76m x 2.44m)

Downstairs W.C

Kitchen Breakfast Area - 18'9" x 9'9" (5.72m x 2.97m)

Sun Room

Utility Room - 13'11" x 6'7" (4.24m x 2m)

First Floor Landing

Bedroom One - 14'10" x 9'6" (4.52m x 2.9m)

En-Suite

Bedroom Two - 11'9" x 10'2" (3.58m x 3.1m)

Bedroom Three - 9'7" x 7'7" (2.92m x 2.3m)

Bedroom Four - 11'4" x 9'6" (3.45m x 2.9m)

Bedroom Five - 13'5" x 11' (4.1m x 3.35m)

Dressing Room - 10'1" x 9' (3.07m x 2.74m)

Family Bathroom

Agents Note - Management fees apply of approx £100 a year

