



**CROWDER CLOSE, NORTH FINCHLEY, LONDON, N12
OFFERS IN THE REGION OF £380,000 LEASEHOLD**

**A WELL-PRESENTED TWO BEDROOM TWO BATHROOM
FIRST FLOOR APARTMENT SET IN A GATED
DEVELOPMENT**

Finchley | 020 8349 3388 | finchley@winkworth.co.uk



DESCRIPTION:

STAMP DUTY FREE FOR FIRST TIME BUYERS!

We are pleased to offer this modern two double bedroom first floor purpose built apartment set in a gated development opposite North Finchley Leisure Complex. The property is ideally located for shopping & transport facilities and comprises of two double bedrooms with wardrobes, two tiled bathrooms (one en suite), large living room, separate fully fitted kitchen, carpeted throughout, electric storage heaters and residents' parking via security gates. Offered with a long lease and on a chain free basis.

TENURE:

Leasehold: 136 years
Service Charge: Circa £3000.00 per annum
Ground Rent: £250.00 per annum

COUNCIL TAX:

Band E

AT A GLANCE

- Purpose built development
- Set behind security gates
- Two double bedrooms
- Two Bathrooms (One en suite)
- Spacious living room
- Fitted kitchen
- Parking





Compton court, 1 Crowder Close, Finchley, N12 0AT

First Floor
GROSS INTERNAL FLOOR AREA
APPROX. 71.26 SQ M / 767 SQ FT

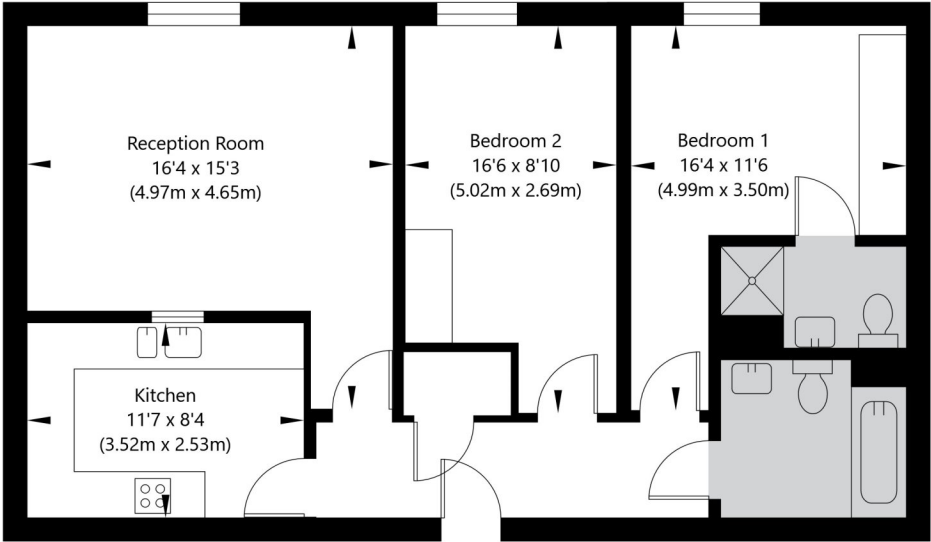

APPROXIMATE GROSS INTERNAL FLOOR AREA 71.26 SQ M / 767 SQ FT
THIS FLOOR PLAN IS FOR ILLUSTRATIVE PURPOSES ONLY AND
SHOULD BE USED FOR THIS PURPOSE BY PROSPECTIVE APPLICANTS AS ITS NOT TO SCALE.

(c) AMBERSHORE PIX LIMITED / PHOTO - VIDEO - FLOOR PLANS / 0800 999 1577 / WWW.AMBERSHOREPIX.CO.UK

