

Homestead Gardens, Thurlby, Bourne

This floorplan is for illustration purposes only and is not to scale. The position and size of doors, windows, appliances and other features are approximate.

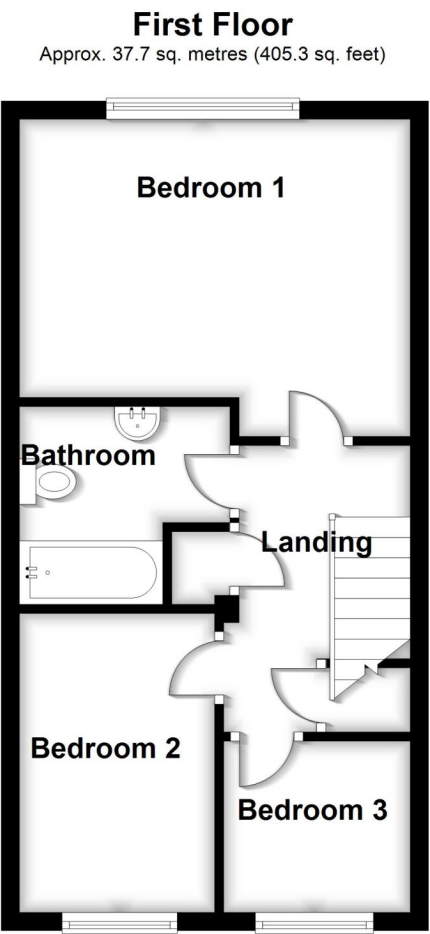

Total area: approx. 75.3 sq. metres (810.6 sq. feet)

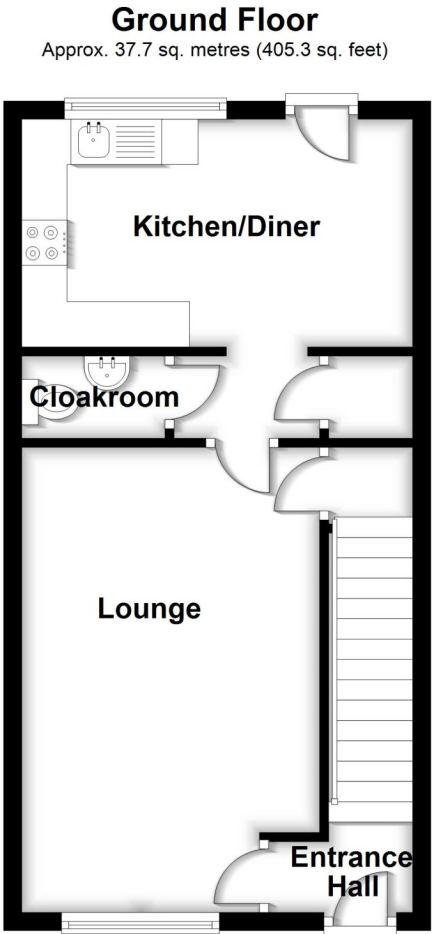
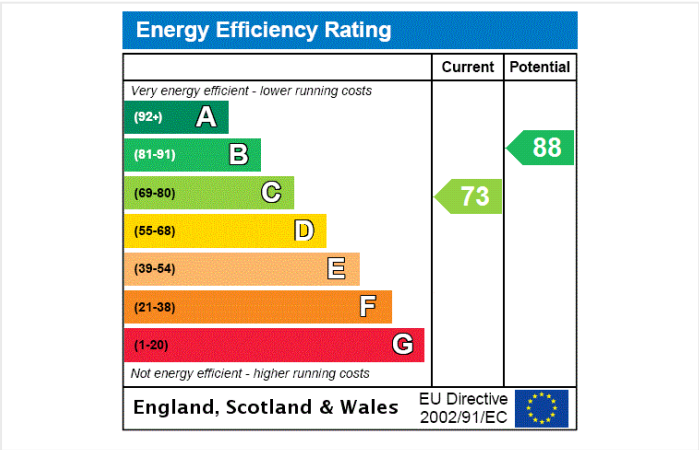

8 Homestead Gardens, Thurlby, PE10 0BE

£195,000 Freehold

A three bedroom terraced home located in the sought after village of Thurlby with views over open fields. The property offer excellent accommodation benefiting from, entrance hall with stairs to the first floor, lounge, kitchen/dining room and downstairs cloakroom. On the first floor there are three bedrooms and newly fitted family bathroom. Outside to the front there is a private driveway providing parking for 2/3 cars and to the rear a fully enclosed lawned garden with views over open fields. Please call 01778 392807 for more information.

Winkworth Bourne | 01778392807 |
bourne@winkworth.co.uk
winkworth.co.uk/bourne

Under the Property Misdescriptions Act 1991, the Particulars are a guide and act as information only. All details are given in good faith and are believed to be correct at time of printing. Winkworth give no representation as to their accuracy and potential purchasers or tenants must satisfy themselves by inspection or otherwise as to their correctness. No employee at Winkworth has authority to make or give any representation or warranty in the relation to this property.



winkworth.co.uk/bourne

See things differently.



ACCOMMODATION

Entrance Hall - With stairs leading to the first floor and door leading to:

Lounge - 16'11" x 10'9" (5.16m x 3.28m) With upvc double glazed window to the front, radiator, power points, under stairs storage cupboard and door leading to:

Inner Hall - With built in storage cupboard providing storage, open to the kitchen and door leading to:

Downstairs Cloakroom - With low level wc, wash hand basin.

Kitchen/Diner - 14'4" x 8'3" (4.37m x 2.51m) With fitted units comprising, sink with cupboard below, good range of wall and base units, space for cooker, space and plumbing for washing machine, space and plumbing for dishwasher, wall mounted gas boiler supplying hot water and central heating, part tiled walls, upvc double glazed window and door onto the rear garden.

First Floor Landing - With built in airing cupboard and door leading to:



Bedroom One - 14'3" x 11'6" (4.34m x 3.5m) With upvc double glazed window overlooking the rear with views, radiator, power points.

Bedroom Two - 10'4" x 7'1" (3.15m x 2.16m) With upvc double glazed window to the front, radiator and power points.

Bedroom Three - 7'6" x 6'5" (2.29m x 1.96m) With upvc double glazed window to the front, radiator and power points.

Bathroom - Newly fitted suite comprising, panelled bath with shower and glass screen, low level wc, wash hand basin and part tiled walls.



Outside - To the front there is a private driveway providing off road parking for two/three cars. The rear garden is a particular feature with paved patio leading onto a fully enclosed lawned garden with fantastic views over open fields. There is also a gate giving access to additional space ideal for wheelie bins, bicycles and garden storage plus rear access.

LOCAL AUTHORITY

South Kesteven District Council

TENURE

Freehold

COUNCIL TAX BAND

B

