



MINTERN CLOSE, LONDON, N13
£265,000 LEASEHOLD

DESCRIPTION:

Chain-Free. An ideal first-time purchase or buy-to-let investment. A spacious one bedroom flat situated on the first floor of a purpose-built block, within easy reach of shopping amenities, open spaces and a regular bus service to Palmers Green BR station and Southgate tube. The property benefits from light and airy living accommodation, which includes a generously sized reception room with ample space for a dining table, a modern fitted kitchen, a tiled bathroom and a double bedroom. Externally you will find communal grounds and unallocated residents parking. Offered for sale with no onward chain and a remaining lease term of just over 988 years.

Palmers Green | 020 8920 9900 | palmersgreen@winkworth.co.uk



for every step...

Mintern Close, Hedge Lane, N13
 Approx. Gross Internal Floor Area 505 sq. ft / 46.96 sq. m

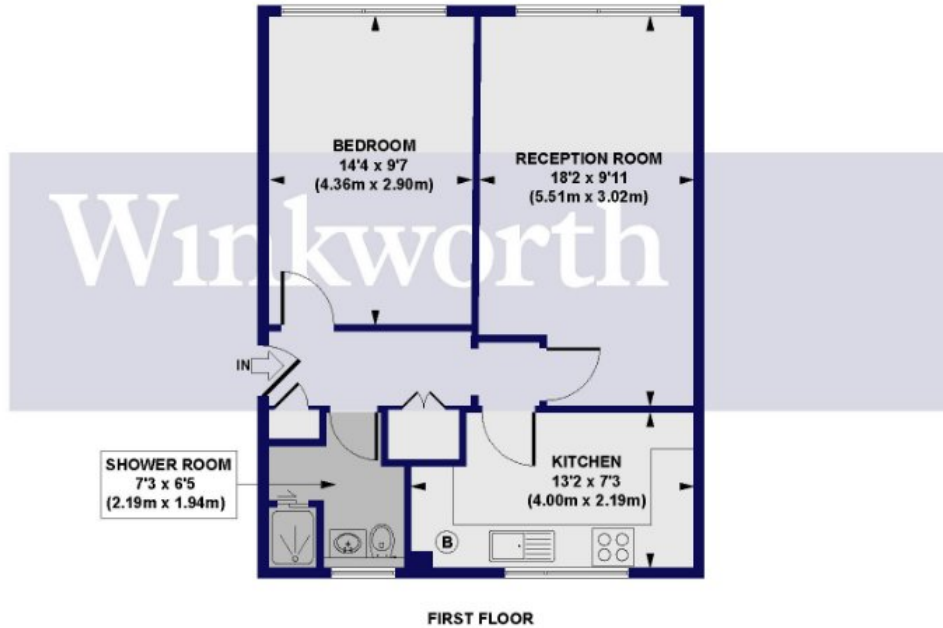

All measurements of walls, doors, windows, fittings and appliances, including their size and location, are shown as standard sizes and do not constitute any warranty or representation by the seller, their agent or CP Creative. Any intending purchaser must satisfy himself by inspection or otherwise as to the correctness of the information contained in these plans.

This floorplan is for illustration purposes only and is not to scale. The position and size of doors, windows, appliances and other features are approximate.

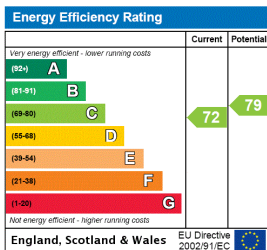

Palmers Green | 020 8920 9900 | palmersgreen@winkworth.co.uk



for every step...

winkworth.co.uk

Winkworth wishes to inform prospective buyers and tenants that these particulars are a guide and act as information only. All our details are given in good faith and believed to be correct at the time of printing but they don't form part of an offer or contract. No Winkworth employee has authority to make or give any representation or warranty in relation to this property. All fixtures and fittings, whether fitted or not are deemed removable by the vendor unless stated otherwise and room sizes are measured between internal wall surfaces, including furnishings.