



15 FAIRVIEW ROAD, WOKINGHAM, BERKSHIRE, RG40 2DN
£875,000 FREEHOLD

**LOCATED IN A DESIRABLE ROAD WITHIN CLOSE
 PROXIMITY OF WOKINGHAM TOWN CENTRE WITH VIEWS
 ACROSS AN OPEN PARK TO THE FRONT.**

Winkworth

Wokingham | 01189 072777 | wokingham@winkworth.co.uk

for every step...

winkworth.co.uk



DESCRIPTION:

Located in a desirable road within close proximity of Wokingham town centre with views across an open park to the front is this stunning four/five bedroom Victorian town house.

The property itself has been lovingly remodelled in recent years and there has been a lot of time and money spent in order to provide a great family home. Typical to its era the property is split over four floors and offers versatile and flexible accommodation. On the lower floor you will find the very stylish kitchen/dining room that leads straight out on to the rear garden, on the ground floor there is the main reception room, bathroom and an additional room currently being utilised as a study which could also be used as a fifth bedroom. The two floors above boast four bedrooms and a further bathroom. Throughout the property there is a wealth of character and charm with open and working fire places, sash windows and original floor boards and features.

Outside there is a useful out building/utility that can be used in a multitude of ways and a private rear garden with decking and seating area.

The front of the property has the park view which is great for dog walking and family fun, Wokingham town centre and station are a 10 minute walk making it incredibly convenient.

AT A GLANCE

- Town centre location
- Overlooking park
- 4 bedrooms
- Stunning kitchen/dining room
- Private garden
- All main services
- Good Mobile phone coverage
- Satellite/Fibre TV available BT & Sky
- Broad band ultra fast available
- Council tax band E Wokingham



Denotes restricted head height

Fairview Road, Wokingham, RG40

Approximate Area = 1575 sq ft / 146.3 sq m

Limited Use Area(s) = 122 sq ft / 11.3 sq m

Outbuilding = 66 sq ft / 6.1 sq m

Total = 1763 sq ft / 163.7 sq m

For identification only - Not to scale

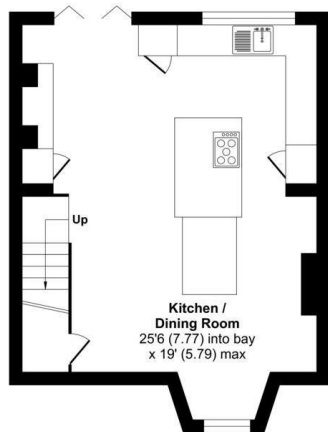
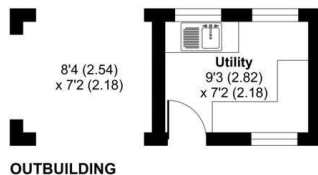

LOWER GROUND FLOOR

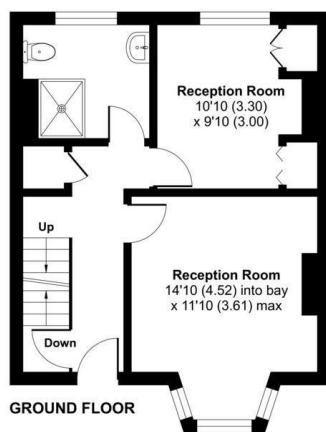

GROUND FLOOR

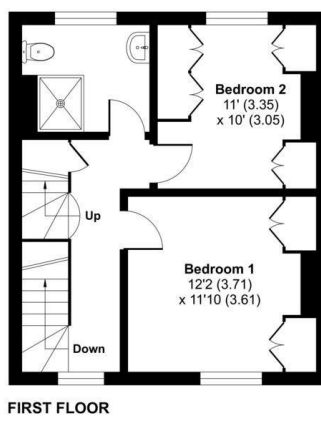

FIRST FLOOR

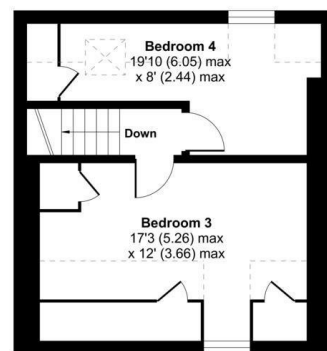

SECOND FLOOR

This floorplan is for illustration purposes only and is not to scale. The position and size of doors, windows, appliances and other features are approximate.

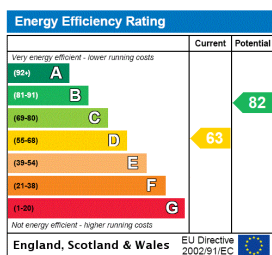

Winkworth

Wokingham | 01189 072777 | wokingham@winkworth.co.uk

winkworth.co.uk

for every step...

Winkworth wishes to inform prospective buyers and tenants that these particulars are a guide and act as information only. All our details are given in good faith and believed to be correct at the time of printing but they don't form part of an offer or contract. No Winkworth employee has authority to make or give any representation or warranty in relation to this property. All fixtures and fittings, whether fitted or not are deemed removable by the vendor unless stated otherwise and room sizes are measured between internal wall surfaces, including furnishings.

We are required by law to conduct anti-money laundering checks on all those buying a property. Whilst we retain responsibility for ensuring checks and any ongoing monitoring are carried out correctly, the initial checks are carried out on our behalf by Landmark who will contact you once you have had an offer accepted on a property you wish to buy. The cost of these checks is £25 per person and this will need to be paid by you in advance of us issuing a memorandum of sale, directly to Landmark, and is non-refundable.