



47A Viney Avenue, Romsey, Hampshire, SO51 7NR

Winkworth



LOVELY FAMILY HOME

Fully refurbished spacious three bedroom detached property in Viney Avenue on the outskirts of Romsey. This sizeable home is on a good sized plot and is ideal for a family looking for extra space.

The property features a spacious living room open plan to the dining room which leads to a conservatory overlooking the rear garden. The kitchen has been refitted and is well equipped with integrated appliances. A cloakroom completes the downstairs accommodation. To the first floor there are three generous double bedrooms and a modern family bathroom with bath and separate shower.

There is a private driveway which leads to the property and a front garden which could be altered to make further parking. The good sized rear garden is enclosed and laid mainly to lawn.





Winkworth

**Address: 47A Viney Avenue,
Romsey, Hampshire, SO51 7NR**

Council Tax Band: "D"



Viney Avenue
Approximate Gross Internal Area
Total = 1165 Sq Ft / 108.27 Sq M

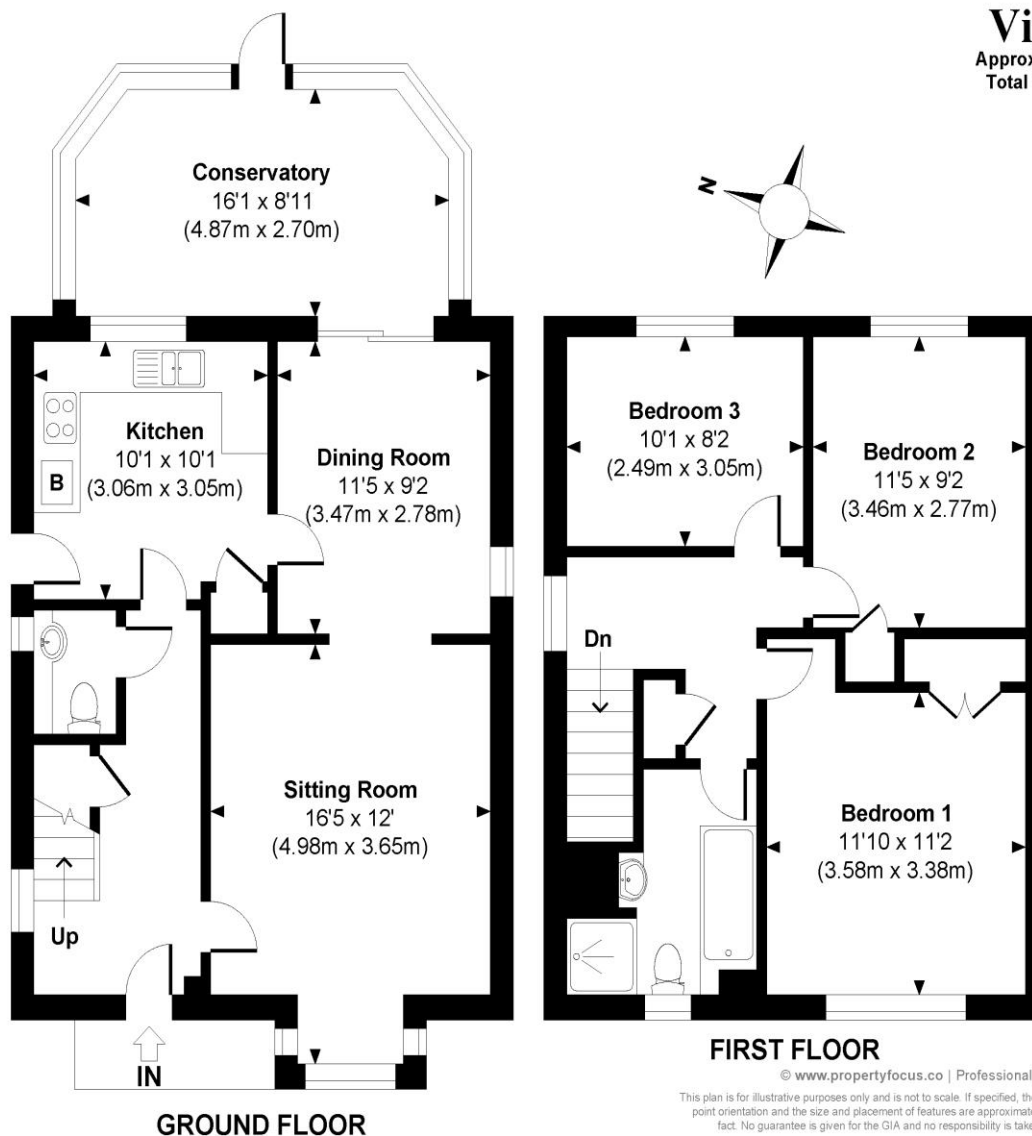

winkworth.co.uk/romsey

Winkworth Romsey
18 Market Place, Romsey, Hampshire, SO51 8NA
01794 511911 | romsey@winkworth.co.uk

Winkworth Winchester
2 Black Swan Buildings, Southgate Street,
Winchester, Hampshire, SO23 9DT
01962 866777 | winchester@winkworth.co.uk

Winkworth Mayfair & Country House Department
11 Berkeley Street, Mayfair, London, W1J 8DS
020 7871 0589 | countryhouse@winkworth.co.uk

winkworth.co.uk/romsey

Winkworth

See things differently