



**RADBOURNE COURT, DRAYCOTT AVENUE, HARROW, HA3**  
**£140,000 LEASEHOLD**

## ONE BEDROOM FIRST FLOOR RETIREMENT FLAT

- COUNCIL TAX BAND C – BRENT
- GROUND RENT TBC
- SERVICE CHARGE TBC
- FIRST COME FIRST SERVE RESIDENTS PARKING

Kingsbury | 020 8204 0000 | [kingsbury@winkworth.co.uk](mailto:kingsbury@winkworth.co.uk)

**Winkworth**

[winkworth.co.uk](http://winkworth.co.uk)

See things differently





This homely first floor retirement flat is served by a lift and offers a comfortable and secure home within a welcoming community. Designed for ease of living, the property features a well-proportioned bedroom, and a living room adjoining with a convenient kitchen, as well as a well sized bathroom. Residents benefit from a strong community spirit, with shared facilities and opportunities to socialize. For added peace of mind, an on-site warden is available for assistance and can be contacted from multiple points within the property. Additionally, a 24-hour emergency Harrow Care Line system ensures support is available at all times. Age Requirement: Residents must be over 60 years old (or, for couples, one must be over 60 and the other over 55). Ideally positioned near excellent shopping amenities, including Sainsbury's supermarket just across the road. -Kenton and Northwick Park stations are within walking distance, offering easy access to public transport. Northwick Park Hospital is also nearby. Convenient on-site parking available for residents. This delightful home presents an excellent opportunity for a peaceful and secure retirement in a sought-after area. Early viewing is highly recommended.



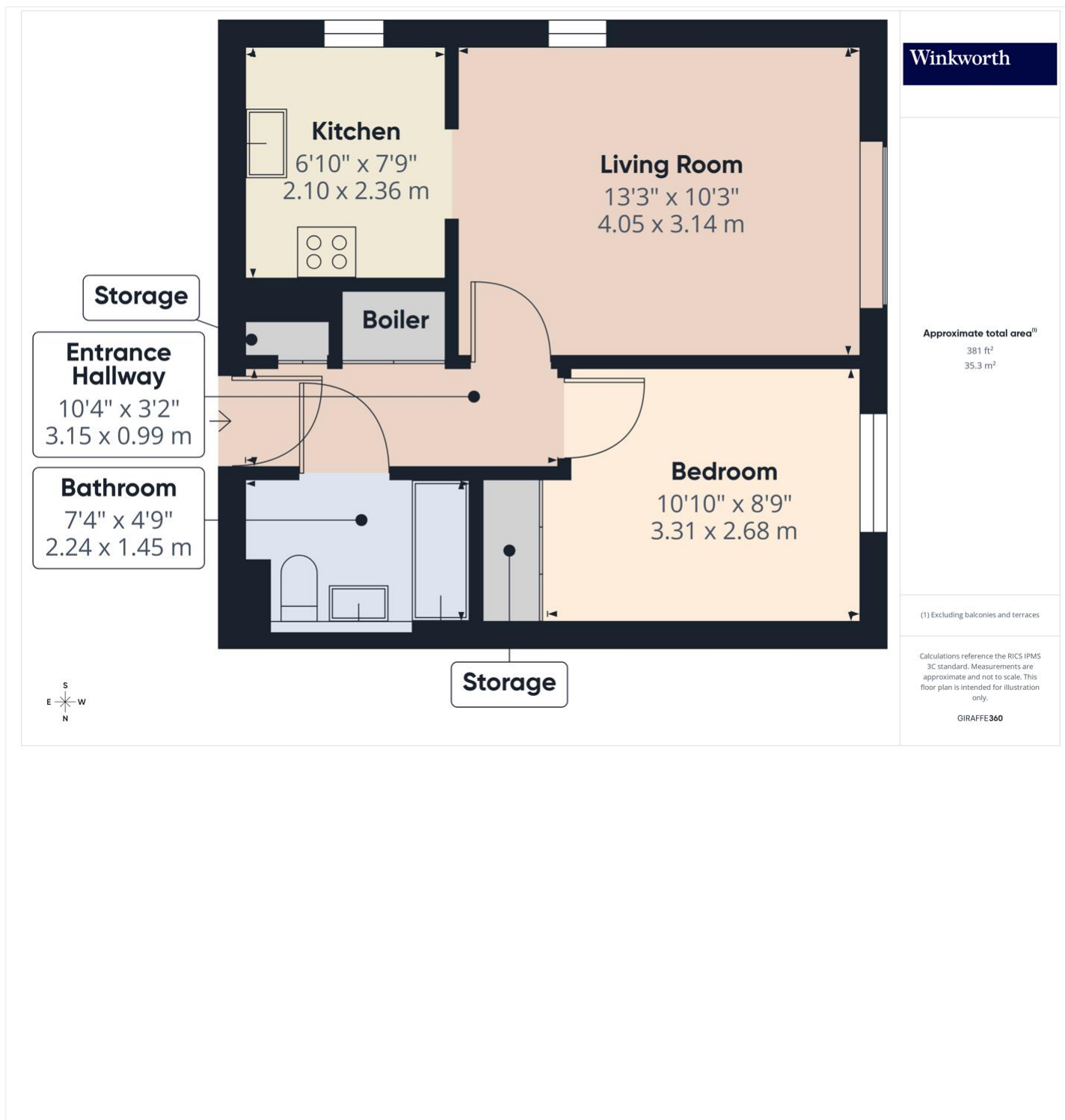

This floorplan is for illustration purposes only and is not to scale. The position and size of doors, windows, appliances and other features are approximate.



Kingsbury | 020 8204 0000 | [kingsbury@winkworth.co.uk](mailto:kingsbury@winkworth.co.uk)

**Winkworth**

[winkworth.co.uk](http://winkworth.co.uk)

See things differently

Winkworth wishes to inform prospective buyers and tenants that these particulars are a guide and act as information only. All our details are given in good faith and believed to be correct at the time of printing but they don't form part of an offer or contract. No Winkworth employee has authority to make or give any representation or warranty in relation to this property. All fixtures and fittings, whether fitted or not are deemed removable by the vendor unless stated otherwise and room sizes are measured between internal wall surfaces, including furnishings.