



STREETFIELD MEWS, BLACKHEATH, LONDON, SE3 0ER
GUIDE PRICE £700,000-£725,000 FREEHOLD

LOCATED IN THIS DELIGHTFUL MEWS ON THE PRESTIGIOUS CATOR ESTATE AND SOLD CHAIN FREE, IS THIS SUPERB TWO DOUBLE BEDROOM HOUSE WITH A LARGE 55FT GARDEN AND A GARAGE WITHIN THE LAST OF THE POPULAR SPAN DEVELOPMENTS WITHIN BLACKHEATH.

Blackheath | 0208 8520999 | blackheath@winkworth.co.uk

Winkworth

winkworth.co.uk

See things differently



DESCRIPTION:

The accommodation comprises an entrance porch which leads to a large 20'8 living room, a separate and good size kitchen and a conservatory. Upstairs are two good sized double bedrooms and a modern bathroom. To the rear of the property is a larger than usual southeast facing garden extending to approx. 55ft with side access. We feel the house would be ideal for a loft conversion to create a 3rd bedroom, (subject to planning,) all parties should make their own enquiries into this. The property further benefits from a garage en bloc and communal access to a fantastic private meadow and use of the allotment exclusive for the residents of Streetfield Mews.

This is a wonderful home and will be very popular. There is no chain. Your earliest viewing is essential. Video tour can be seen on all the usual websites.

Streetfield Mews is a highly desirable location just off Blackheath Park, the flagship road of the prestigious private Cator Estate. The property is located just 0.5 miles from Blackheath Village with its array of bars, restaurants, boutique shops and mainline station. Trains from Blackheath to London Bridge take approximately 10 minutes, and approximately 25 minutes to Victoria. Greenwich Park and the Heath are both just a short walk. The Ofsted outstanding Brooklands and John Ball Primary Schools are within a few minutes' walk and several sought-after private schools including Blackheath Prep, Blackheath High School and the Pointer School are all close by.

AT A GLANCE

- Span house
- delightful mews
- two double bedrooms
- large living room
- conservatory
- 55ft southeast facing garden
- garage
- chain free
- Cator Estate





Ground Floor
Approx. 47.1 sq. metres (506.5 sq. feet)

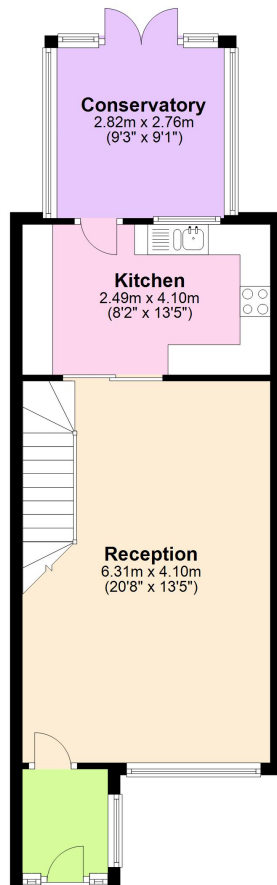

First Floor
Approx. 37.0 sq. metres (398.2 sq. feet)

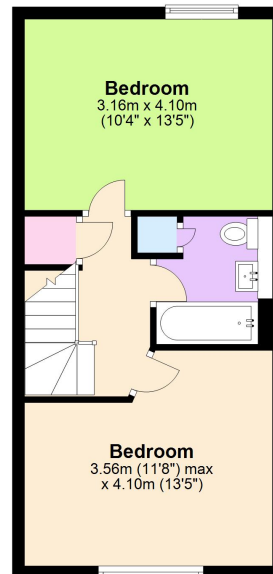

Total area: approx. 84.0 sq. metres (904.6 sq. feet)

This floorplan is for illustration purposes only and is not to scale. The position and size of doors, windows, appliances and other features are approximate. Any lease and service charge details have been provided by the vendor. Any interest party should have these checked by a solicitor as part of the purchase process.

Blackheath | 0208 8520999 | blackheath@winkworth.co.uk

Winkworth

winkworth.co.uk

See things differently

Winkworth wishes to inform prospective buyers and tenants that these particulars are a guide and act as information only. All our details are given in good faith and believed to be correct at the time of printing but they don't form part of an offer or contract. No Winkworth employee has authority to make or give any representation or warranty in relation to this property. All fixtures and fittings, whether fitted or not are deemed removable by the vendor unless stated otherwise and room sizes are measured between internal wall surfaces, including furnishings.