



GLENHAVEN AVENUE, HERTFORDSHIRE, WD6  
**£475,000 FREEHOLD**

## A TWO BEDROOM TWO BATHROOM CHARACTER STYLE HOUSE CLOSE TO SHOPS AND TRANSPORT

Borehamwood | 020 8953 8899 | borehamwood@winkworth.co.uk



### DESCRIPTION:

Having undergone an extensive schedule of reconfiguration and modernisation, both externally and internally, this two double bedroom, two bathroom character house is presented for sale in good order throughout.

Positioned within walking distance of Borehamwood High Street the property is within easy access of a plethora of shops and restaurants as well as Borehamwood and Elstree Thameslink Station with its swift service into central London.

### AT A GLANCE

- 2 Double Bedrooms
- Two Receptions
- Two Bathrooms
- 899 Square Feet
- Chain Free
- Westerly Rear Garden
- Convenient Location







## Ground Floor

Approx. 42.3 sq. metres (455.7 sq. feet)



## First Floor

Approx. 41.2 sq. metres (443.7 sq. feet)

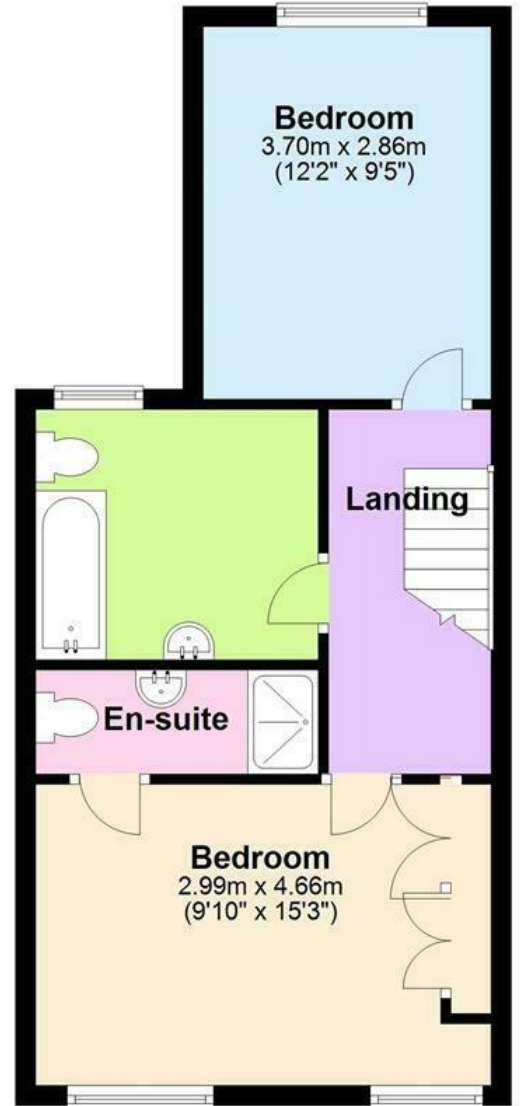

**Total area: approx. 83.6 sq. metres (899.4 sq. feet)**

The measurements given are approximate and are for illustration only. They should not be relied on for valuation. Plan produced using PlanUp.

This floorplan is for illustration purposes only and is not to scale. The position and size of doors, windows, appliances and other features are approximate.

