



MYDDELTON PASSAGE, CLERKENWELL, EC1R
OIEO £800,000 LEASEHOLD

Winkworth



MYDDELTON PASSAGE, EC1R

Situated behind Myddelton Square you will find this well presented and spacious three bedroom apartment which has been finished to a very high standard

Situated on the ground floor of a much sought after purpose built residential building.

Amwell Village and Exmouth Market with its boutique shops, restaurants and cafes are on your doorstep.

The location offers easy access to the City and the West End with local transport links including Farringdon station and Angel underground and numerous bus links.

Leasehold: Approx. 177 years remaining

Service Charge: Approx. £1,454-£1,500 per annum

Ground Rent: Approx. £10 per annum

Council Tax: Band E





Worthington House, Myddelton Passage, Clerkenwell, London, EC1

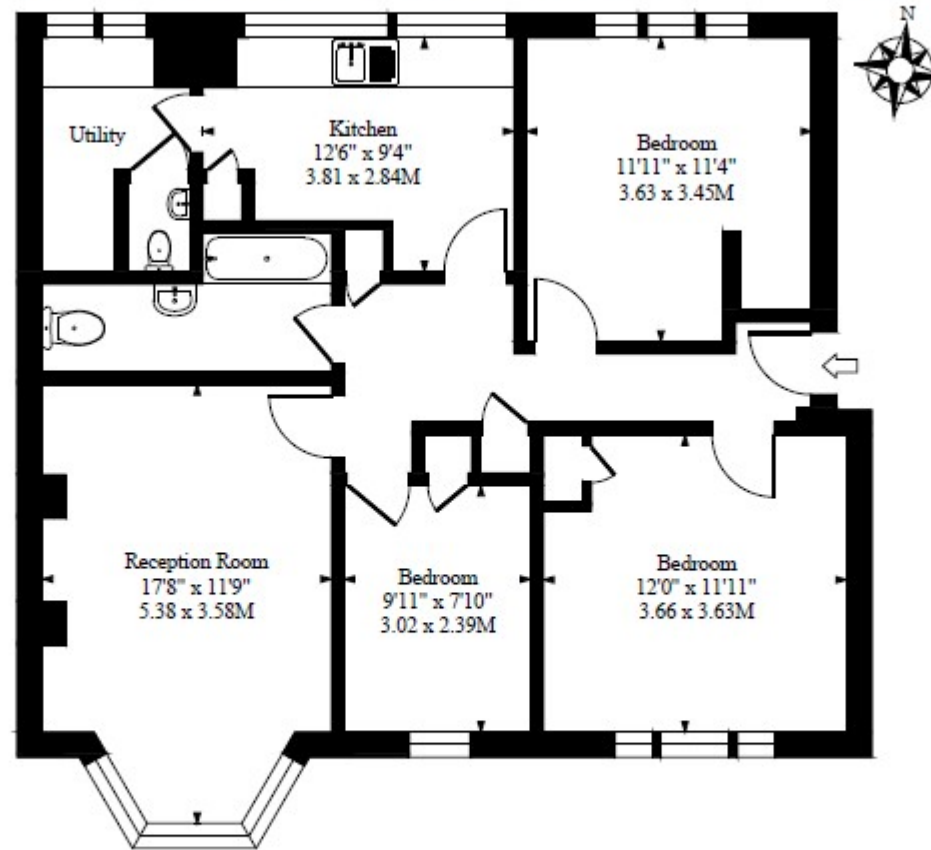

Ground Floor

Approximate Gross Internal Area 879 Sq Ft - 81.66 Sq M

Measured in accordance with RICS guidelines. Every attempt is made to ensure accuracy
However all measurements are approximate.
The floor plan is illustrative purposes only and is not to scale

Clerkenwell & City | 020 7405 1288 | clerkenwell@winkworth.co.uk

winkworth.co.uk

Winkworth wishes to inform prospective buyers and tenants that these particulars are a guide and act as information only. All our details are given in good faith and believed to be correct at the time of printing but they don't form part of an offer or contract. No Winkworth employee has authority to make or give any representation or warranty in relation to this property. All fixtures and fittings, whether fitted or not are deemed removable by the vendor unless stated otherwise and room sizes are measured between internal wall surfaces, including furnishings.

Winkworth