



53 Hunters Crescent, Romsey, Hampshire, SO51 7UG

Winkworth



BEAUIFUL THREE BEDROOM DETACHED HOUSE

Positioned conveniently on the outskirts of Romsey it is approximately one mile from the centre of town and Romsey train station. With convenient bus services in and out of town Romsey offers boutique style shops, day to day shopping facilities, supermarkets, a choice of public houses and restaurants as well as local businesses and banks. Other amenities include the popular Romsey Rapids Leisure Centre, canal walks and it is within catchment for the ever-popular Mountbatten Secondary School.

53 Hunters Crescent has been extremely well updated and modernized throughout over the last few years. This detached family home offers spacious accommodation which comprises a stunning open plan kitchen/dining room to the rear elevation which leads through to the generous conservatory. There is a separate living room and a cloakroom to complete the ground floor accommodation. To the first floor there are three bedrooms and a recently fitted, stylish family bathroom with shower over bath.

Outside to the front the property benefits from good sized garden that is mainly laid to lawn. The south facing private rear garden is enclosed and benefits from having been beautifully landscaped and has side access to the detached single garage and parking.



Winkworth

**Address: 53 Hunters Crescent,
Romsey, Hampshire, SO51 7UG**

Council Tax Band: "D"

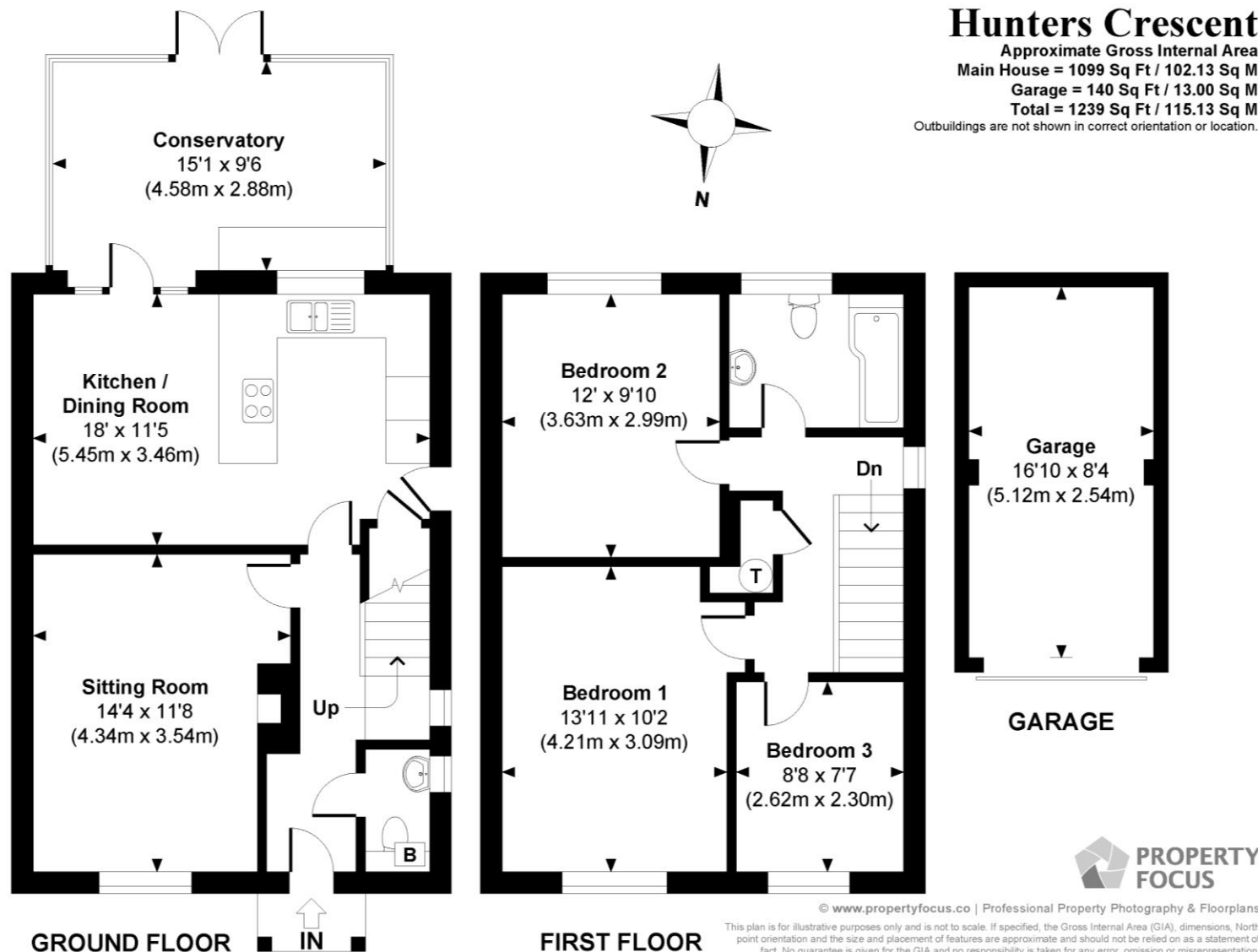
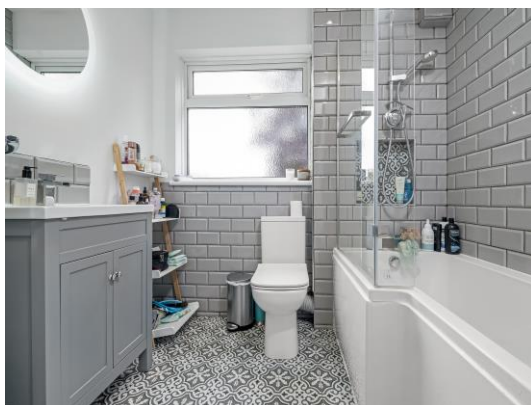

winkworth.co.uk/romsey

Winkworth Romsey

18 Market Place, Romsey, Hampshire, SO51 8NA
01794 511911 | romsey@winkworth.co.uk

winkworth.co.uk/romsey

Winkworth Winchester

2 Black Swan Buildings, Southgate Street,
Winchester, Hampshire, SO23 9DT
01962 866777 | winchester@winkworth.co.uk

Winkworth Mayfair & Country House Department

11 Berkeley Street, Mayfair, London, W1J 8DS
020 7871 0589 | countryhouse@winkworth.co.uk

Winkworth

See things differently